



Banana Peel



Owner's Manual

What's in the Box?



Front Frame Assembly



Rear Frame Assembly



Backrest



Flags



Seat



Rear Wheels



Parts Bag

Assembly Instructions

Tools Required: 3/8" wrench, 1/2" wrench, 9/16" wrench, flat blade screwdriver, Phillips head screwdriver, Air Pump, Air Gauge, Allen wrenches, 15/16" socket wrench, Adjustable wrench, pliers, rubber mallet.

1. **Preparation:** Remove all parts from the box, and carefully unwrap all parts.
2. **Pedals:** Install pedals by threading the pedal marked "R" into the right side of the crank (clockwise) and the pedal marked "L" into the left side of the crank (counterclockwise).
3. **Backrest:** Insert backrest onto front frame assembly with pivot mounting tub pointed downwards and to the rear. The backrest should slide evenly onto the frame about 1.5" to 2" on both sides. Note: This may be a tight fit and it may be necessary to lubricate the frame and tap the backrest on with a rubber mallet. Insert bolts into the backrest clamps from the outside and loosely install washers and nuts. Note: On some backrest clamps, it may be necessary to squeeze with pliers before inserting screws.



Backrest installed into front frame

4. **Rear Frame:** Insert the screws in the holes on rear axle tabs. Loosely tighten with the nuts. Assemble front frame with the back rest on top of rear frame section (shown below). Insert screws into nylon bushings that are preassembled into frame sections. Secure with nylon jam nuts. Tighten nuts so that the frame sections are securely held together, but not so tight to cause binding when pivoted. Tighten backrest clamps. Tighten axle tab screws.

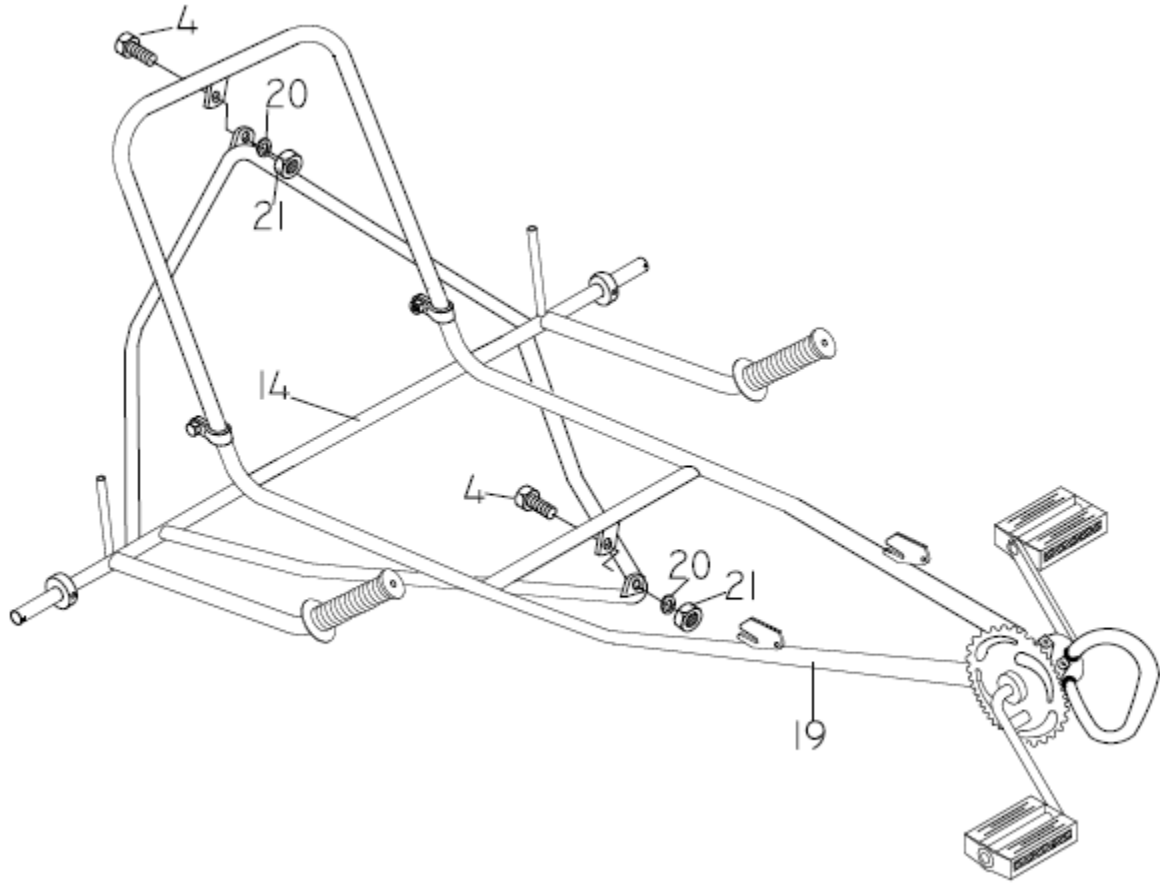

Rear Frame assembly points

5. **Rear Wheels:** Loosen set collar on axle. Slide one washer onto each rear axle against set collar. Slide wheel onto axle along with washer and another set collar. Secure cotter pin into end of axle. Slide outside set collar against cotter pin and tighten. Move remaining components against outside set collar and tighten inside set collar.



Inner set collar and washer



Outer washer, set collar and cotter pin

6. **Seat:** Place seat on back rest with the wide flap at top. Install flaps around outside frame and buckle from top to bottom and side to side. Sit in seat and readjust tension until comfortable.



Seat buckle installation

7. **Final Check:** Install the handle grips to the handlebars and put the safety flags into the holders. A bit of water inside the handle grips may make it easier to install them. Check all connecting bolts and screws for tightness. Pump tires to the proper pressure.

REGULAR MAINTENANCE: Bi-Monthly

1. Keep all painted parts cleaned and waxed for a long-lasting luster.
 2. Spray all chrome parts with recommended protective spray coating (LPS-1, WD-40, etc.).
When spraying with protective coatings, it is recommended that you let parts set overnight so the coating will penetrate.
 3. Lubricate the following:
 - a. Pivot points at top and bottom of seat
 - b. Axle shafts
 - c. Inside bearings of both pedals
 - d. Chain – turn pedal crank forward and spray freely
 4. When storing over prolonged periods, turn upside down to prevent flat spots from occurring on the tires. If stored outside, cover to protect finish and moving parts.
-

PREVENTATIVE MAINTENANCE: Every Six Months

These are services that should be performed by your local bicycle shop. A fee may be charged.

1. Check tires for wear, rim cuts, and valve core alignment (usually caused by improper air pressure).
2. Check wheels for cracks and alignment.
3. Check brakes for proper operation.
4. Clean and repack all bearings and adjust all cones.
5. Check for worn bearings, cones, and cups.
6. Check chain for adjustment and clean as needed.
7. Check for loose bolts and nuts.

Attention: While your unit is new, some noises may occur when the unit is breaking in. Should they continue for more than 30 days, see your local bike shop.

INSPECTION

Check the following, as it applies to your cycle, on a regular basis:

1. Coaster brake – Make sure the brake engages, by pedaling backwards.
2. Wheels – Check wheels for alignment.
3. Pedals – Inspect pedal bearings and make sure pedal is tightly attached to crank.
4. Handle grips – Replace worn or loose grips.
5. Chain – Check for proper tightness. Replace damaged chain immediately.
6. Seat – Adjust seat for rider comfort and safety.
7. Tires – Keep tires inflated to the recommended tire pressure, as indicated on the tire's sidewall.
8. Chainguard – Replace damaged or missing chainguard immediately.
9. Frame – Replace damaged frame immediately.

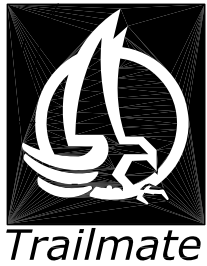

BANANA PEEL ILLUSTRATED PARTS BREAKDOWN

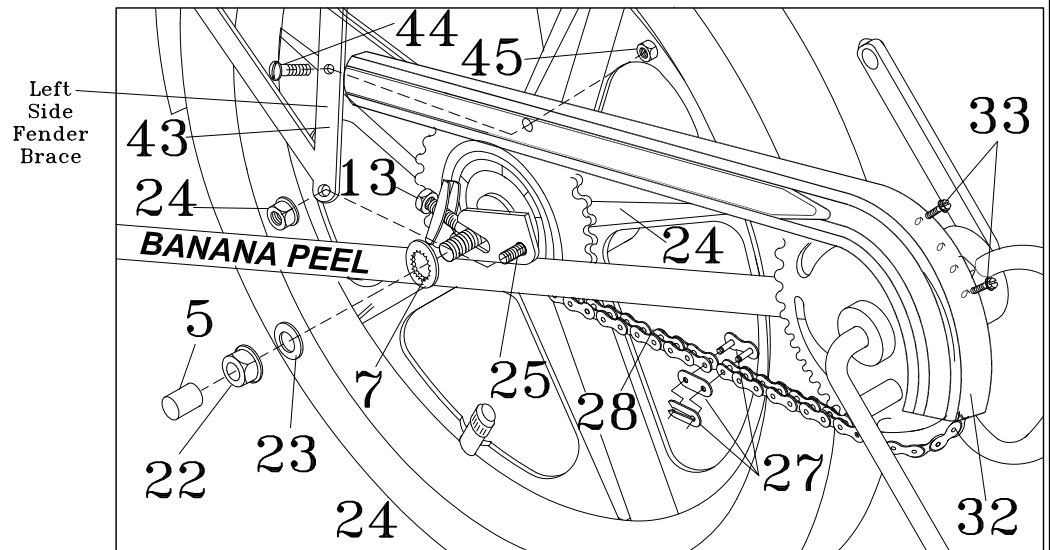
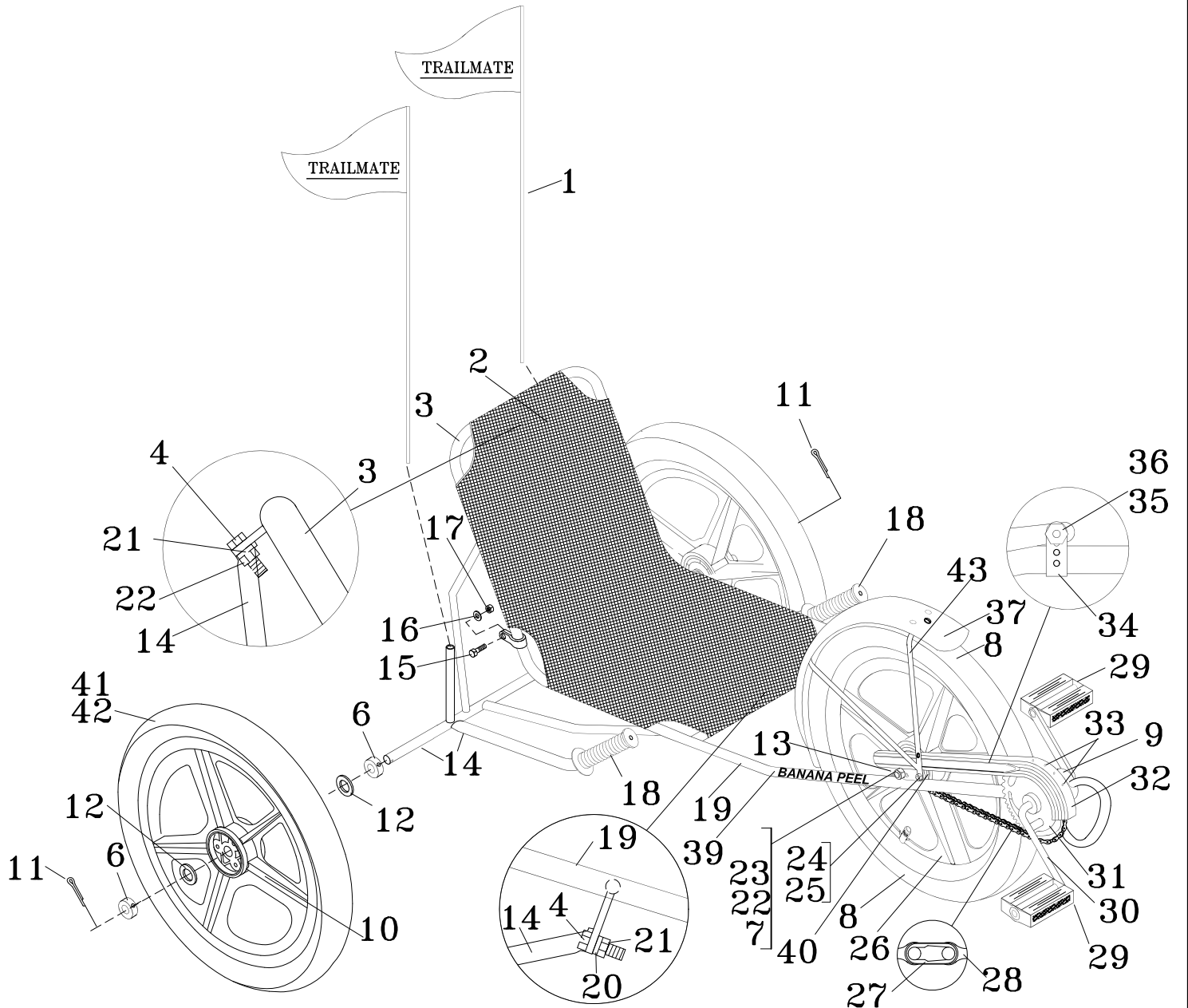

FIG. 4



11.15.07
18840

BANANA PEEL CYCLE PARTS

ITEM PART#	DESCRIPTION	QTY.	ITEM PART#	DESCRIPTION	QTY.
1. 12102	SAFETY FLAG w/o BRACKET	2	25. 12197	SCREW #1/4-20 x1/2 RHMS (frame welded)	2
2. 19279	SEAT BANANA PEEL	1	26. 18785	WHEEL 16" MAG B/P w/CB	1
3. 18831	FRAME B/P BACKREST ASSY.	1	27. 11679	CONNECTING LINK	1
4. 12210	SCREW 5/16-18X1 HHCS	2	28. 12934	CHAIN B/P 65 PITCH	1
5. 19331	AXLE PROTECTOR	2	29. 11857	PEDAL 1/2" (PAIR)	1
6. 12241	SET COLLAR 5/8"	4	30. 11694	CRANK 4 1/2"	1
7. 12428	WASHER 3/8 INT. TOOTH DRV.	2	31. 11934	SPROCKET 36T	1
8. 11959	TIRE 16" x 1.75 BSW	1	32. 18832	CHAINGUARD B/P	1
9. 11718	DECAL TM HEAD	1	33. 12188	SCREW #10-32 x3/8 SLTD HWH	2
10. 18787	WHEEL 16" MAG 5/8 BORE	2	34. 12279	CLAMP (BRAKE STRAP)	1
11. 11070	PIN COTTER 3/32 x 1	2	35. 19169	SCREW BRAKE STRAP SHIMANO	1
12. 19640	WASHER 5/8 SAE	4	36. 19168	NUT BRAKE STRAP SHIMANO	1
13. 20028	CHAIN ADJUSTER COMPLETE	2	37. 12863	FENDER 16" B/P FRONT	1
14. 18809	FRAME B/P REAR	1	* 38. 19355	RIM STRIP 16"X1.75	2
15. 13225	CLMP BOLT M8 x 38mm LG HH	2	39. 18830	DECAL BANANA PEEL SIDE RAIL	2
16. 13226	CLMP WASHER M8 FLAT	2	40. 19167	SPROCKET 18T	1
17. 13227	CLMP NUT M8 HEX	2	41. 17615	TIRE 16X2.125 BSW KNBY W/TUBE	2
18. 18175	GRIPS HANDLE YELLOW/BLACK	2	* 42. 19346	WHL 16"2.125 SPOKED ZINC	2
19. 18808	FRAME B/P FRONT	1	43. 20284	FENDER BRACE BP	1
20. 12236	WASHER 5/16 SAE	2	44. 20307	SCREW RHMS 8/32 X 3/8" FC/BP	2
21. 11065	NUT #5/16-18 NYLON INSERT	2	45. 20308	NUT HEX 8/32 FC/BP	2
22. 19153	NUT AXLE CB	2	46. 12170	NUT 10-32/STAR	2
23. 12301	WASHER 3/8 FLAT SAE	2	47. 19171	SCREW 10-32X3/8 RHMS	2
24. 12172	NUT #1/4-20 FLANGED	4			

* - FOR SPOKED ZINC WHL ONLY

09/11/06 #18840/#18811

ILLUSTRATED PARTS LIST (BANANA PEEL)

ITEM PART #12170 (2)
#46 NUT #10-32 HEX



ITEM PART #19171 (2)
#47 SCREW #10-32 X 3/8"



ITEM PART #19169 (1)
#35 SCREW #10-32 X 1/2"
SCREW FOR BRAKE STRAP

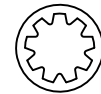

ITEM PART #12428 (2)
#7 WASHER INTERNAL
TOOTH

ITEM PART #19168 (1)
#36 NUT BRAKE STRAP



ITEM PART #11065 (2)
#21 NUT #5/16-18
NYLON INSERT



ITEM PART #13226 (2)
#16 WASHER
THICKER ONE

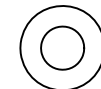

ITEM PART #12197 (2)
#25 SCREW #1/4-20 X 1/2"
(frame welded)



ITEM PART #12236 (2)
#20 WASHER

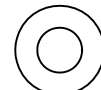

ITEM PART #12172 (2)
#24 NUT #1/4-20



ITEM PART #13227(2)
#17 CLAMP NUT



ITEM PART #12210 (4)
#4 SCREW #5/16-18 X 1"



ITEM PART #12301 (2)
#23 WASHER

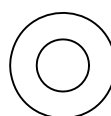

ITEM PART #19153 (2)
#22 NUT AXLE

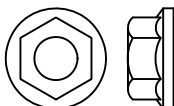

ITEM PART #20308 (1)
#45 NUT HEX 8/32 FC/BP



ITEM PART #13225 (2)
#15 CLAMP BOLT

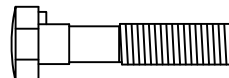

ITEM PART #19640 (4)
#12 WASHER 5/8 SAE

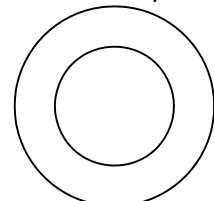

ITEM PART #20307 (1)
#44 SCREW # RHMS 8/32 X 3/8" FC/BP



ITEM PART #12279 (1)
#34 CLAMP (BRAKE STRAP)

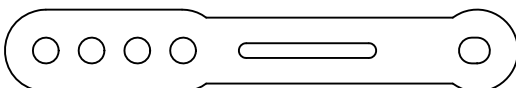

ITEM PART #11070 (2)
#11 COTTER PIN

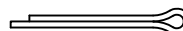



Trailmate

1851 67th AVE East

Sarasota, FL 34243

Tel: (941) 755-5511

Fax: (941) 758-5141

Visit us @ www.trailmate.com

**For service or to order
replacement parts
please contact your
local Trailmate dealer.**

BANANA PEEL

This is a recreational unit, not designed for excessive speeds or misuse.

Do not brake or turn at high speeds. This may cause cycle to roll over. Careless operation may cause rider to lose control and result in **serious injury**.

Things to know before riding your cycle:

1. Know your local bicycle laws and wear a helmet.
2. Do not exceed the recommended weight limit of 150 lbs.
3. No more than one rider at one time.
4. Do not stand on unit.
5. Be sure to install safety flags.
6. Wear light-colored clothing and protective gear.
7. Do not ride at night.
8. Children must be supervised by an adult at all times.

Trailmate Limited Warranty

Trailmate, Inc., guarantees each cycle product against all defects in materials and workmanship for a period of 90 days from date of purchase. Tires and tubes are not covered by this guarantee.

During this period, any part that is judged by the makers to be defective will be replaced free of charge. Any failure resulting from accident, abuse, neglect, normal wear, or improper assembly or maintenance by the owner is not covered.

Trailmate, Inc., further authorizes a lifetime frame guarantee and will replace any frame, at no cost to the buyer, providing that item has not been used for rental use and that:

- 1) The item has not been altered, repaired, or modified in any way.
- 2) The item has not been subject to misuse, negligence, and/or an accident.
- 3) Original ownership is established.

Any parts under this guarantee on which claims are entered shall be returned for inspection with transportation charges prepaid by the claimant. Replacement parts will be shipped F.O.B. factory.

There are no warranties or guarantee, expressed or implied, written or oral, which extend beyond the description on the face hereof.