

# IMPELLER REPLACEMENT INSTRUCTIONS

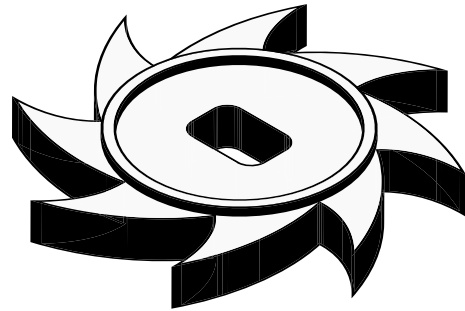

*Turn off and unplug the machine before doing anything.*

*Always follow Original Manufacturer instructions for installation.*

**Pro Tip:** *Search for instructions online for detailed guides.*

- 1 Remove hopper, upper burrs and lower burrs.
- 2 Turn over the grinder and remove the base.
- 3 Remove the 4 screws that hold the top in place. Flip the grinder over and slowly lift away the top.
- 4 Unscrew the two screws to release the front display. Lift the display up and out of the frame.
- 5 Remove the gear assembly. Make alignment marks on the three parts of the gear assembly before removing them.
- 6 Remove the old impeller. Make sure the two steel washers underneath the impeller do not fall out.
- 7 Use compressed air or toothpick to clean out the exit chute.
- 8 Install your new impeller.
- 9 Check the fit and burr elevation. Make sure all parts are accounted for.
- 10 Reassemble your machine.