

CARVER CLAMPS

HOLDING POWER

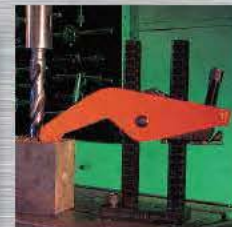

T - SLOT AND BUTTRESS
CLAMPS MACHINE VICES



T-Slot Clamps

Holds work securely on many machines, including

- Horizontal and vertical boring machines
- Planers
- Millers
- Lathes
- Power presses
- Radial drills



- Quicker, more efficient and safer than using packers and bolts - no loose pieces.
- Can be used at any angle.
- Head creates a 'push' action when reversed.
- Alternative positions for fulcrum pin.

1 daN = 1 kgf
1 daN = 2.2 lbf
1 daN = 10 N

Model No.

Standard Duty



2270 daN

T400-100
T400-150
T400-200

Standard Duty Long Reach

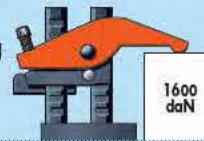

1600 daN

T600-100
T600-150
T600-200

Heavy Duty

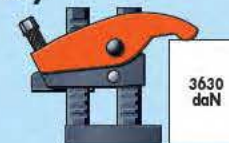

3630 daN

T402-150
T402-300
T402-450
T402-600
T402-750
T402-900
T402-1050
T402-1200
T402-1350
T402-1500

Heavy Duty Long Reach

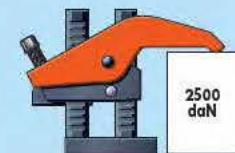

2500 daN

T602-150
T602-300
T602-450
T602-600
T602-750
T602-900
T602-1050
T602-1200
T602-1350
T602-1500

CARVER CLAMPS

Clamping Height				Reach		Weight kg
Min mm	Inch	Max mm	Inch	mm	Inch	
25	(1)	100	(4)	19 or with base reversed 35	$(\frac{3}{4})$ $(1\frac{3}{8})$	2.3
25	(1)	150	(6)			2.5
62	(2½)	200	(8)			2.6
12	(½)	100	(4)	57 or with base reversed 73	$(2\frac{1}{4})$ $(2\frac{7}{8})$	2.7
12	(½)	150	(6)			2.9
50	(2)	200	(8)			3.0
0	0	150	(6)	44 or with base reversed 66	$(1\frac{3}{4})$ $(2\frac{5}{8})$	6.3
0	0	300	(12)			8.0
150	6	450	(18)			8.8
300	12	600	(24)			10.0
450	18	750	(30)			11.7
600	24	900	(36)			13.0
750	30	1050	(42)			14.5
900	36	1200	(48)			15.7
1050	42	1350	(54)			16.7
1200	48	1500	(60)			18.5
0	0	150	(6)	95 or with base reversed 117	$(3\frac{3}{4})$ $(4\frac{5}{8})$	7.3
0	0	300	(12)			9.0
150	6	450	(18)			9.8
300	12	600	(24)			11.0
450	18	750	(30)			12.7
600	24	900	(36)			14.0
750	30	1050	(42)			15.5
900	36	1200	(48)			16.7
1050	42	1350	(54)			17.7
1200	48	1500	(60)			19.5

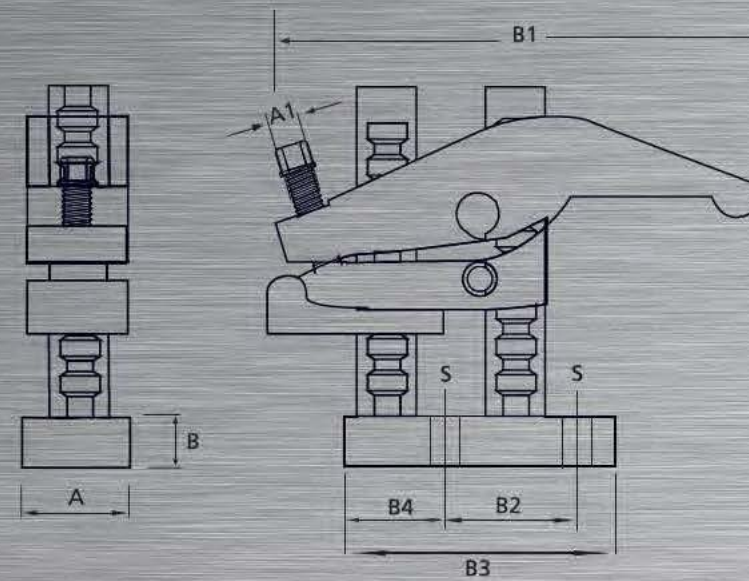

Model No.	Measurements in mm							
	A	A1	B	B1	B2	B3	B4	S
Standard Duty T400 SERIES	51	13 A/F Hex	16	162	54	96.25	31.75	For M12 bolt
Standard Duty Long Reach T600 SERIES	51	13 A/F Hex	16	200	54	96.25	31.75	For M12 bolt
Heavy Duty T402 SERIES	76	19 A/F Hex	19	249	71	140	54	For M16 bolt
Heavy Duty Long Reach T602 SERIES	76	19 A/F Hex	19	308	71	140	54	For M16 bolt

Buttress Clamps

- Holds press tools on all types of power press.
- Clamps work up to 75mm (3") deep to drilling machines and lathe faceplates
- Constant clamping force ratio between workpiece and table, thanks to self-aligning captive pivot.
- H-shaped heads 4-point contact resists tendency for workpiece to rotate.



Standard Duty



Medium Duty



Heavy Duty



1 daN = 1 kgf
1 daN = 2.2 lbf
1 daN = 10 N

CARVER CLAMPS

Model No.	Measurements in mm							
	A	A1	B	B1	B2	B3	C	S
Standard Duty T614-0	110	90	66	36	40	20	26	13
Medium Duty T614-1	160	134	100	53	65	29	46	21

Model No.	Max Safe Working Height		Max Fixing Bolt Diameter		Clamp Weight kg
	mm	Inch	mm	Inch	
T614-0	45	(1 3/4)	M12	(1/2)	0.6
T614-1	57	(2 1/4)	M16 or M20	(5/8) (3/4)	2.7
T614-2	75	(3)	M24	(1)	4.3

Standard / Medium Duty
T614-0 / T614-1

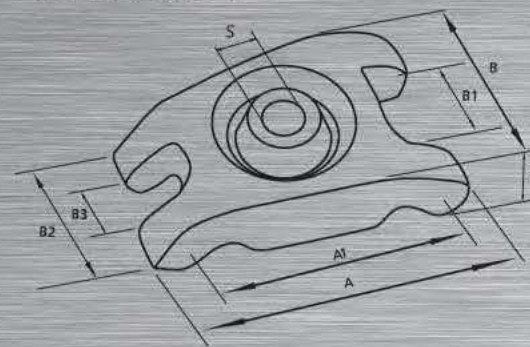

Heavy Duty
T614-2

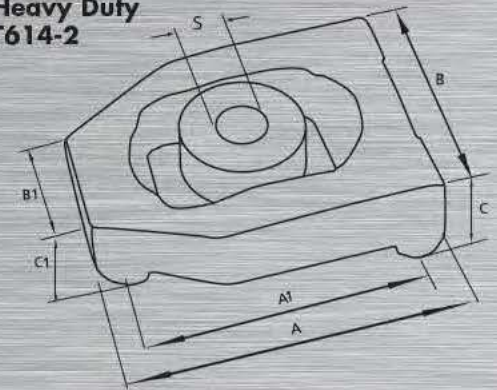

Model No.	Measurements in mm						
	A	A1	B	B1	C	C1	S
Heavy Duty T614-2	170	148	130	65	50	40	26



Machine Vices

Effortlessly handle work where conventional vices cannot

- Milling
- Grinding
- General surface operations
- Operates in two planes:
Horizontal-jaws tighten on work
Vertical-bringing work firmly down onto machine table



1 daN = 1 kgf
1 daN = 2.2 lbf
1 daN = 10 N

Model No.	Horizontal Clamping Force	Downward Force	
Low Profile Horizontal 2250 daN Vertical 900 daN 	T500	2250 daN	900 daN
Heavy Duty Horizontal 4500 daN Vertical 1800 daN 	T550	4500 daN	1800 daN

CARVER CLAMPS

- Heavy duty vices enable the full length of machine bed to be used.
- Rotatable fixing bosses allow 360° movement for accurate alignment.
- Low profile gives maximum cutter access.

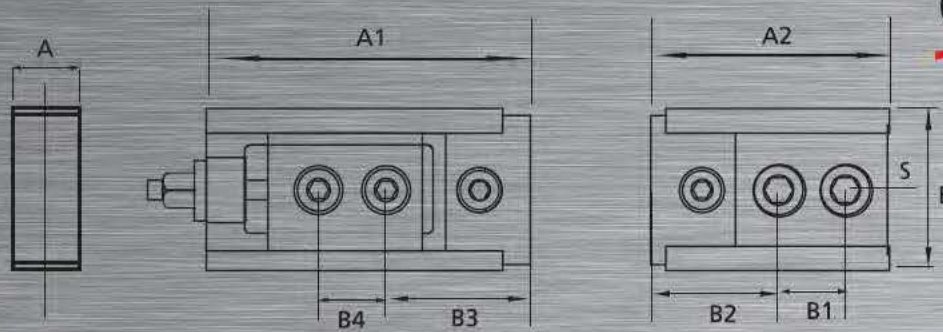

Model No.	A	A1	A2	B	B1	B2	B3		B4	S Hole
							Min	Max		
Low Profile T500	30	150	109	67	35	55	55	65	35	13

Jaw Height		Fixing Bolts		Weight kg
mm	Inch	mm	Inch	
27	(1 1/8)	M12	(1/2)	3.8
70	(2 3/4)	M16 (5/8) or M20 (3/4)		24

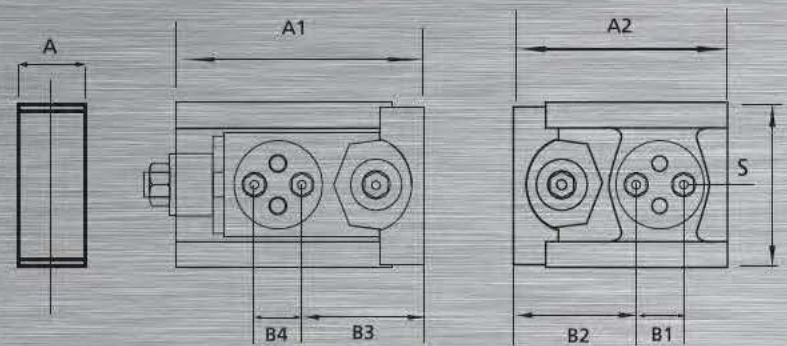

Model No.	A	A1	A2	B	B1	B2	B3		B4	S Hole
							Min	Max		
Heavy Duty T550	77	245	195	151	57	93.5	89.5	114.5	57	16.2

Specifications are subject to review and improvement. Data in this publication is for information only and does not form part of any contract.