

NC BLOCK COMPONENTS INDEX

PAGE	DATE	NAAMS CODE	DESCRIPTION
0-1	02/12/14		NC Block Components Index
0-1.1	02/12/14		NC Block Components Index
0-2	02/12/14	ANI080 – ANI083	NC Blocks Blanks, I-Shaped, 3-Hole x 80
0-3	02/12/14	ANI084 – ANI087	NC Blocks Blanks, I-Shaped, 4-Hole x 80
0-4	02/12/14	ANI120 – ANI123	NC Blocks Blanks, I-Shaped, 3-Hole x 120
0-5	02/12/14	ANI126 – ANI129	NC Blocks Blanks, I-Shaped, 4-Hole x 120
0-6	02/12/14	ANL060 – ANL061	NC Blocks Blanks, L-Shaped, 3-Hole x 60
0-7	02/12/14	ANL062 – ANL063	NC Blocks Blanks, L-Shaped, 3-Hole x 60
0-8	02/12/14	ANL064 – ANL065	NC Blocks Blanks, L-Shaped, 4-Hole x 60
0-9	02/12/14	ANL066 – ANL067	NC Blocks Blanks, L-Shaped, 4-Hole x 60
0-10	02/12/14	ANL100 – ANL101	NC Blocks Blanks, L-Shaped, 3-Hole x 100
0-11	02/12/14	ANL102 – ANL103	NC Blocks Blanks, L-Shaped, 3-Hole x 100
0-12	02/12/14	ANL104 – ANL105	NC Blocks Blanks, L-Shaped, 4-Hole x 100
0-13	02/12/14	ANL106 – ANL107	NC Blocks Blanks, L-Shaped, 4-Hole x 100
0-14	02/12/14	ANR130 – ANR137	NC Blocks Blanks, Rectangular, 3-Hole
0-15	02/12/14	ANR140 – ANR147	NC Blocks Blanks, Rectangular, 4-Hole
0-16	02/12/14	ANR230 – ANR233	NC Blocks Blanks, Rectangular, 3-Hole
0-17	02/12/14	ANR240 – ANR243	NC Blocks Blanks, Rectangular, 4-Hole
0-18	07/25/08	ANI381 – ANI383 ANI391 – ANI392	NC Blocks Blanks, I-Shaped, 3-Hole x 80, 20 mm
0-19	02/12/14	ANI384 – ANI387	NC Blocks Blanks, I-Shaped, 4-Hole x 80, 20 mm
0-20	07/25/08	ANI421 – ANI425	NC Blocks Blanks, I-Shaped, 3-Hole x 120, 20 mm
0-21	02/12/14	ANI426 – ANI429	NC Blocks Blanks, I-Shaped, 4-Hole x 120, 20 mm
0-22	07/25/08	ANL361 – ANL363 ANL368 – ANL369	NC Blocks Blanks, L-Shaped, 3-Hole x 60, 20 mm
0-23	02/12/14	ANL364 – ANL365	NC Blocks Blanks, L-Shaped, 4-Hole x 60, 20 mm
0-24	02/12/14	ANL366 – ANL367	NC Blocks Blanks, L-Shaped, 4-Hole x 60, 20 mm
0-25	07/25/08	ANL401 – ANL403 ANL408 – ANL409	NC Blocks Blanks, L-Shaped, 3-Hole x 100, 20 mm
0-26	02/12/14	ANL404 – ANL405	NC Blocks Blanks, L-Shaped, 4-Hole x 100, 20 mm
0-27	02/12/14	ANL406 – ANL407	NC Blocks Blanks, L-Shaped, 4-Hole x 100, 20 mm
0-28	07/25/08	ANR431 – ANR437 ANR448 – ANR451	NC Blocks Blanks, Rectangular, 3-Hole, 20 mm
0-29	02/12/14	ANR440 – ANR447	NC Blocks Blanks, Rectangular, 4-Hole, 20 mm
0-30	07/25/08	ANR531 – ANR535	NC Blocks Blanks, Rectangular, 3-Hole, 20 mm
0-31	02/12/14	ANR540 – ANR543	NC Blocks Blanks, Rectangular, 4-Hole, 20 mm

NC BLOCK COMPONENTS INDEX

PAGE	DATE	NAAMS CODE	DESCRIPTION
0-32	02/12/14	ANI206 - ANI209	NC BLANKS 20mm SERIES
0-33	02/12/14	ANI201 - ANI204	NC BLANKS 20mm SERIES
0-34	02/12/14	ANI216 - ANI219	NC BLANKS 20mm SERIES
0-35	02/12/14	ANI211 - ANI214	NC BLANKS 20mm SERIES
0-36	02/12/14	ANL215 - ANL218	NC BLANKS 20mm SERIES
0-37	02/12/14	ANL211 - ANL212	NC BLANKS 20mm SERIES
0-38	02/12/14	ANL221 - ANL222	NC BLANKS 20mm SERIES
0-39	02/12/14	ANL225 - ANL228	NC BLANKS 20mm SERIES
0-40	02/12/14	ANL311 - ANL312	NC BLANKS 20mm SERIES
0-41	02/12/14	ANL411 - ANL412	NC BLANKS 20mm SERIES
0-42	02/12/14	ANR600 - ANR607	NC BLANKS 20mm SERIES
0-43	02/12/14	ANR301 - ANR308	NC BLANKS 20mm SERIES
0-44	02/12/14	ANR320 - ANR323	NC BLANKS 20mm SERIES
0-45	02/12/14	ANR311 - ANR314	NC BLANKS 20mm SERIES

NC BLOCK BLANKS ANL060, 061

Tolerances: 1 PLACE ± 0.3
 2 PLACE ± 0.03
 3 PLACE ± 0.020

 SURFACES TO BE FLAT, PARALLEL &
 PERPENDICULAR TO WITHIN 0.015 T.I.R.

NOTE: Identify with NAAMS CODE number as shown **XXX**.
 Black Oxide Finish
 No Black Oxide Finish to "SS Type" Components

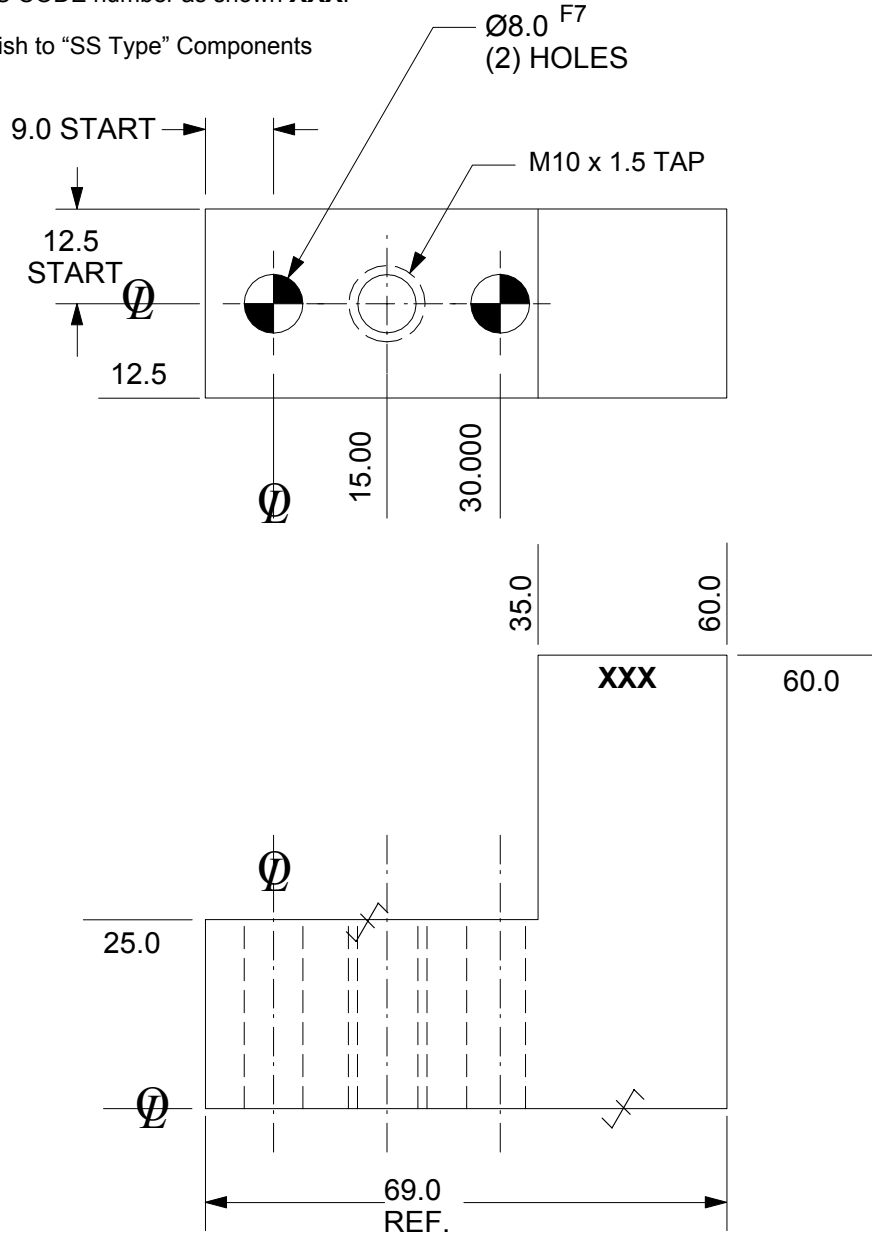

D

SEE PAGE B-1.1 FOR GLOBAL MATERIALS CHART

NAAMS CODE	MATERIAL	WT. kg
ANL060	STEEL SAE 4140	0.50
ANL061	SS type 303 or 304	0.50

C
A
B

NC BLOCK BLANKS ANL064, 065

Tolerances: 1 PLACE ± 0.3
 2 PLACE ± 0.03
 3 PLACE ± 0.020

 SURFACES TO BE FLAT, PARALLEL &
 PERPENDICULAR TO WITHIN 0.015 T.I.R.

NOTE: Identify with NAAMS CODE number as shown **XXX**.
 Black Oxide Finish
 No Black Oxide Finish to "SS Type" Components

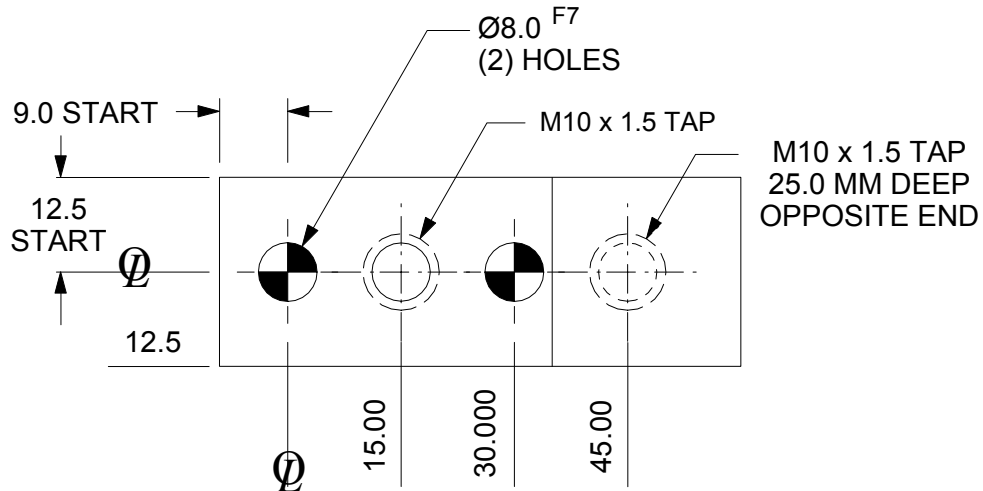

SEE PAGE B-1.1 FOR GLOBAL MATERIALS CHART

NAAMS CODE	MATERIAL	WT. kg
ANL064	STEEL SAE 4140	0.50
ANL065	SS type 303 or 304	0.50

D

C

A

B

NC BLOCK BLANKS ANL066, 067

GLOBAL STANDARD COMPONENTS



Assembly

02/12/14

Tolerances: 1 PLACE ± 0.3
2 PLACE ± 0.03
3 PLACE ± 0.020

SURFACES TO BE FLAT, PARALLEL & PERPENDICULAR TO WITHIN 0.015 T.I.R.

NOTE: Identify with NAAMS CODE number as shown **XXX**.

Black Oxide Finish

No Black Oxide Finish to "SS Type" Components

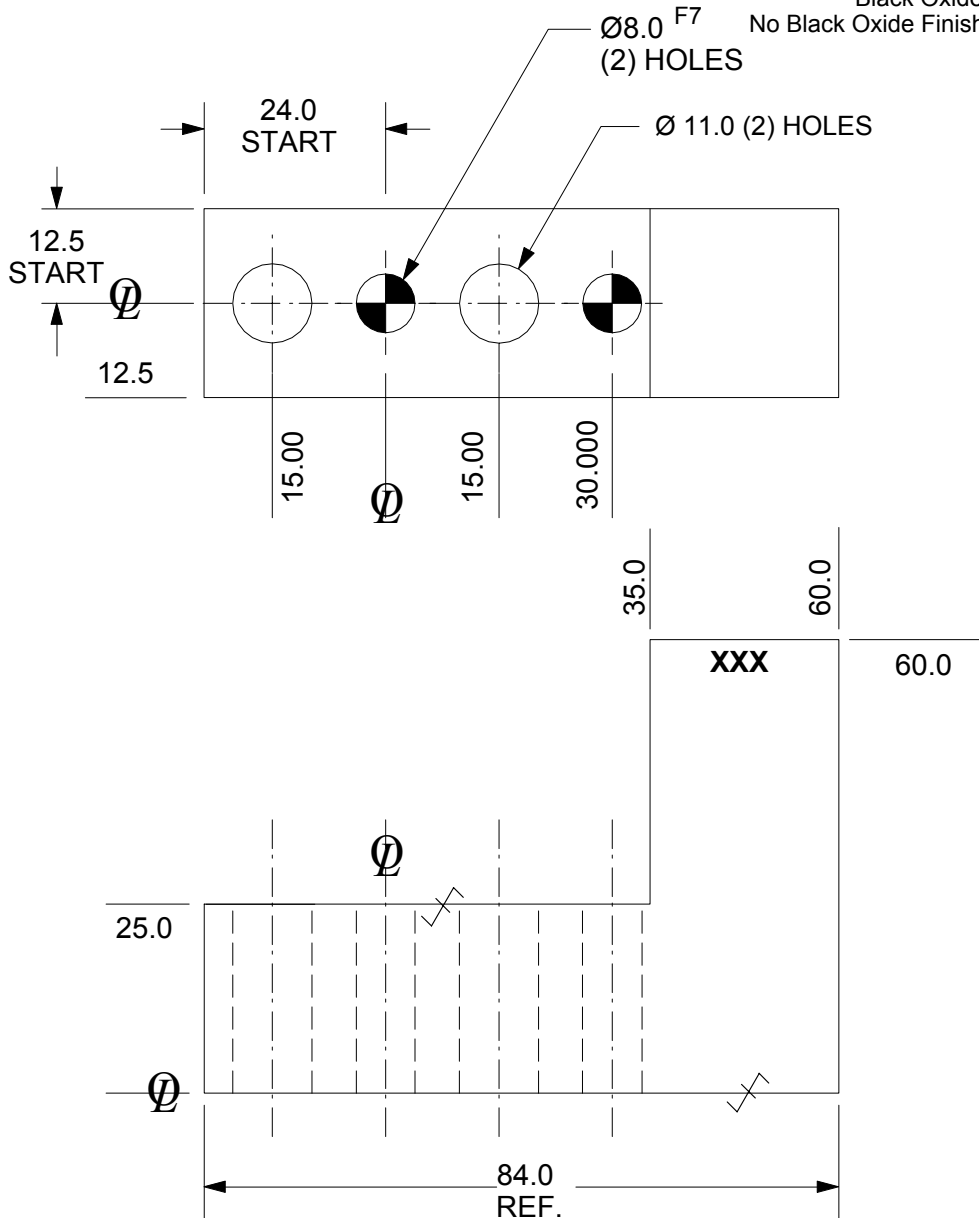

D

SEE PAGE B-1.1 FOR GLOBAL MATERIALS CHART

NAAMS CODE	MATERIAL	WT. kg
ANL066	STEEL SAE 4140	0.59
ANL067	SS type 303 or 304	0.59

C
A
B

NC BLOCK BLANKS ANL100, 101

GLOBAL STANDARD COMPONENTS



Assembly

02/12/14

Tolerances: METRIC

1 PLACE ± 0.3

2 PLACE ± 0.03

3 PLACE ± 0.020

SURFACES TO BE FLAT, PARALLEL & PERPENDICULAR TO WITHIN 0.015mm T.I.R.
NOTE: Identify with NAAMS CODE number as shown **XXX**.

Black Oxide Finish

No Black Oxide Finish to "SS Type" Components

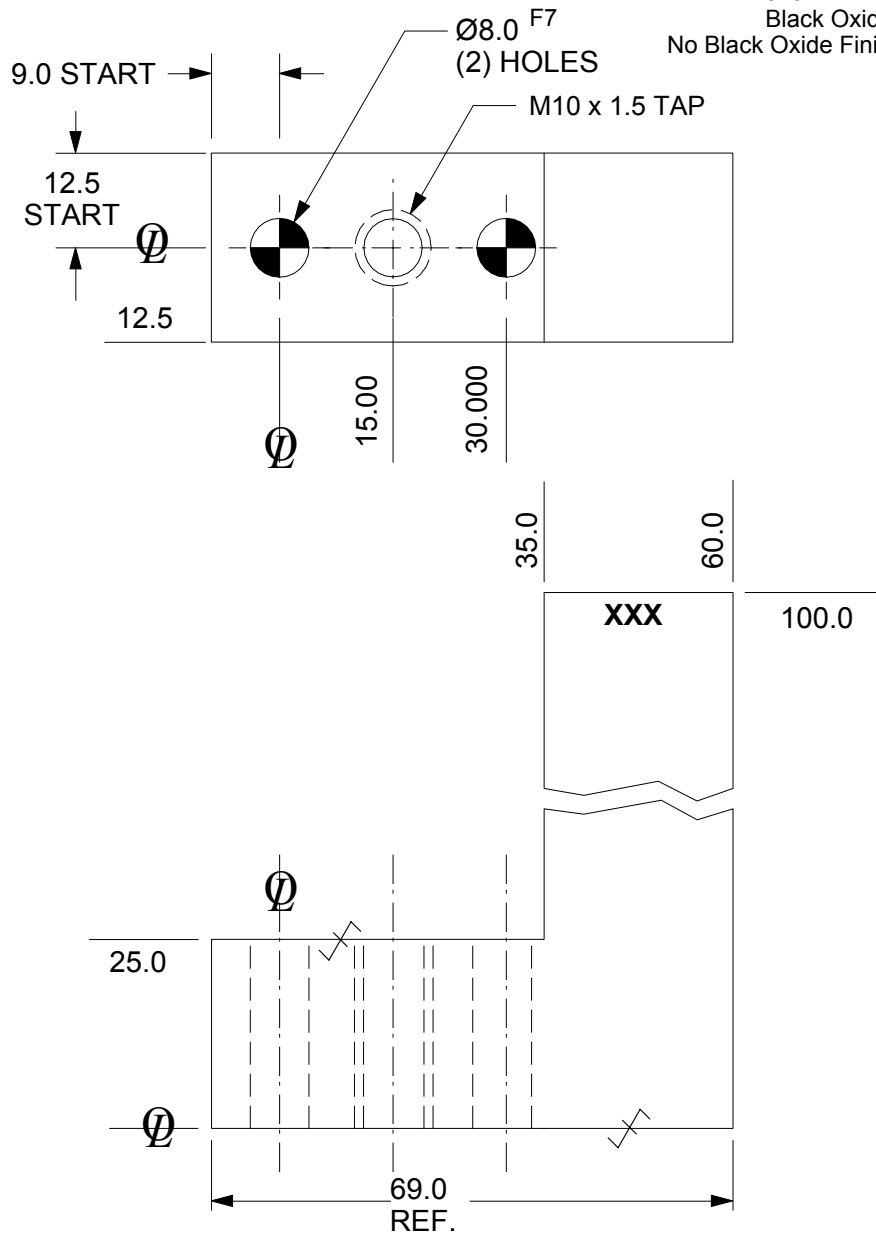

SEE PAGE B-1.1 FOR GLOBAL MATERIALS CHART

NAAMS CODE	MATERIAL	WT. kg
ANL100	STEEL SAE 4140	0.68
ANL101	SS type 303 or 304	0.68

D

C
A
B

NC BLOCK BLANKS

ANL102, 103

Tolerances: 1 PLACE ± 0.3
 2 PLACE ± 0.03
 3 PLACE ± 0.020

✓ SURFACES TO BE FLAT, PARALLEL & PERPENDICULAR TO WITHIN 0.015 T.I.R.

NOTE: Identify with NAAMS CODE number as shown **XXX**.

Black Oxide Finish
 No Black Oxide Finish to "SS Type" Components

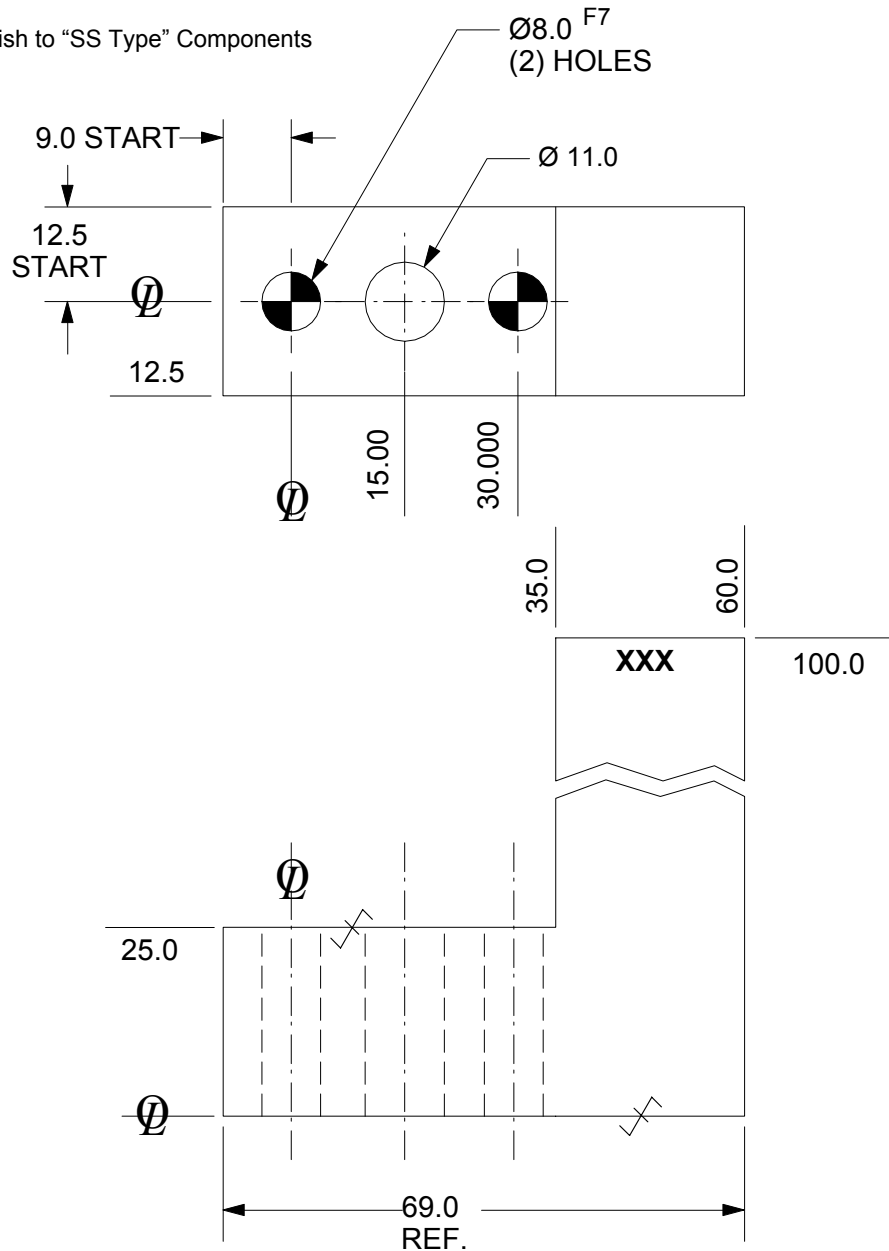

SEE PAGE B-1.1 FOR GLOBAL MATERIALS CHART

NAAMS CODE	MATERIAL	WT. kg
ANL102	STEEL SAE 4140	0.68
ANL103	SS type 303 or 304	0.68

D

C
A
B

NC BLOCK BLANKS ANL104, 105

Tolerances: 1 PLACE ± 0.3
 2 PLACE ± 0.03
 3 PLACE ± 0.020

✓ SURFACES TO BE FLAT, PARALLEL & PERPENDICULAR TO WITHIN 0.015 T.I.R.
 NOTE: Identify with NAAMS CODE number as shown **XXX**.
 Black Oxide Finish
 No Black Oxide Finish to "SS Type" Components

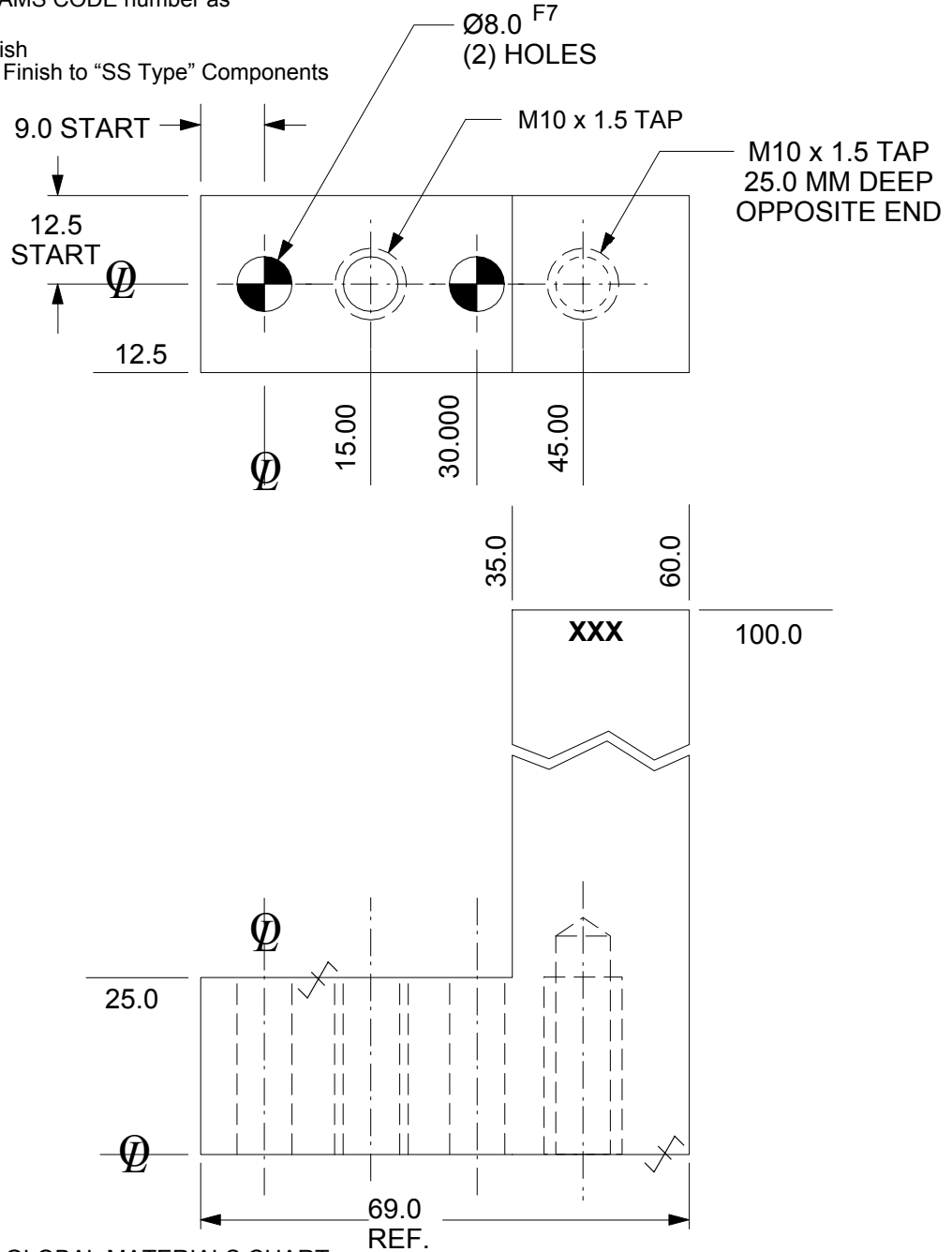

SEE PAGE B-1.1 FOR GLOBAL MATERIALS CHART

NAAMS CODE	MATERIAL	WT. kg
ANL104	STEEL SAE 4140	0.68
ANL105	SS type 303 or 304	0.68

D

C
A
B

NC BLOCK BLANKS ANL106, 107

Tolerances: 1 PLACE ± 0.3
 2 PLACE ± 0.03
 3 PLACE ± 0.020

✓ SURFACES TO BE FLAT, PARALLEL &
 PERPENDICULAR TO WITHIN 0.015 T.I.R.
 NOTE: Identify with NAAMS CODE number
 as shown **XXX**.
 Black Oxide Finish
 No Black Oxide Finish to "SS Type" Components

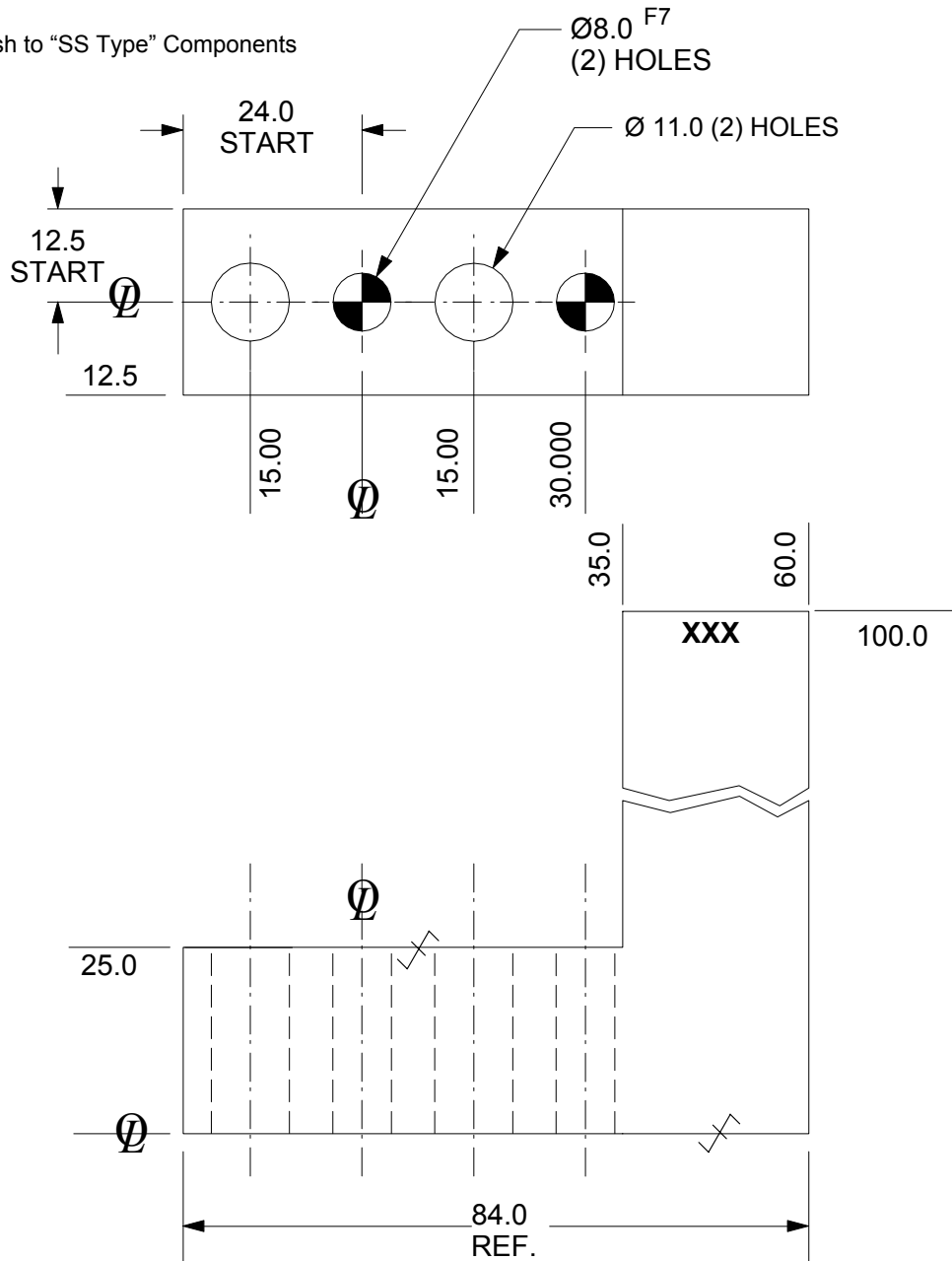

SEE PAGE B-1.1 FOR GLOBAL MATERIALS CHART

NAAMS CODE	MATERIAL	WT. kg
ANL106	STEEL SAE 4140	0.77
ANL107	SS type 303 or 304	0.77

D

C
A
B

NC BLOCK BLANKS

20 mm SERIES

ANL360–363, 368, 369

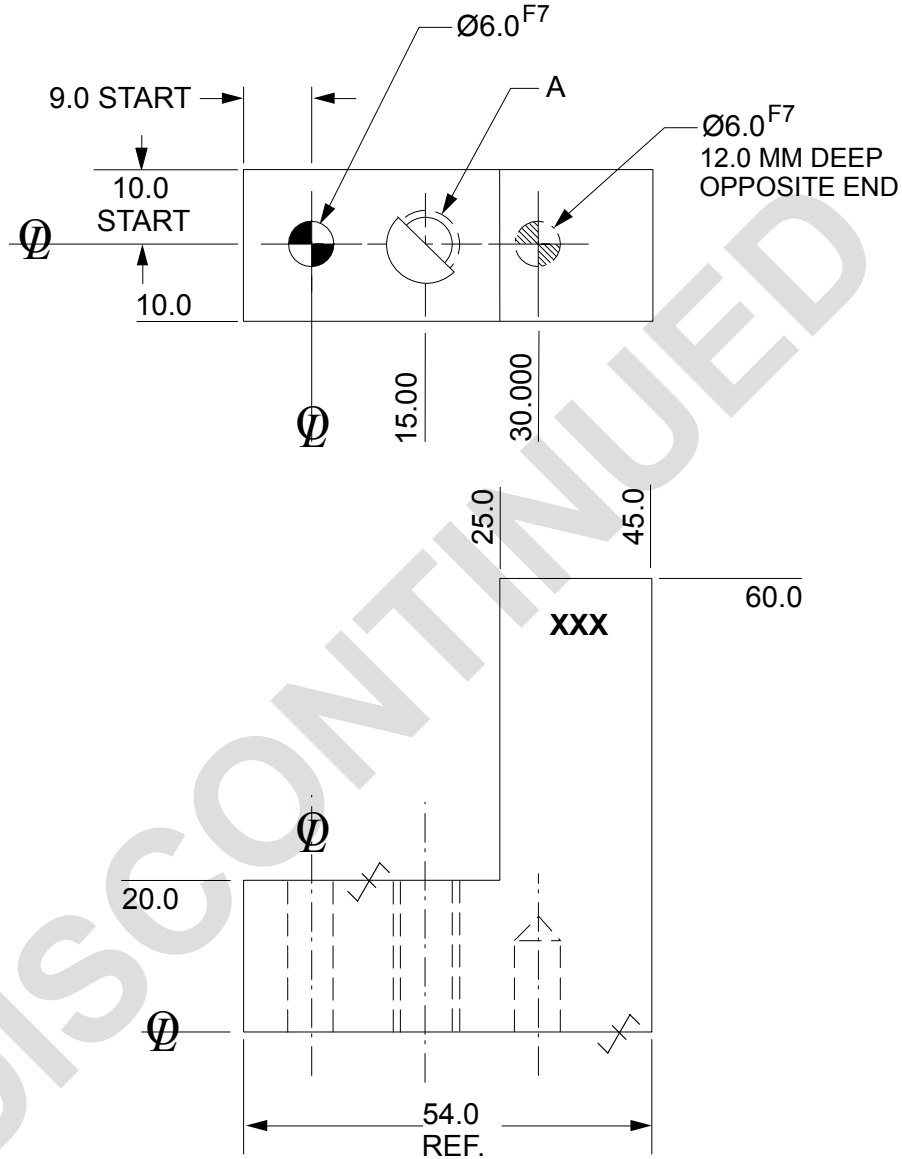

SEE PAGE B-1.1 FOR GLOBAL MATERIALS CHART

NAAMS CODE	A	MATERIAL	WT. kg
ANL368	M8 x 1.25	STEEL SAE 4140	0.29
ANL361	M8 x 1.25	SS type 303 or 304	0.29
ANL369	Ø 9.0	STEEL SAE 4140	0.29
ANL363	Ø 9.0	SS type 303 or 304	0.29

Tolerances: 1 PLACE ± 0.3
 2 PLACE ± 0.03
 3 PLACE ± 0.020

 SURFACES TO BE FLAT, PARALLEL & PERPENDICULAR TO WITHIN 0.015 T.I.R.
 NOTE: Identify with NAAMS CODE number as shown **XXX**.
 Black Oxide Finish

E

D
A
B
C

NC BLOCK BLANKS

20 mm SERIES

ANL364, 365

Tolerances: 1 PLACE ± 0.3
 2 PLACE ± 0.03
 3 PLACE ± 0.020

✓ SURFACES TO BE FLAT, PARALLEL & PERPENDICULAR TO WITHIN 0.015 T.I.R.
 NOTE: Identify with NAAMS CODE number as shown **XXX**.
 Black Oxide Finish
 No Black Oxide Finish to "SS Type" Components

D

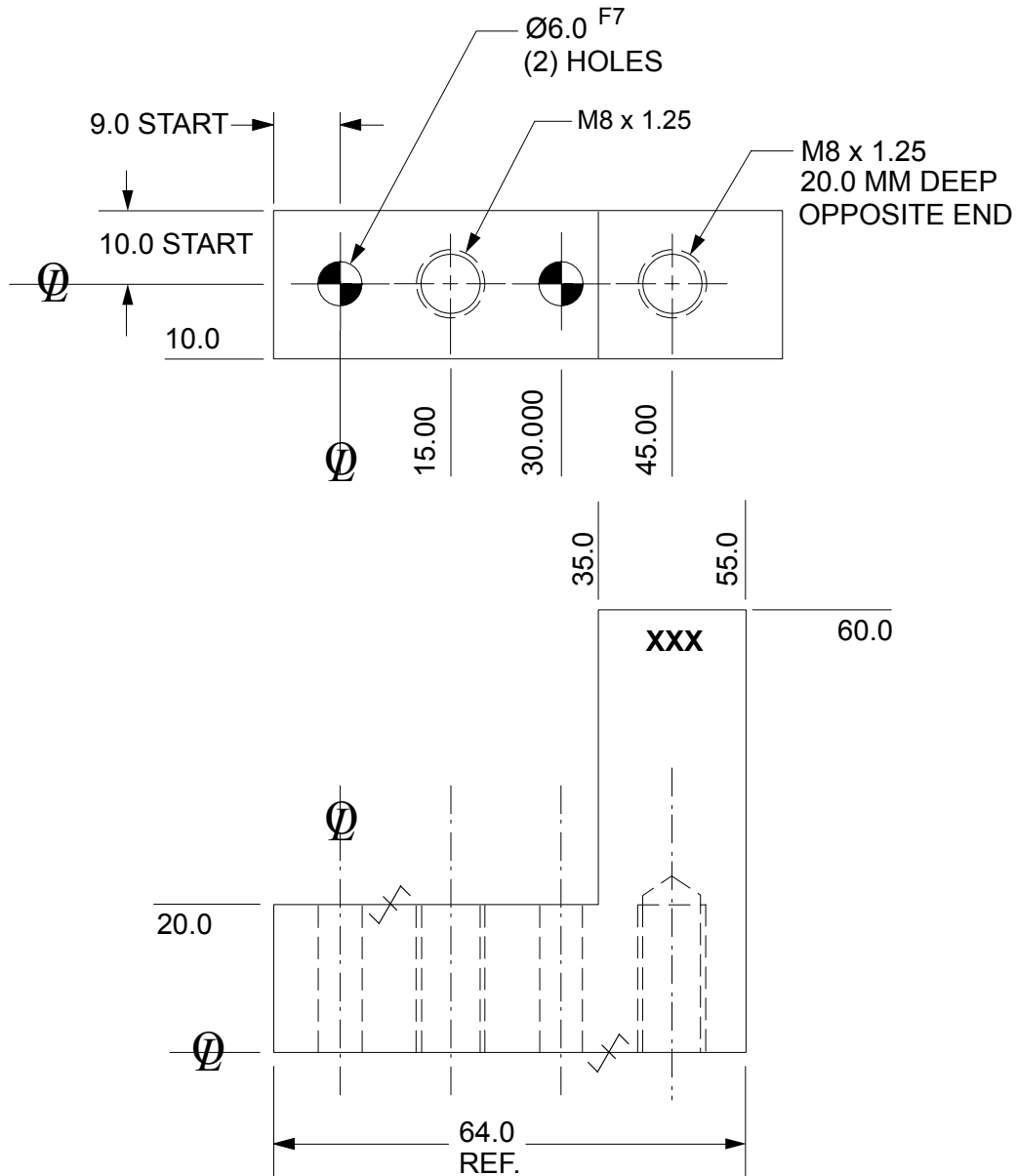

SEE PAGE B-1.1 FOR GLOBAL MATERIALS CHART

NAAMS CODE	MATERIAL	WT. kg
ANL364	STEEL SAE 4140	0.32
ANL365	SS type 303 or 304	0.32

C
A
B

NC BLOCK BLANKS

20 mm SERIES

ANL401,403,408,409

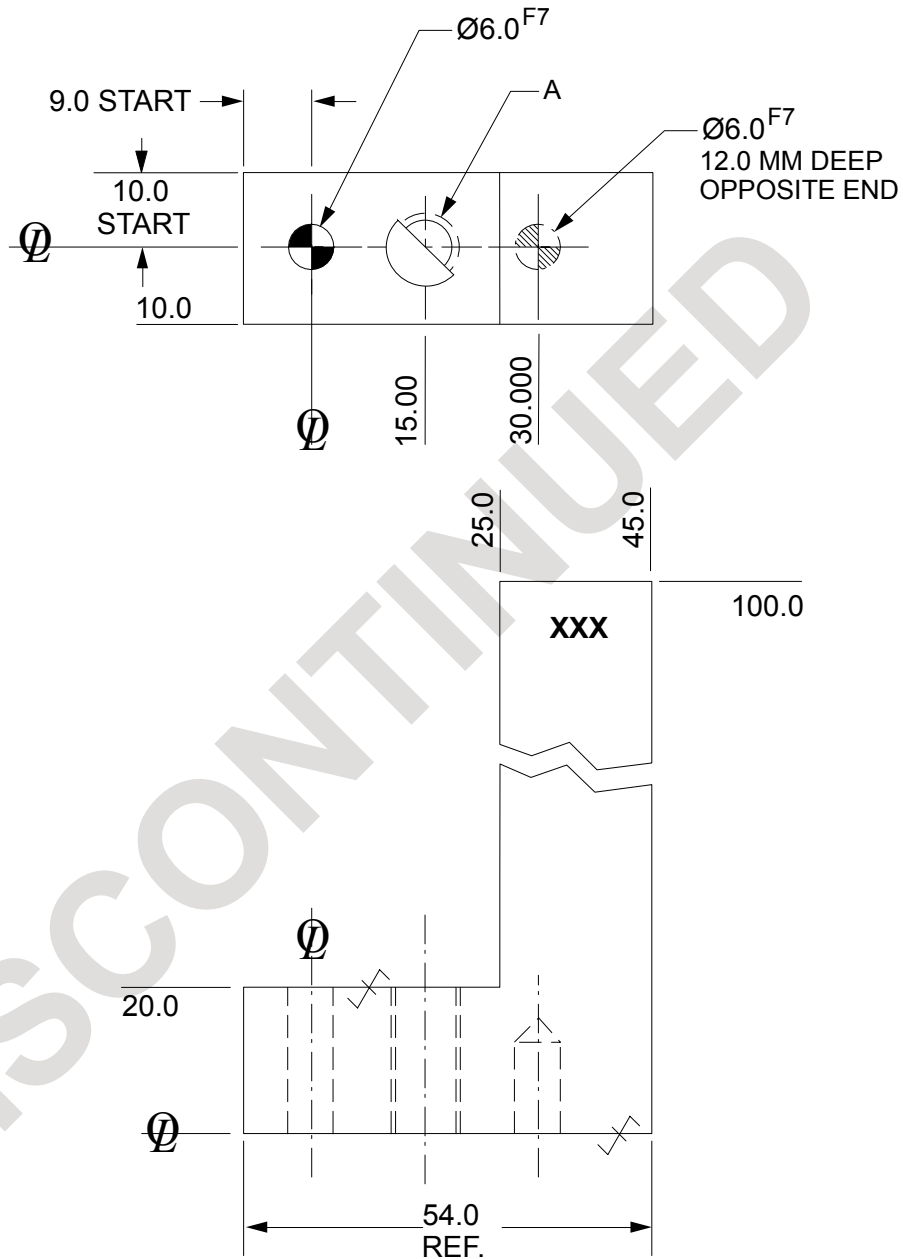

SEE PAGE B-1.1 FOR GLOBAL MATERIALS CHART

NAAMS CODE	A	MATERIAL	WT. kg
ANL408	M8 x 1.25	STEEL SAE 4140	0.41
ANL401	M8 x 1.25	SS type 303 or 304	0.41
ANL409	$\varnothing 9.0$	STEEL SAE 4140	0.41
ANL403	$\varnothing 9.0$	SS type 303 or 304	0.41

Tolerances: 1 PLACE ± 0.3
 2 PLACE ± 0.03
 3 PLACE ± 0.020

 SURFACES TO BE FLAT, PARALLEL & PERPENDICULAR TO WITHIN 0.015 T.I.R.
 NOTE: Identify with NAAMS CODE number as shown **XXX**.
 Black Oxide Finish

E
 A
 B
 C
 D

NC BLOCK BLANKS

20 mm SERIES

ANL404, 405

GLOBAL STANDARD COMPONENTS



Assembly

02/12/14

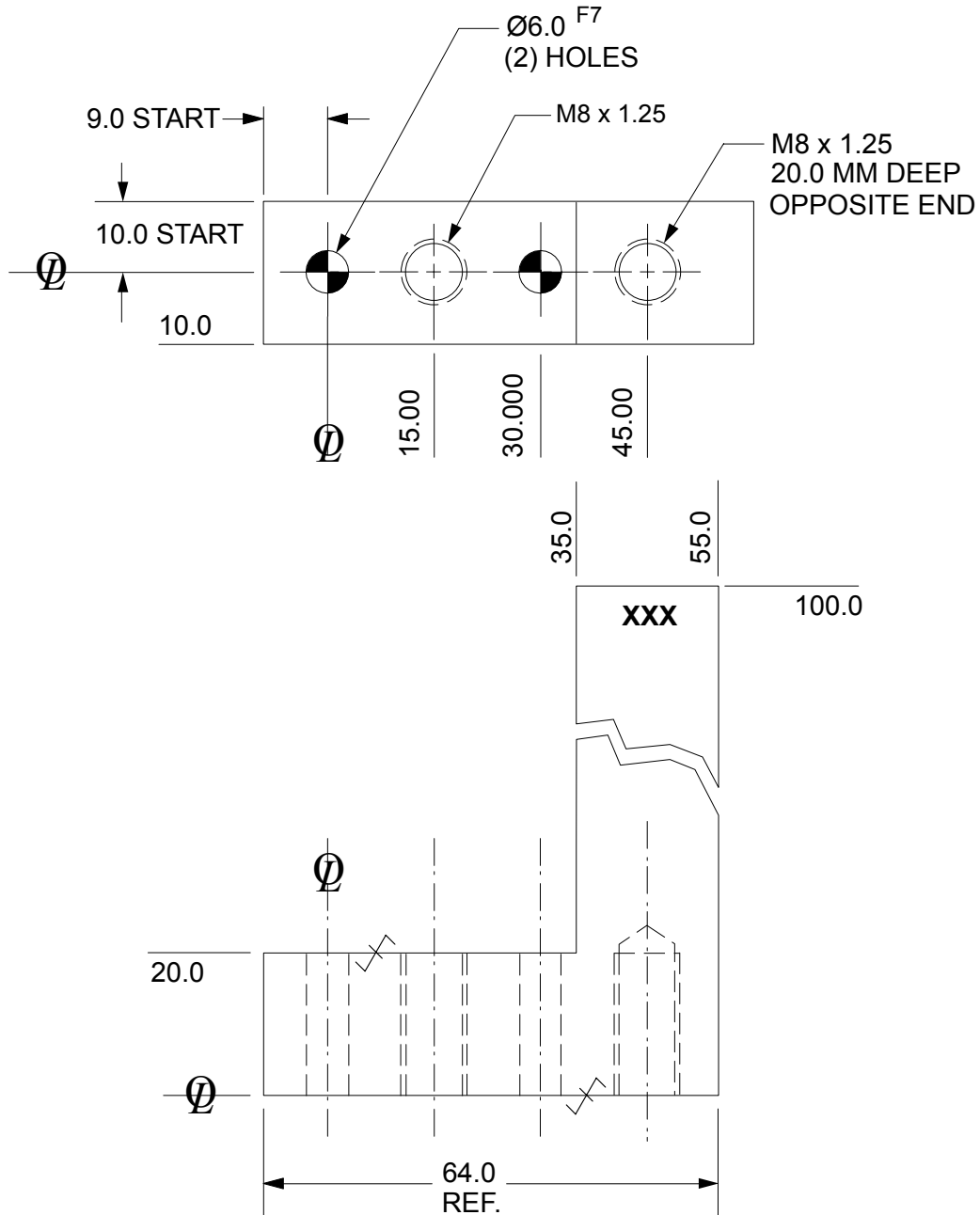

SEE PAGE B-1.1 FOR GLOBAL MATERIALS CHART

NAAMS CODE	MATERIAL	WT. kg
ANL404	STEEL SAE 4140	0.45
ANL405	SS type 303 or 304	0.45

Tolerances: 1 PLACE ± 0.3
2 PLACE ± 0.03
3 PLACE ± 0.020

✓ SURFACES TO BE FLAT, PARALLEL & PERPENDICULAR TO WITHIN 0.015 T.I.R.
NOTE: Identify with NAAMS CODE number as shown **XXX**.
Black Oxide Finish
No Black Oxide Finish to "SS Type" Components

C
A
B
D

NC BLOCK BLANKS

20 mm SERIES

ANL406, 407

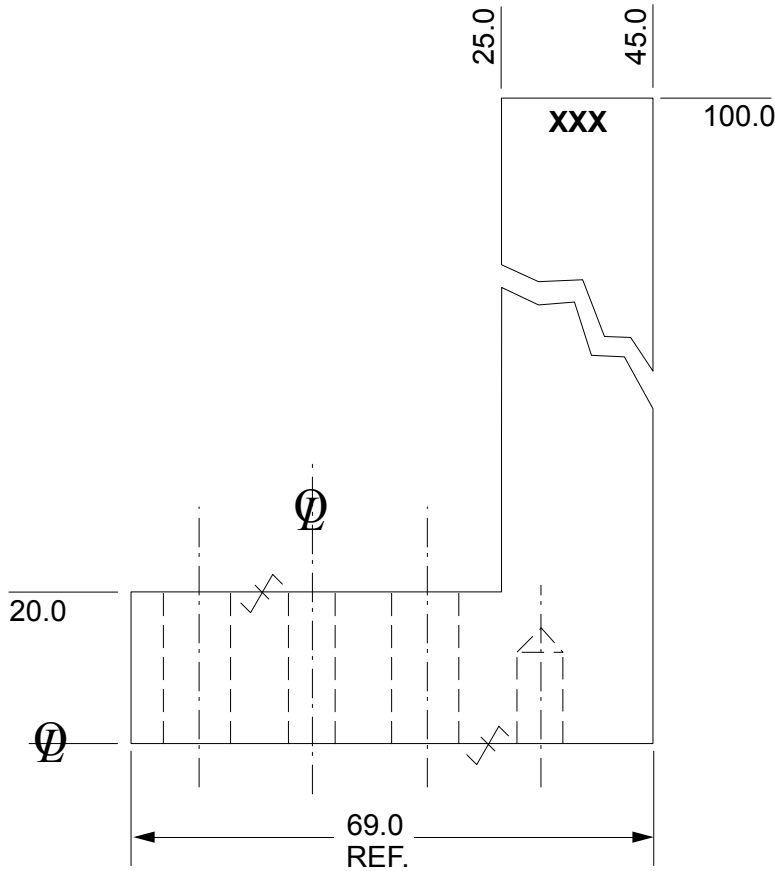
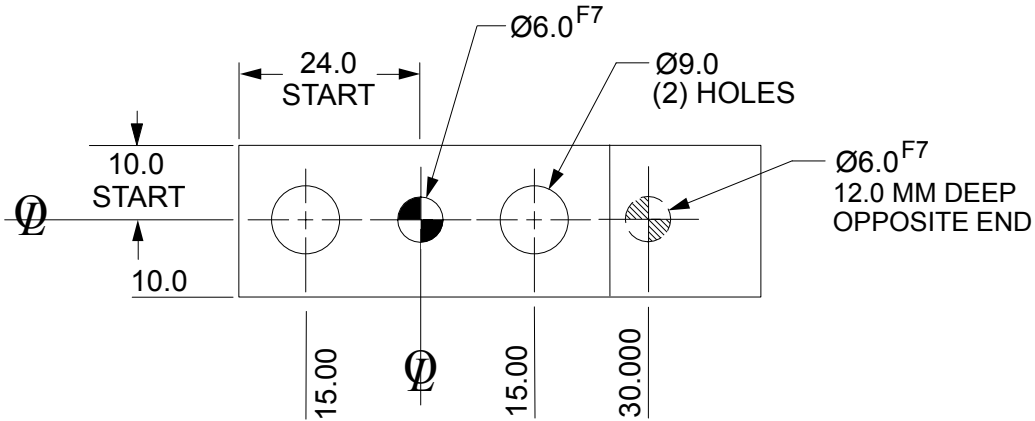

SEE PAGE B-1.1 FOR GLOBAL MATERIALS CHART

NAAMS CODE	MATERIAL	WT. kg
ANL406	STEEL SAE 4140	0.46
ANL407	SS type 303 or 304	0.46

Tolerances: 1 PLACE ± 0.3
 2 PLACE ± 0.03
 3 PLACE ± 0.020

 SURFACES TO BE FLAT, PARALLEL & PERPENDICULAR TO WITHIN 0.015 T.I.R.

NOTE: Identify with NAAMS CODE number as shown **XXX**.

Black Oxide Finish

No Black Oxide Finish to "SS Type" Components

C
A
B
D

NC BLOCK BLANKS 20 mm SERIES ANL215 THRU ANL218

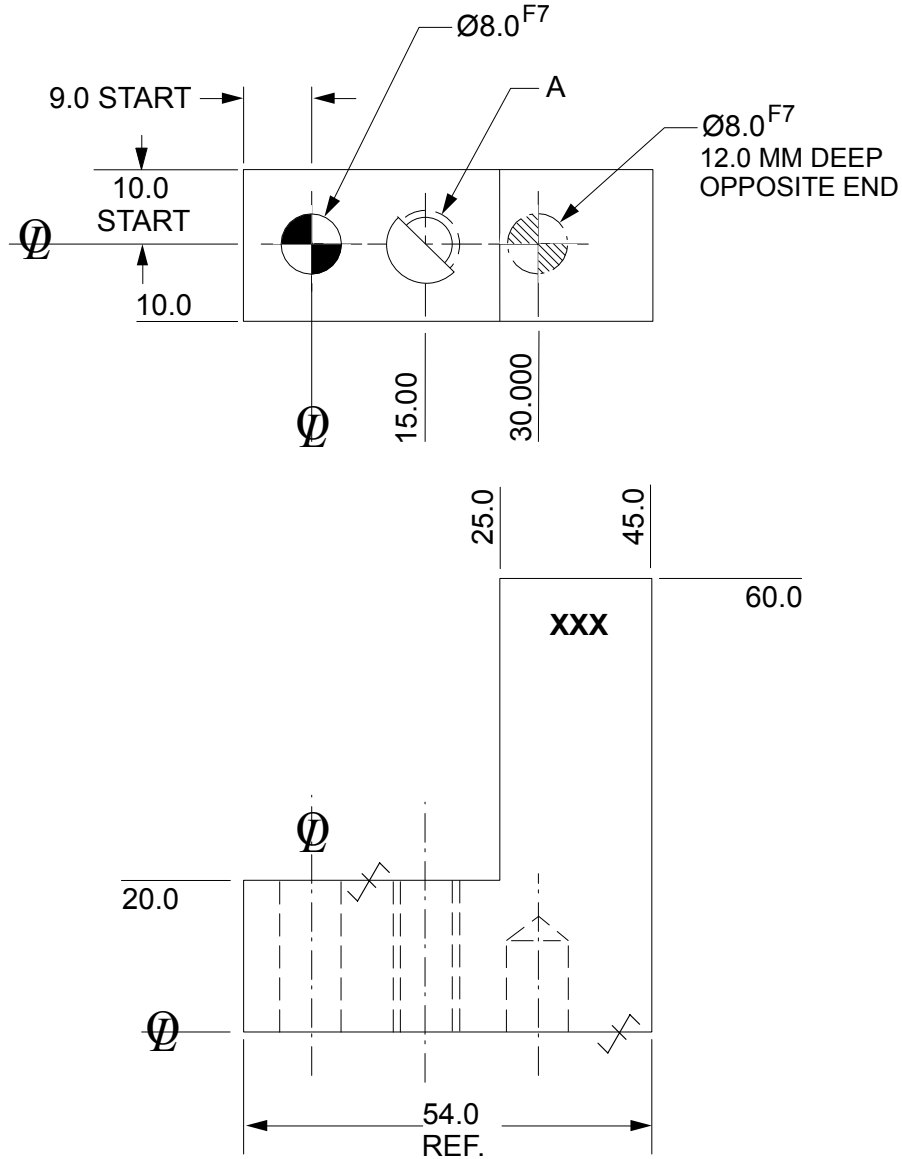

SEE PAGE B-1.1 FOR GLOBAL MATERIALS CHART

NAAMS CODE	A	MATERIAL	WT. kg
ANL215	M8 x 1.25	STEEL SAE 4140	0.29
ANL216	M8 x 1.25	SS type 303 or 304	0.29
ANL217	Ø 9.0	STEEL SAE 4140	0.29
ANL218	Ø 9.0	SS type 303 or 304	0.29

Tolerances: 1 PLACE ± 0.3
2 PLACE ± 0.03
3 PLACE ± 0.020

✓ SURFACES TO BE FLAT, PARALLEL & PERPENDICULAR TO WITHIN 0.015 T.I.R.
NOTE: Identify with NAAMS CODE number as shown **XXX**.
Black Oxide Finish

No Black Oxide Finish to "SS Type" Components

A

NC BLOCK BLANKS

20 mm SERIES

ANL211, ANL212

Tolerances: 1 PLACE ± 0.3
 2 PLACE ± 0.03
 3 PLACE ± 0.020

 SURFACES TO BE FLAT, PARALLEL & PERPENDICULAR TO WITHIN 0.015 T.I.R.

NOTE: Identify with NAAMS CODE number as shown **XXX**.

Black Oxide Finish

No Black Oxide Finish to "SS Type" Components

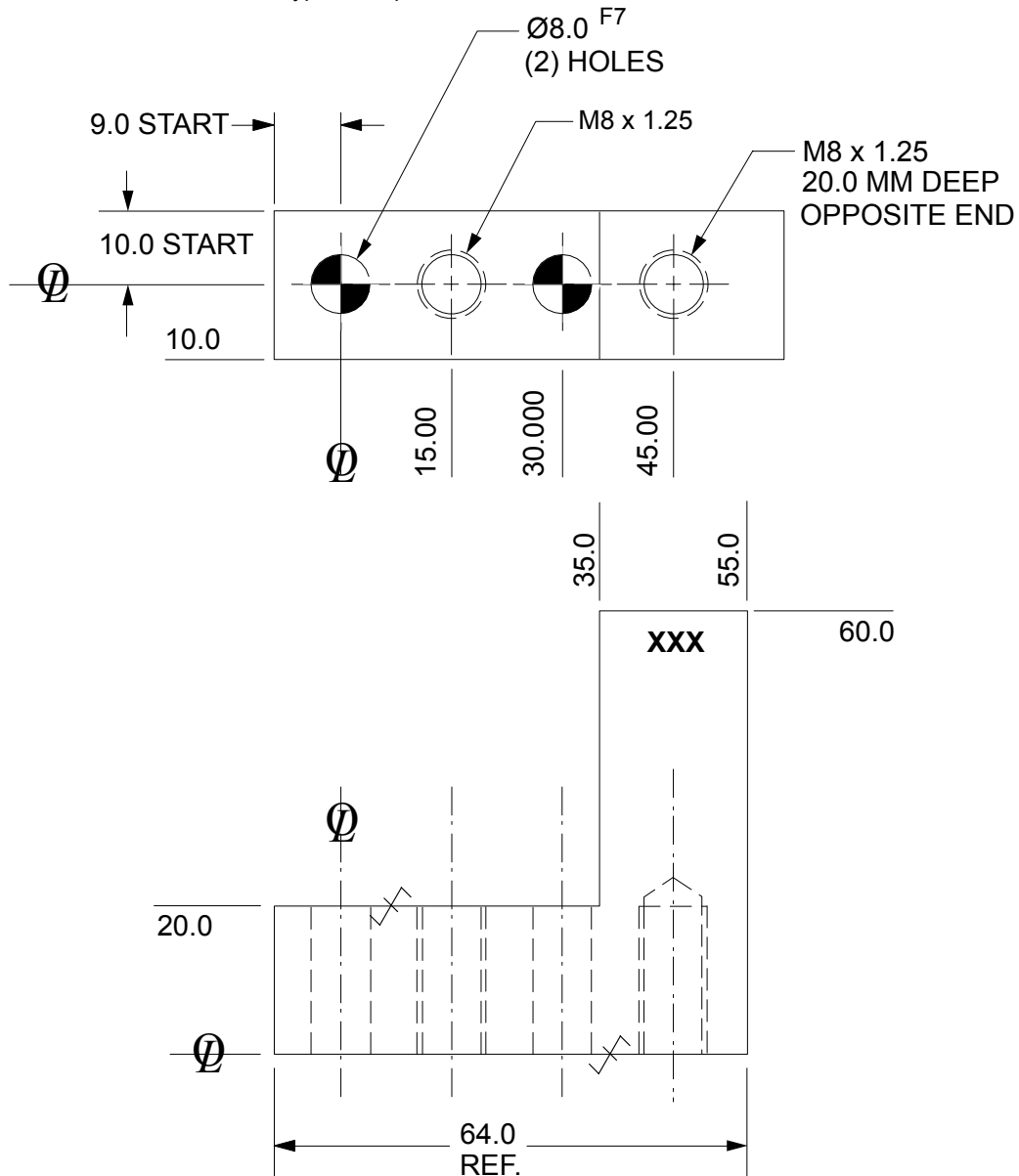

A

SEE PAGE B-1.1 FOR GLOBAL MATERIALS CHART

NAAMS CODE	MATERIAL	WT. kg
ANL211	STEEL SAE 4140	0.32
ANL212	SS type 303 or 304	0.32

NC BLOCK BLANKS 20 mm SERIES ANL225 THRU ANL228

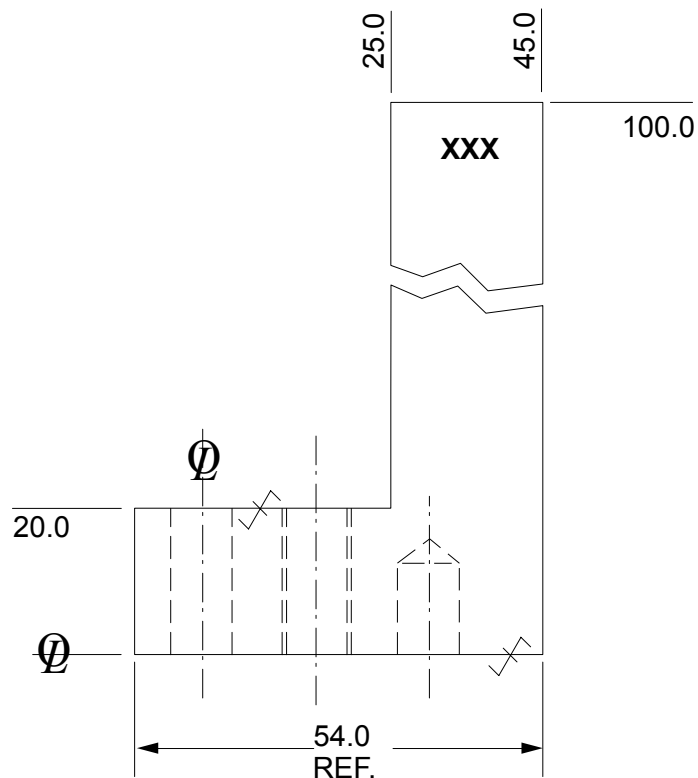
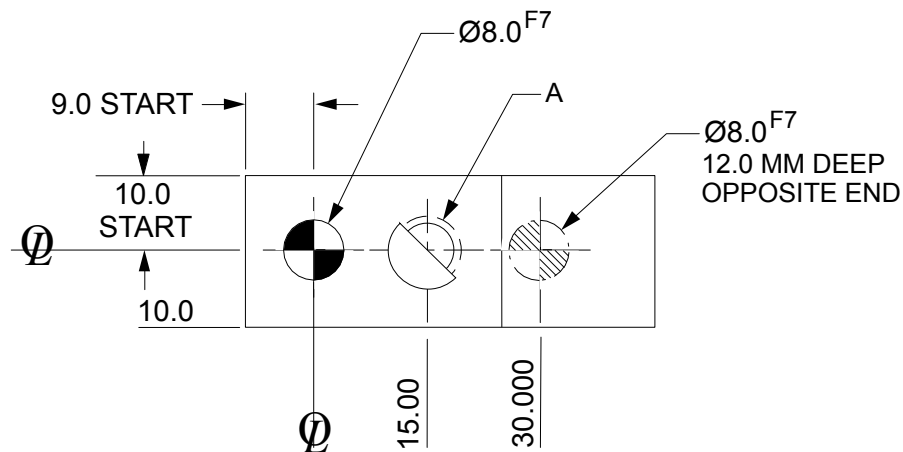

SEE PAGE B-1.1 FOR GLOBAL MATERIALS CHART

NAAMS CODE	A	MATERIAL	WT. kg
ANL225	M8 x 1.25	STEEL SAE 4140	0.41
ANL226	M8 x 1.25	SS type 303 or 304	0.41
ANL227	Ø 9.0	STEEL SAE 4140	0.41
ANL228	Ø 9.0	SS type 303 or 304	0.41

Tolerances: 1 PLACE ± 0.3
2 PLACE ± 0.03
3 PLACE ± 0.020

 SURFACES TO BE FLAT, PARALLEL & PERPENDICULAR TO WITHIN 0.015 T.I.R.

NOTE: Identify with NAAMS CODE number as shown **XXX**.

Black Oxide Finish

No Black Oxide Finish to "SS Type" Components

A

NC BLOCK BLANKS

20 mm SERIES

ANL311, ANL312

GLOBAL STANDARD COMPONENTS



Assembly

02/12/14

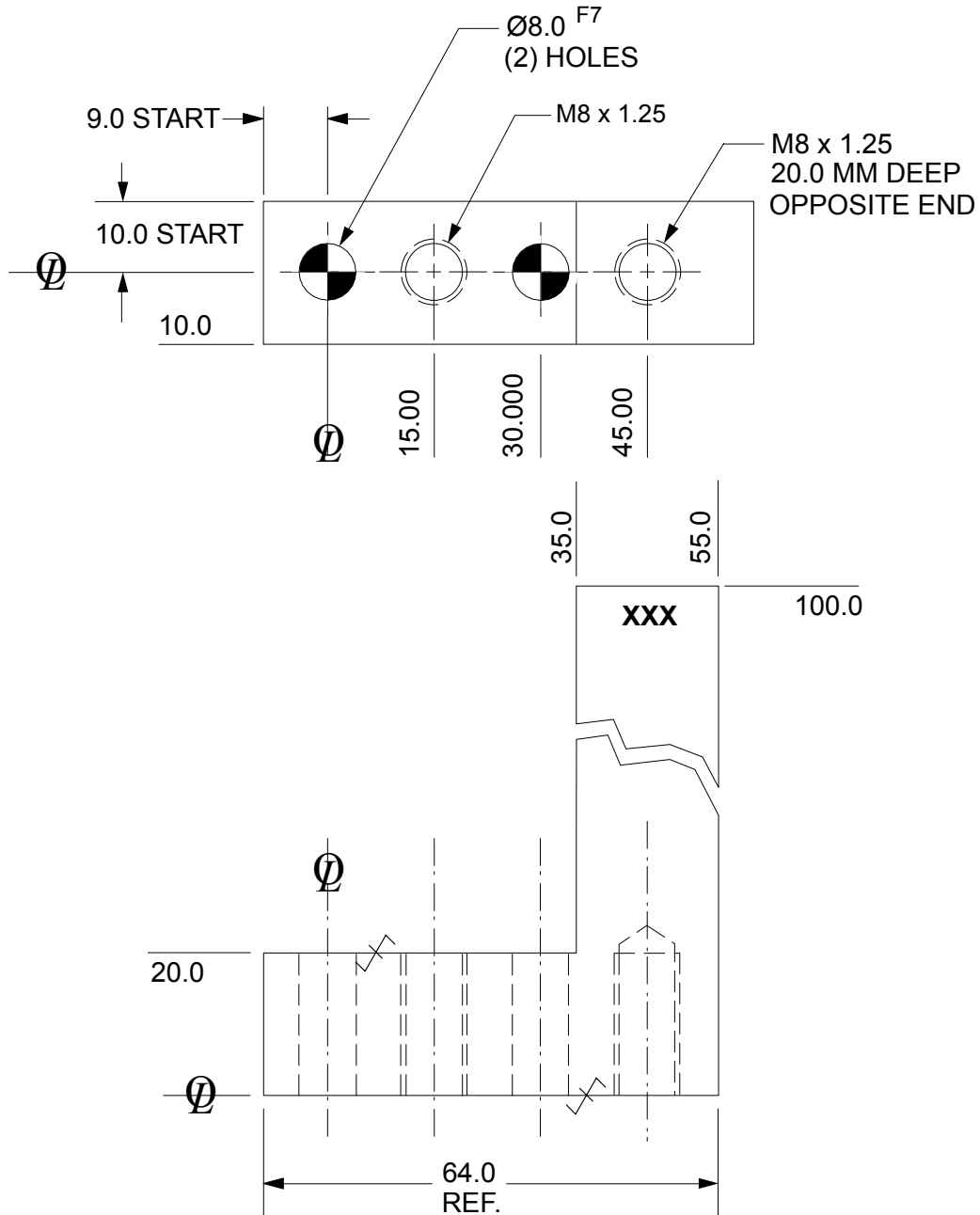

SEE PAGE B-1.1 FOR GLOBAL MATERIALS CHART

NAAMS CODE	MATERIAL	WT. kg
ANL311	STEEL SAE 4140	0.45
ANL312	SS type 303 or 304	0.45

Tolerances: 1 PLACE ± 0.3
 2 PLACE ± 0.03
 3 PLACE ± 0.020

SURFACES TO BE FLAT, PARALLEL & PERPENDICULAR TO WITHIN 0.015 T.I.R.
 NOTE: Identify with NAAMS CODE number as shown **XXX**.
 Black Oxide Finish
 No Black Oxide Finish to "SS Type" Components

A

NC BLOCK BLANKS

20 mm SERIES

ANL411, ANL412

GLOBAL STANDARD COMPONENTS



Assembly

02/12/14

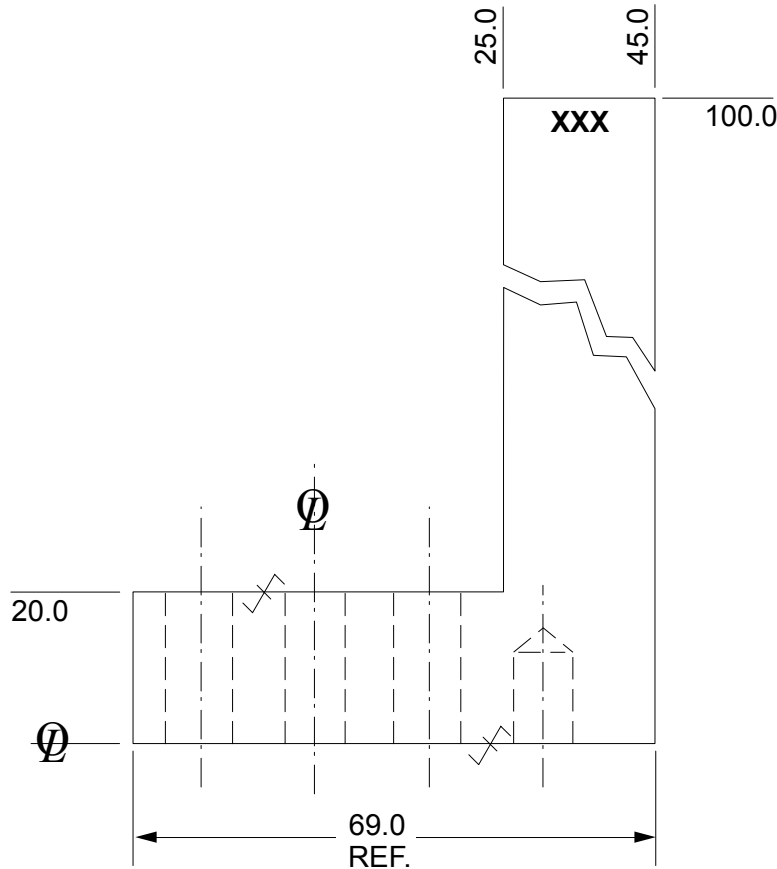
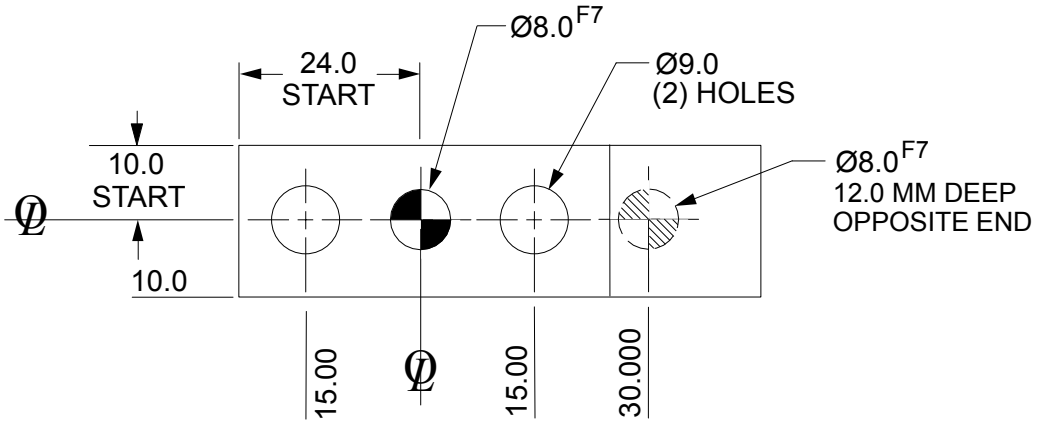

SEE PAGE B-1.1 FOR GLOBAL MATERIALS CHART

NAAMS CODE	MATERIAL	WT. kg
ANL411	STEEL SAE 4140	0.46
ANL412	SS type 303 or 304	0.46

Tolerances: 1 PLACE ± 0.3
 2 PLACE ± 0.03
 3 PLACE ± 0.020

SURFACES TO BE FLAT, PARALLEL & PERPENDICULAR TO WITHIN 0.015 T.I.R.

NOTE: Identify with NAAMS CODE number as shown **XXX**.

Black Oxide Finish

No Black Oxide Finish to "SS Type" Components

A