

NC BLOCK COMPONENTS INDEX

PAGE	DATE	NAAMS CODE	DESCRIPTION
0-1	02/12/14		NC Block Components Index
0-1.1	02/12/14		NC Block Components Index
0-2	02/12/14	ANI080 – ANI083	NC Blocks Blanks, I-Shaped, 3-Hole x 80
0-3	02/12/14	ANI084 – ANI087	NC Blocks Blanks, I-Shaped, 4-Hole x 80
0-4	02/12/14	ANI120 – ANI123	NC Blocks Blanks, I-Shaped, 3-Hole x 120
0-5	02/12/14	ANI126 – ANI129	NC Blocks Blanks, I-Shaped, 4-Hole x 120
0-6	02/12/14	ANL060 – ANL061	NC Blocks Blanks, L-Shaped, 3-Hole x 60
0-7	02/12/14	ANL062 – ANL063	NC Blocks Blanks, L-Shaped, 3-Hole x 60
0-8	02/12/14	ANL064 – ANL065	NC Blocks Blanks, L-Shaped, 4-Hole x 60
0-9	02/12/14	ANL066 – ANL067	NC Blocks Blanks, L-Shaped, 4-Hole x 60
0-10	02/12/14	ANL100 – ANL101	NC Blocks Blanks, L-Shaped, 3-Hole x 100
0-11	02/12/14	ANL102 – ANL103	NC Blocks Blanks, L-Shaped, 3-Hole x 100
0-12	02/12/14	ANL104 – ANL105	NC Blocks Blanks, L-Shaped, 4-Hole x 100
0-13	02/12/14	ANL106 – ANL107	NC Blocks Blanks, L-Shaped, 4-Hole x 100
0-14	02/12/14	ANR130 – ANR137	NC Blocks Blanks, Rectangular, 3-Hole
0-15	02/12/14	ANR140 – ANR147	NC Blocks Blanks, Rectangular, 4-Hole
0-16	02/12/14	ANR230 – ANR233	NC Blocks Blanks, Rectangular, 3-Hole
0-17	02/12/14	ANR240 – ANR243	NC Blocks Blanks, Rectangular, 4-Hole
0-18	07/25/08	ANI381 – ANI383 ANI391 – ANI392	NC Blocks Blanks, I-Shaped, 3-Hole x 80, 20 mm
0-19	02/12/14	ANI384 – ANI387	NC Blocks Blanks, I-Shaped, 4-Hole x 80, 20 mm
0-20	07/25/08	ANI421 – ANI425	NC Blocks Blanks, I-Shaped, 3-Hole x 120, 20 mm
0-21	02/12/14	ANI426 – ANI429	NC Blocks Blanks, I-Shaped, 4-Hole x 120, 20 mm
0-22	07/25/08	ANL361 – ANL363 ANL368 – ANL369	NC Blocks Blanks, L-Shaped, 3-Hole x 60, 20 mm
0-23	02/12/14	ANL364 – ANL365	NC Blocks Blanks, L-Shaped, 4-Hole x 60, 20 mm
0-24	02/12/14	ANL366 – ANL367	NC Blocks Blanks, L-Shaped, 4-Hole x 60, 20 mm
0-25	07/25/08	ANL401 – ANL403 ANL408 – ANL409	NC Blocks Blanks, L-Shaped, 3-Hole x 100, 20 mm
0-26	02/12/14	ANL404 – ANL405	NC Blocks Blanks, L-Shaped, 4-Hole x 100, 20 mm
0-27	02/12/14	ANL406 – ANL407	NC Blocks Blanks, L-Shaped, 4-Hole x 100, 20 mm
0-28	07/25/08	ANR431 – ANR437 ANR448 – ANR451	NC Blocks Blanks, Rectangular, 3-Hole, 20 mm
0-29	02/12/14	ANR440 – ANR447	NC Blocks Blanks, Rectangular, 4-Hole, 20 mm
0-30	07/25/08	ANR531 – ANR535	NC Blocks Blanks, Rectangular, 3-Hole, 20 mm
0-31	02/12/14	ANR540 – ANR543	NC Blocks Blanks, Rectangular, 4-Hole, 20 mm

NC BLOCK COMPONENTS INDEX

PAGE	DATE	NAAMS CODE	DESCRIPTION
0-32	02/12/14	ANI206 - ANI209	NC BLANKS 20mm SERIES
0-33	02/12/14	ANI201 - ANI204	NC BLANKS 20mm SERIES
0-34	02/12/14	ANI216 - ANI219	NC BLANKS 20mm SERIES
0-35	02/12/14	ANI211 - ANI214	NC BLANKS 20mm SERIES
0-36	02/12/14	ANL215 - ANL218	NC BLANKS 20mm SERIES
0-37	02/12/14	ANL211 - ANL212	NC BLANKS 20mm SERIES
0-38	02/12/14	ANL221 - ANL222	NC BLANKS 20mm SERIES
0-39	02/12/14	ANL225 - ANL228	NC BLANKS 20mm SERIES
0-40	02/12/14	ANL311 - ANL312	NC BLANKS 20mm SERIES
0-41	02/12/14	ANL411 - ANL412	NC BLANKS 20mm SERIES
0-42	02/12/14	ANR600 - ANR607	NC BLANKS 20mm SERIES
0-43	02/12/14	ANR301 - ANR308	NC BLANKS 20mm SERIES
0-44	02/12/14	ANR320 - ANR323	NC BLANKS 20mm SERIES
0-45	02/12/14	ANR311 - ANR314	NC BLANKS 20mm SERIES

NC BLOCK BLANKS

ANI080, 081, 082, 083

Tolerances: 1 PLACE ± 0.3
 2 PLACE ± 0.03
 3 PLACE ± 0.020

 SURFACES TO BE FLAT, PARALLEL &
 PERPENDICULAR TO WITHIN 0.015 T.I.R.
 NOTE: Identify with NAAMS CODE number as shown **XXX**.
 Black Oxide Finish
 No Black Oxide Finish to "SS Type" Components

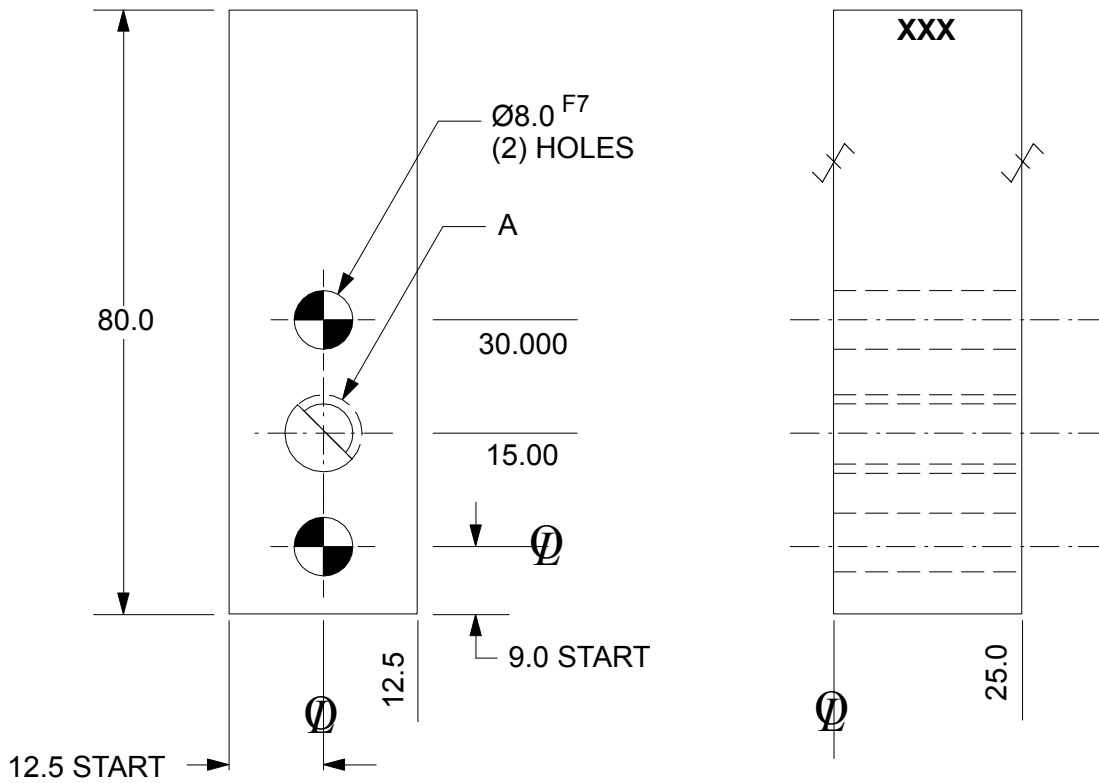

SEE PAGE B-1.1 FOR GLOBAL MATERIALS CHART

NAAMS CODE	A	MATERIAL	WT. kg
ANI080	M10 x 1.5	STEEL SAE 4140	0.39
ANI081	M10 x 1.5	SS type 303 or 304	0.39
ANI082	11.0	STEEL SAE 4140	0.39
ANI083	11.0	SS type 303 or 304	0.39

E

A

D

B

C

NC BLOCK BLANKS

ANI084, 085, 086, 087

Tolerances: 1 PLACE ± 0.3
 2 PLACE ± 0.03
 3 PLACE ± 0.020

✓ SURFACES TO BE FLAT, PARALLEL & PERPENDICULAR TO WITHIN 0.015 T.I.R.

NOTE: Identify with NAAMS CODE number as shown **XXX**.
 Black Oxide Finish
 No Black Oxide Finish to "SS Type" Components

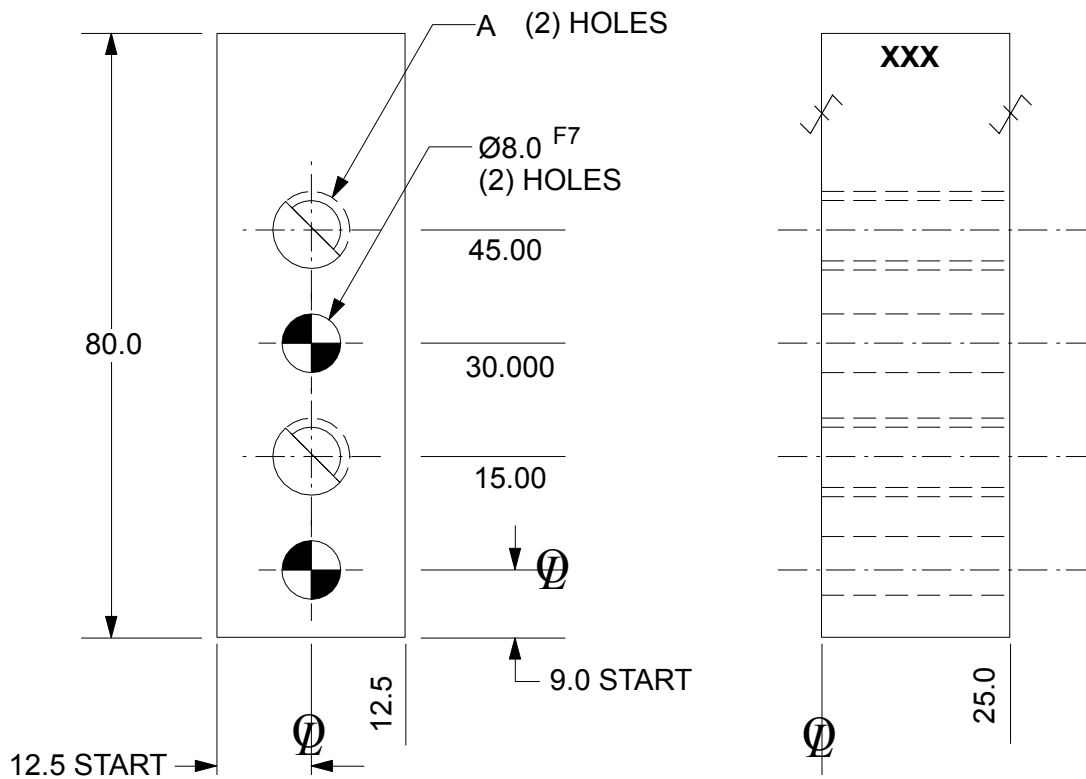

E

A

SEE PAGE B-1.1 FOR GLOBAL MATERIALS CHART

NAAMS CODE	A	MATERIAL	WT. kg
ANI084	M10 x 1.5	STEEL SAE 4140	0.39
ANI085	M10 x 1.5	SS type 303 or 304	0.39
ANI086	$\varnothing 11.0$	STEEL SAE 4140	0.39
ANI087	$\varnothing 11.0$	SS type 303 or 304	0.39

D

B

C

NC BLOCK BLANKS

ANI120, 121, 122, 123

Tolerances: 1 PLACE ± 0.3
 2 PLACE ± 0.03
 3 PLACE ± 0.020

✓ SURFACES TO BE FLAT, PARALLEL & PERPENDICULAR TO WITHIN 0.015 T.I.R.

NOTE: Identify with NAAMS CODE number as shown **XXX**.
 Black Oxide Finish
 No Black Oxide Finish to "SS Type" Components

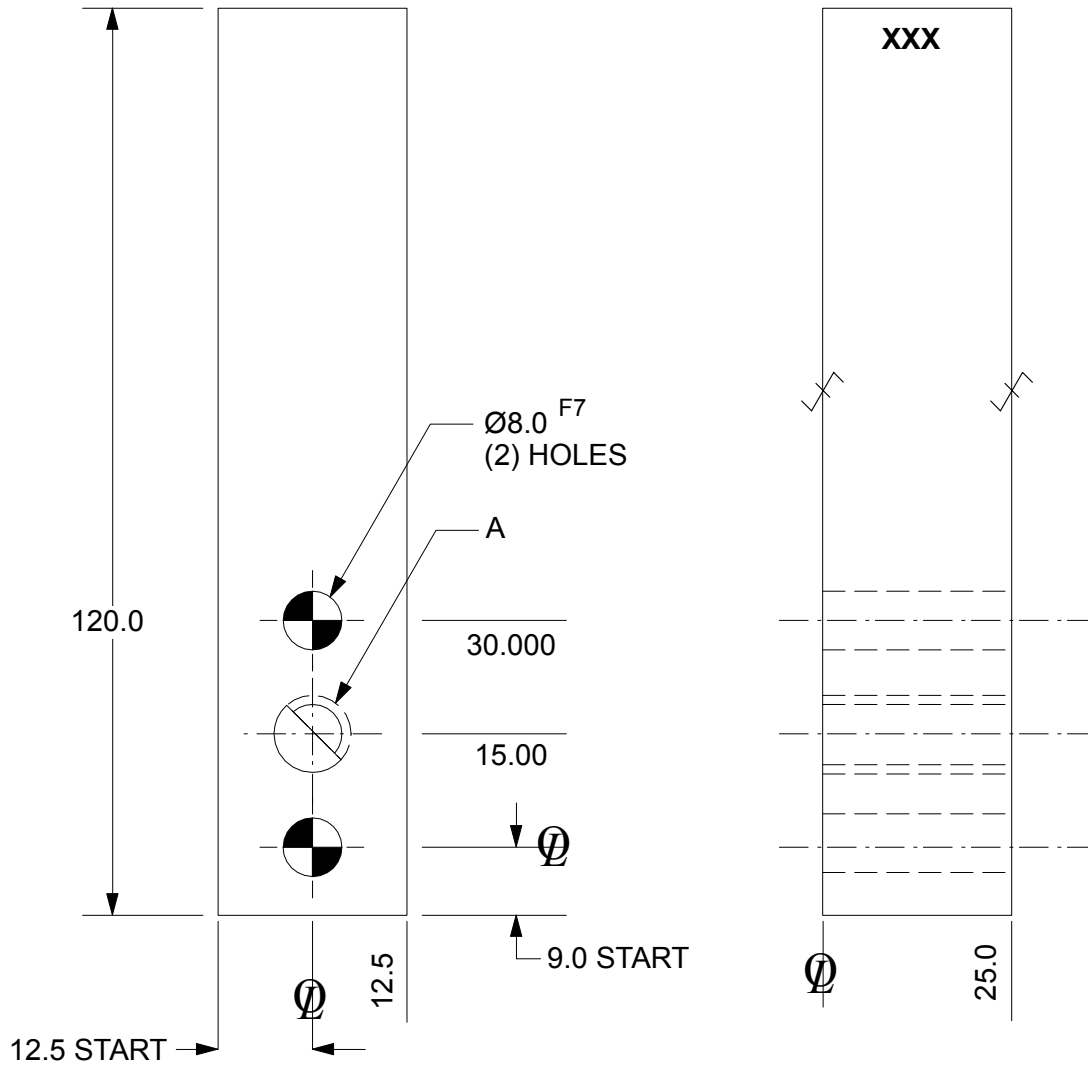

SEE PAGE B-1.1 FOR GLOBAL MATERIALS CHART

NAAMS CODE	A	MATERIAL	WT. kg
ANI120	M10 x 1.5	STEEL SAE 4140	0.59
ANI121	M10 x 1.5	SS type 303 or 304	0.59
ANI122	$\varnothing 11.0$	STEEL SAE 4140	0.59
ANI123	$\varnothing 11.0$	SS type 303 or 304	0.59

E

A

D

B

C

NC BLOCK BLANKS

ANI126, 127, 128, 129

Tolerances: 1 PLACE ± 0.3
 2 PLACE ± 0.03
 3 PLACE ± 0.020

 SURFACES TO BE FLAT, PARALLEL & PERPENDICULAR TO WITHIN 0.015 T.I.R.

NOTE: Identify with NAAMS CODE number as shown **XXX**.
 Black Oxide Finish
 No Black Oxide Finish to "SS Type" Components

D

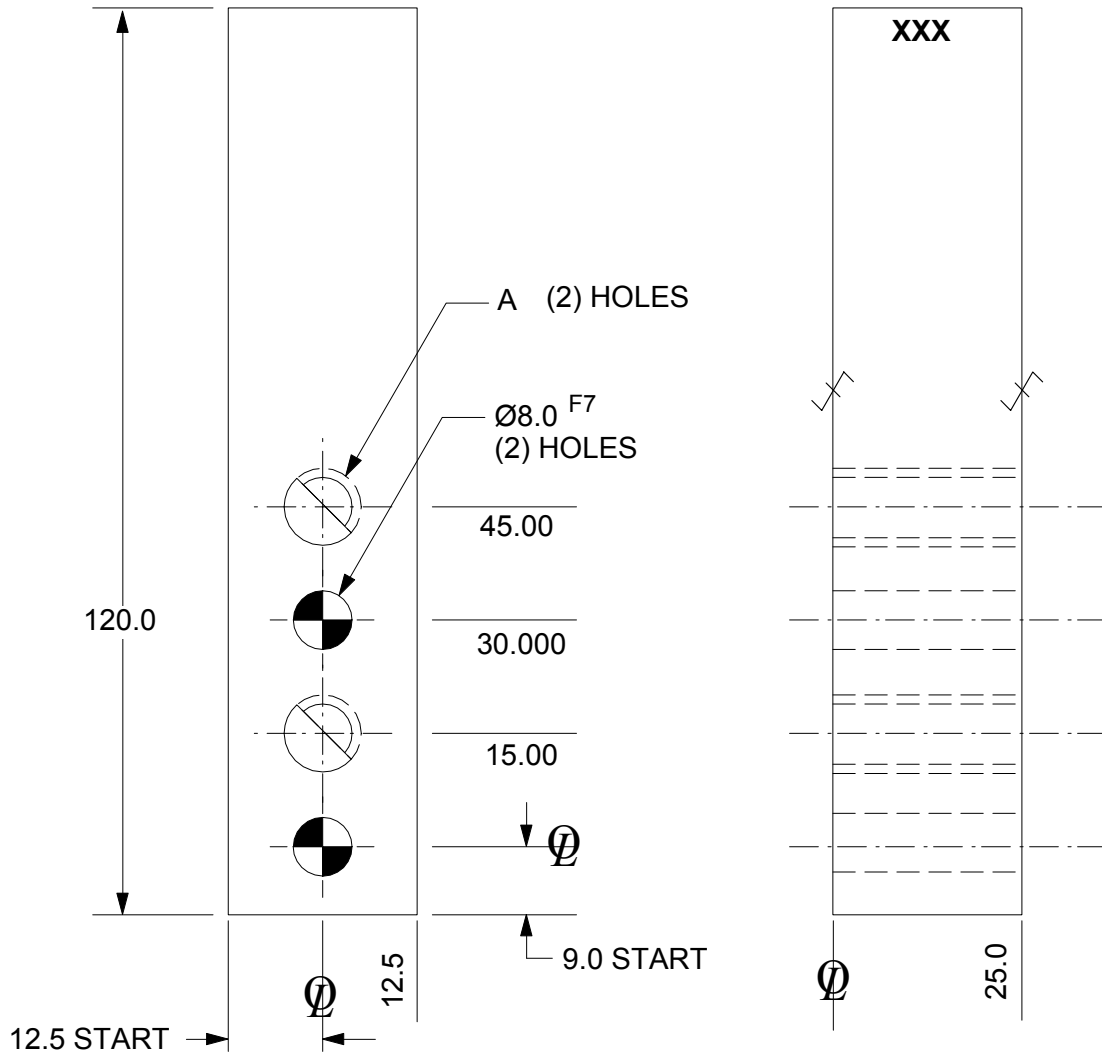

SEE PAGE B-1.1 FOR GLOBAL MATERIALS CHART

NAAMS CODE	A	MATERIAL	WT. kg
ANI126	M10 x 1.5	STEEL SAE 4140	0.59
ANI127	M10 x 1.5	SS type 303 or 304	0.59
ANI128	$\text{Ø}11.0$	STEEL SAE 4140	0.59
ANI129	$\text{Ø}11.0$	SS type 303 or 304	0.59

C
A
B

NC BLOCK BLANKS

20 mm SERIES

ANI381,383,391,392

GLOBAL STANDARD COMPONENTS



Assembly

07/25/08

Tolerances: 1 PLACE ± 0.3
 2 PLACE ± 0.03
 3 PLACE ± 0.020

SURFACES TO BE FLAT, PARALLEL & PERPENDICULAR TO WITHIN 0.015 T.I.R.

NOTE: Identify with NAAMS CODE number as shown **XXX**.
 Black Oxide Finish

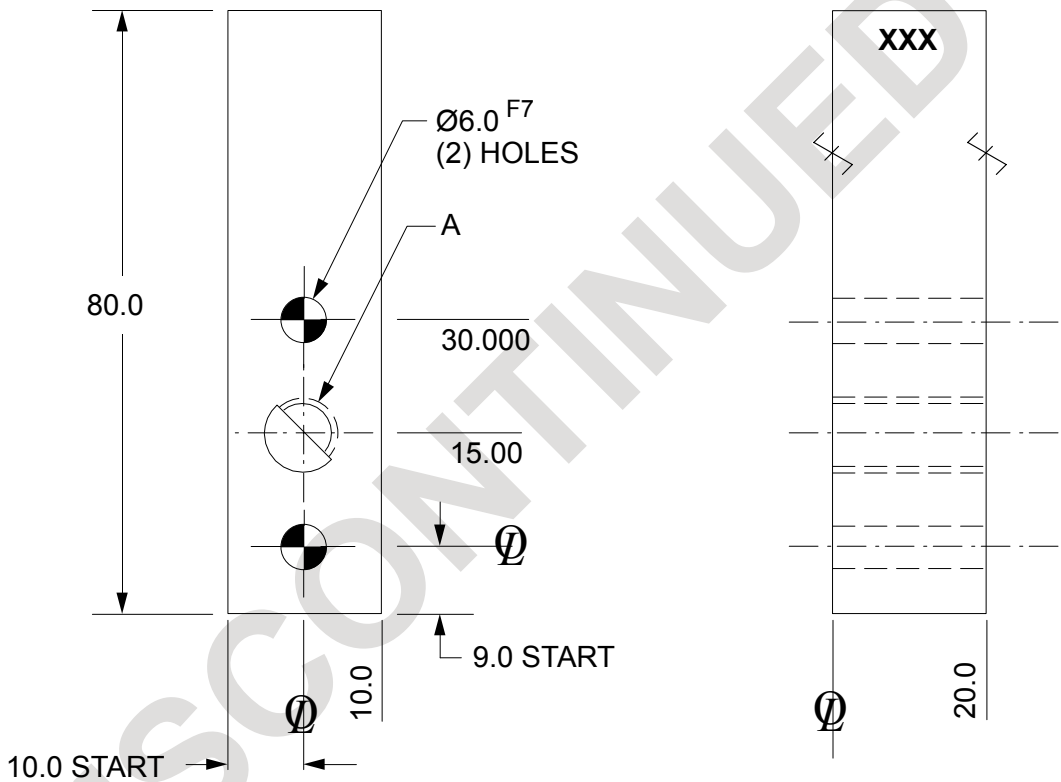

SEE PAGE B-1.1 FOR GLOBAL MATERIALS CHART

NAAMS CODE	A	MATERIAL	WT. kg
ANI391	M8 x 1.25	STEEL SAE 4140	0.25
ANI381	M8 x 1.25	SS type 303 or 304	0.25
ANI392	$\text{\O} 9.0$	STEEL SAE 4140	0.25
ANI383	$\text{\O} 9.0$	SS type 303 or 304	0.25

A
B
C
D

NC BLOCK BLANKS

20 mm SERIES

ANI384, 385, 386, 387

Tolerances: 1 PLACE ± 0.3
 2 PLACE ± 0.03
 3 PLACE ± 0.020

✓ SURFACES TO BE FLAT, PARALLEL &
 PERPENDICULAR TO WITHIN 0.015 T.I.R.

NOTE: Identify with NAAMS CODE number as shown **XXX**.
 Black Oxide Finish
 No Black Oxide Finish to "SS Type" Components

D

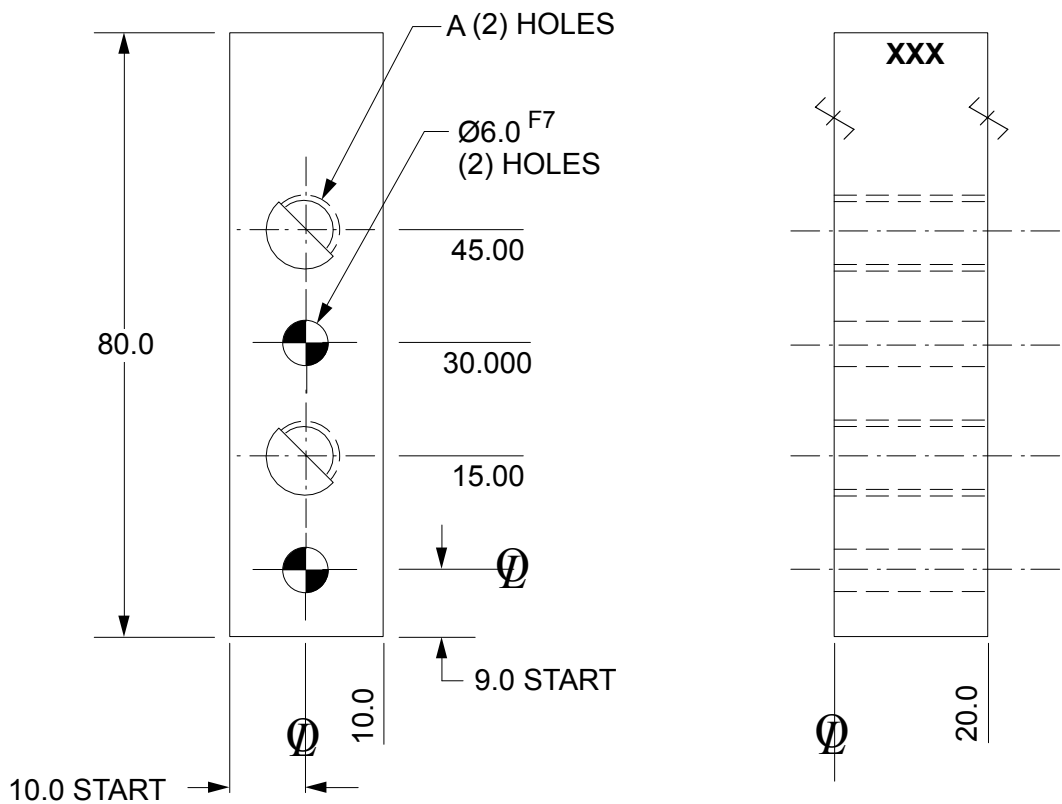

SEE PAGE B-1.1 FOR GLOBAL MATERIALS CHART

NAAMS CODE	A	MATERIAL	WT. kg
ANI384	M8 x 1.25	STEEL SAE 4140	0.25
ANI385	M8 x 1.25	SS type 303 or 304	0.25
ANI386	$\text{Ø} 9.0$	STEEL SAE 4140	0.25
ANI387	$\text{Ø} 9.0$	SS type 303 or 304	0.25

C
A
B

NC BLOCK BLANKS

20 mm SERIES

ANI420,421,423,425

GLOBAL STANDARD COMPONENTS



Assembly

07/25/08

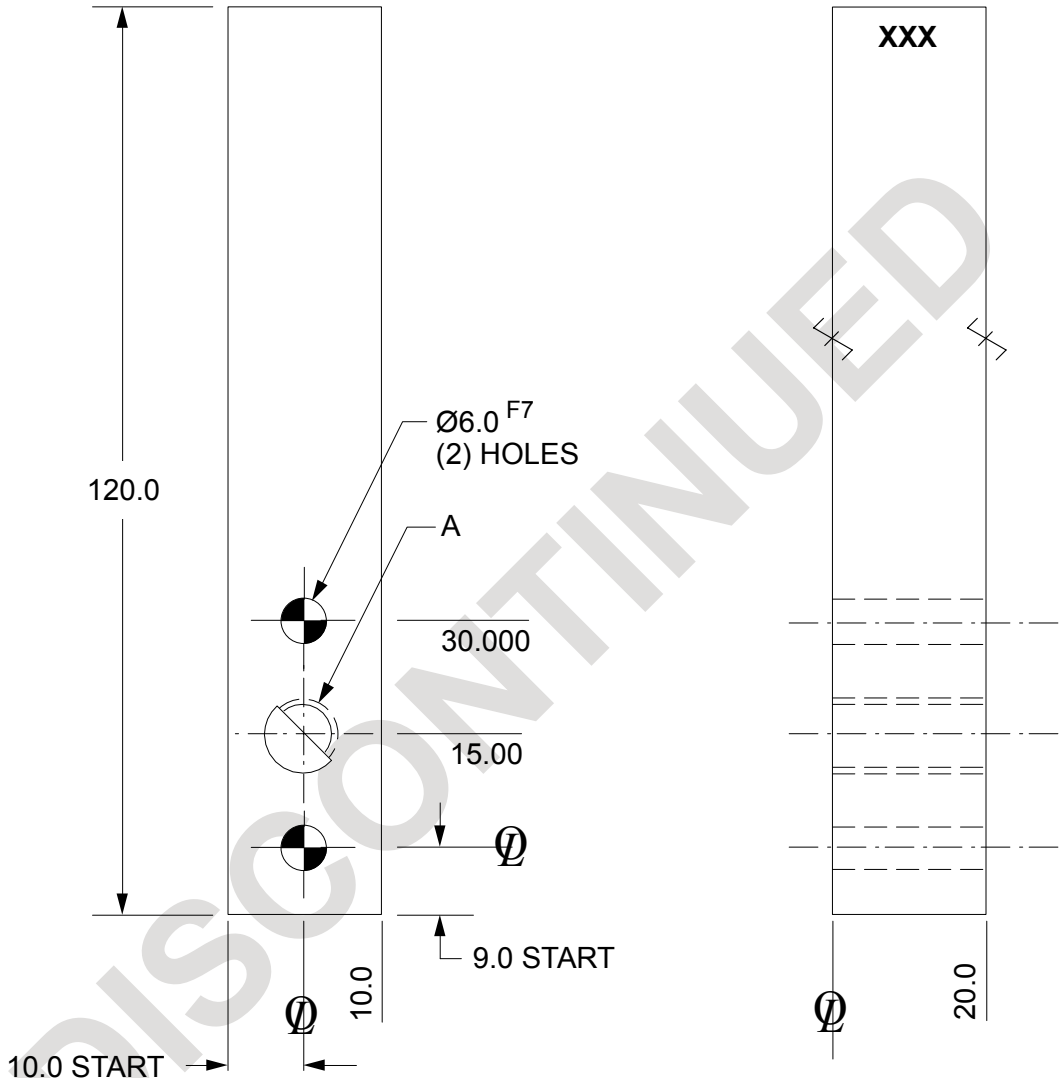

E

SEE PAGE B-1.1 FOR GLOBAL MATERIALS CHART

NAAMS CODE	A	MATERIAL	WT. kg
ANI424	M8 x 1.25	STEEL SAE 4140	0.37
ANI421	M8 x 1.25	SS type 303 or 304	0.37
ANI425	$\text{\O} 9.0$	STEEL SAE 4140	0.37
ANI423	$\text{\O} 9.0$	SS type 303 or 304	0.37

Tolerances: 1 PLACE ± 0.3
 2 PLACE ± 0.03
 3 PLACE ± 0.020

✓ SURFACES TO BE FLAT, PARALLEL & PERPENDICULAR TO WITHIN 0.015 T.I.R.
 NOTE: Identify with NAAMS CODE number as shown **XXX**.
 Black Oxide Finish

A
 B
 C
 D

NC BLOCK BLANKS

20 mm SERIES

ANI426, 427, 428, 429

Tolerances: 1 PLACE ± 0.3
 2 PLACE ± 0.03
 3 PLACE ± 0.020

 SURFACES TO BE FLAT, PARALLEL & PERPENDICULAR TO WITHIN 0.015 T.I.R.

NOTE: Identify with NAAMS CODE number as shown **XXX**.
 Black Oxide Finish
 No Black Oxide Finish to "SS Type" Components

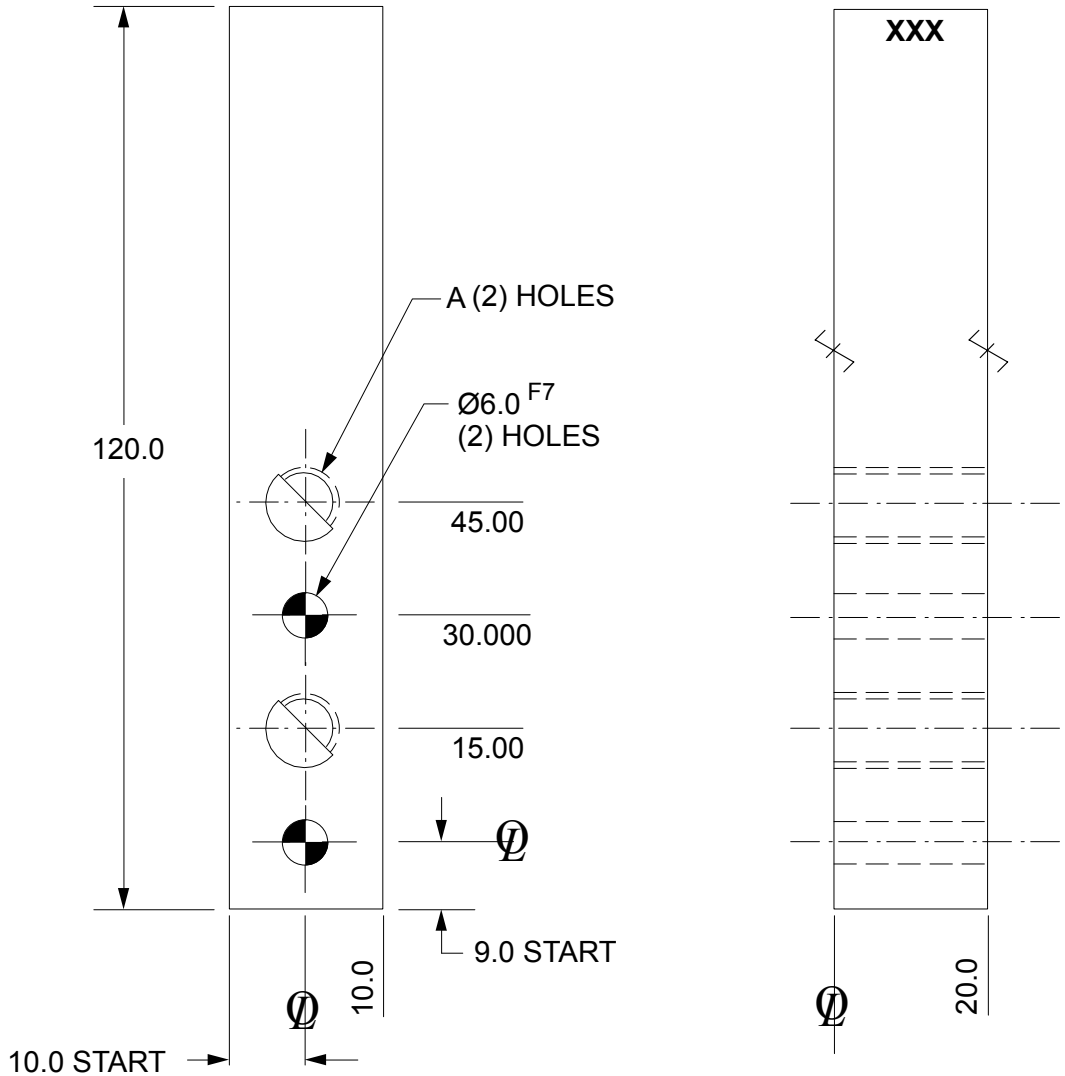

SEE PAGE B-1.1 FOR GLOBAL MATERIALS CHART

NAAMS CODE	A	MATERIAL	WT. kg
ANI426	M8 x 1.25	STEEL SAE 4140	0.41
ANI427	M8 x 1.25	SS type 303 or 304	0.41
ANI428	Ø9.0	STEEL SAE 4140	0.41
ANI429	Ø9.0	SS type 303 or 304	0.41

D

C
A
B

NC BLOCK BLANKS

20 mm SERIES

ANI206 THRU ANI209

GLOBAL STANDARD COMPONENTS



Assembly

02/12/14

Tolerances: 1 PLACE ± 0.3
 2 PLACE ± 0.03
 3 PLACE ± 0.020

✓ SURFACES TO BE FLAT, PARALLEL &
 PERPENDICULAR TO WITHIN 0.015 T.I.R.

NOTE: Identify with NAAMS CODE number as shown **XXX**.
 Black Oxide Finish
 No Black Oxide Finish to "SS Type" Components

A

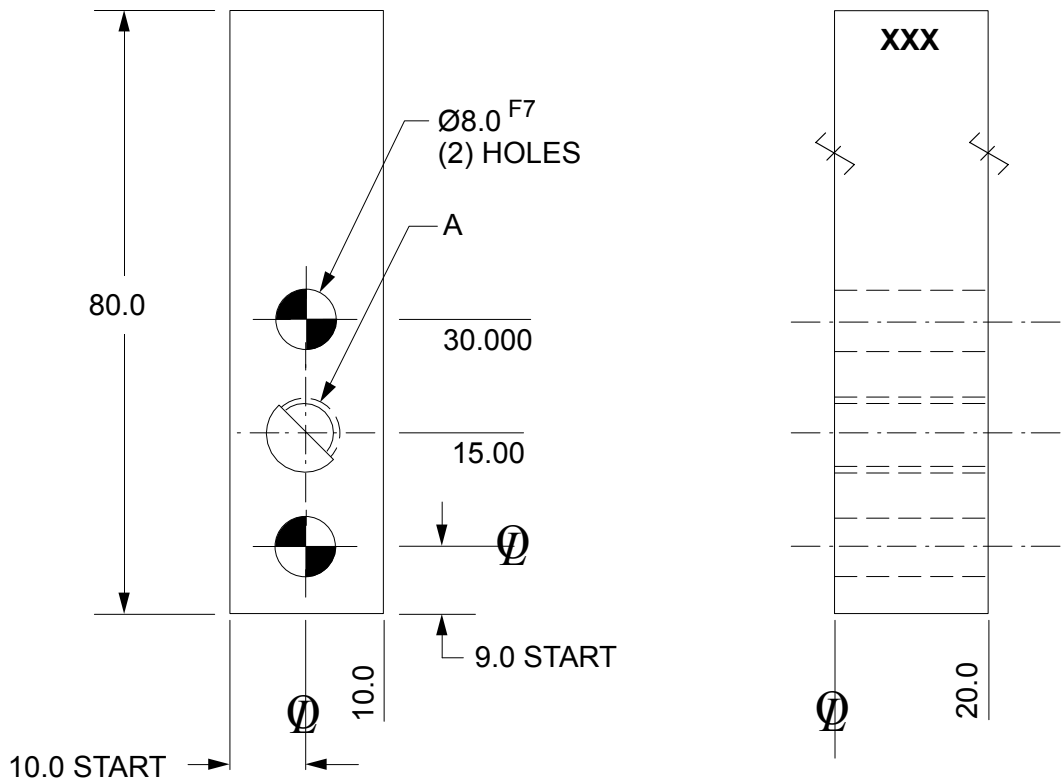

SEE PAGE B-1.1 FOR GLOBAL MATERIALS CHART

NAAMS CODE	A	MATERIAL	WT. kg
ANI206	M8 x 1.25	STEEL SAE 4140	0.25
ANI207	M8 x 1.25	SS type 303 or 304	0.25
ANI208	$\text{Ø} 9.0$	STEEL SAE 4140	0.25
ANI209	$\text{Ø} 9.0$	SS type 303 or 304	0.25

NC BLOCK BLANKS 20 mm SERIES ANI201 THRU ANI204

Tolerances: 1 PLACE ± 0.3
2 PLACE ± 0.03
3 PLACE ± 0.020

✓ SURFACES TO BE FLAT, PARALLEL &
PERPENDICULAR TO WITHIN 0.015 T.I.R.

NOTE: Identify with NAAMS CODE number as shown **XXX**.
Black Oxide Finish
No Black Oxide Finish to "SS Type" Components

A

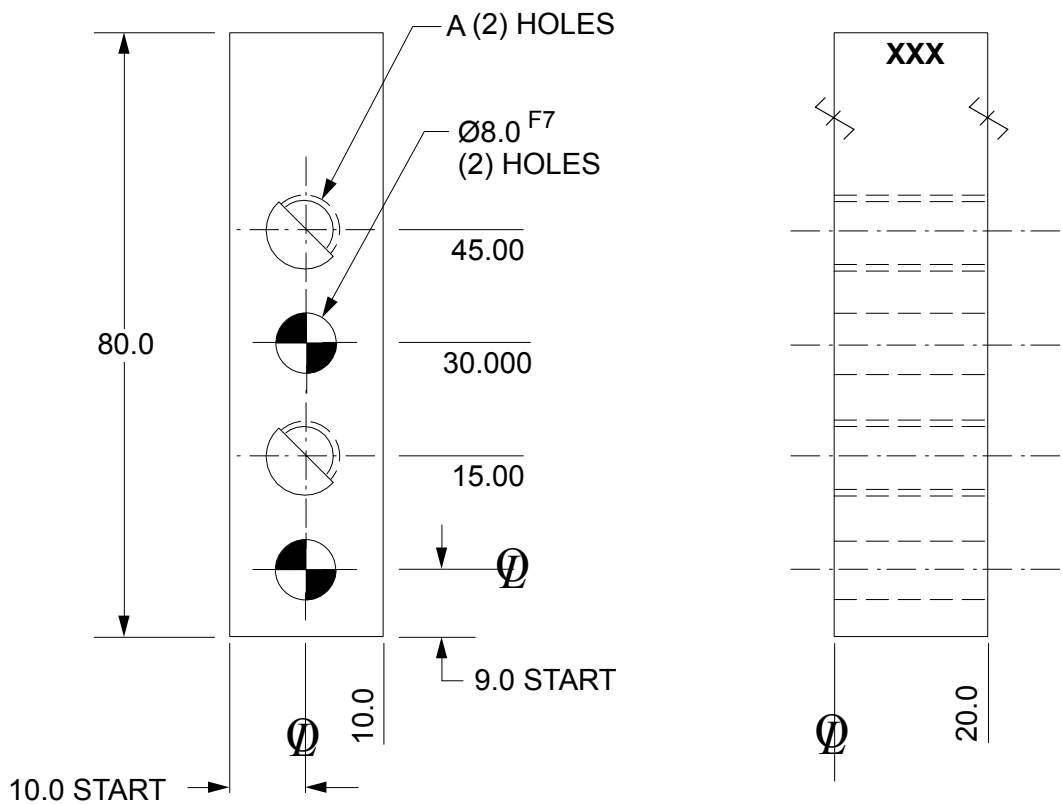

SEE PAGE B-1.1 FOR GLOBAL MATERIALS CHART

NAAMS CODE	A	MATERIAL	WT. kg
ANI201	M8 x 1.25	STEEL SAE 4140	0.25
ANI202	M8 x 1.25	SS type 303 or 304	0.25
ANI203	$\varnothing 9.0$	STEEL SAE 4140	0.25
ANI204	$\varnothing 9.0$	SS type 303 or 304	0.25

NC BLOCK BLANKS

20 mm SERIES

ANI216 THRU ANI219

GLOBAL STANDARD COMPONENTS



Assembly

02/12/14

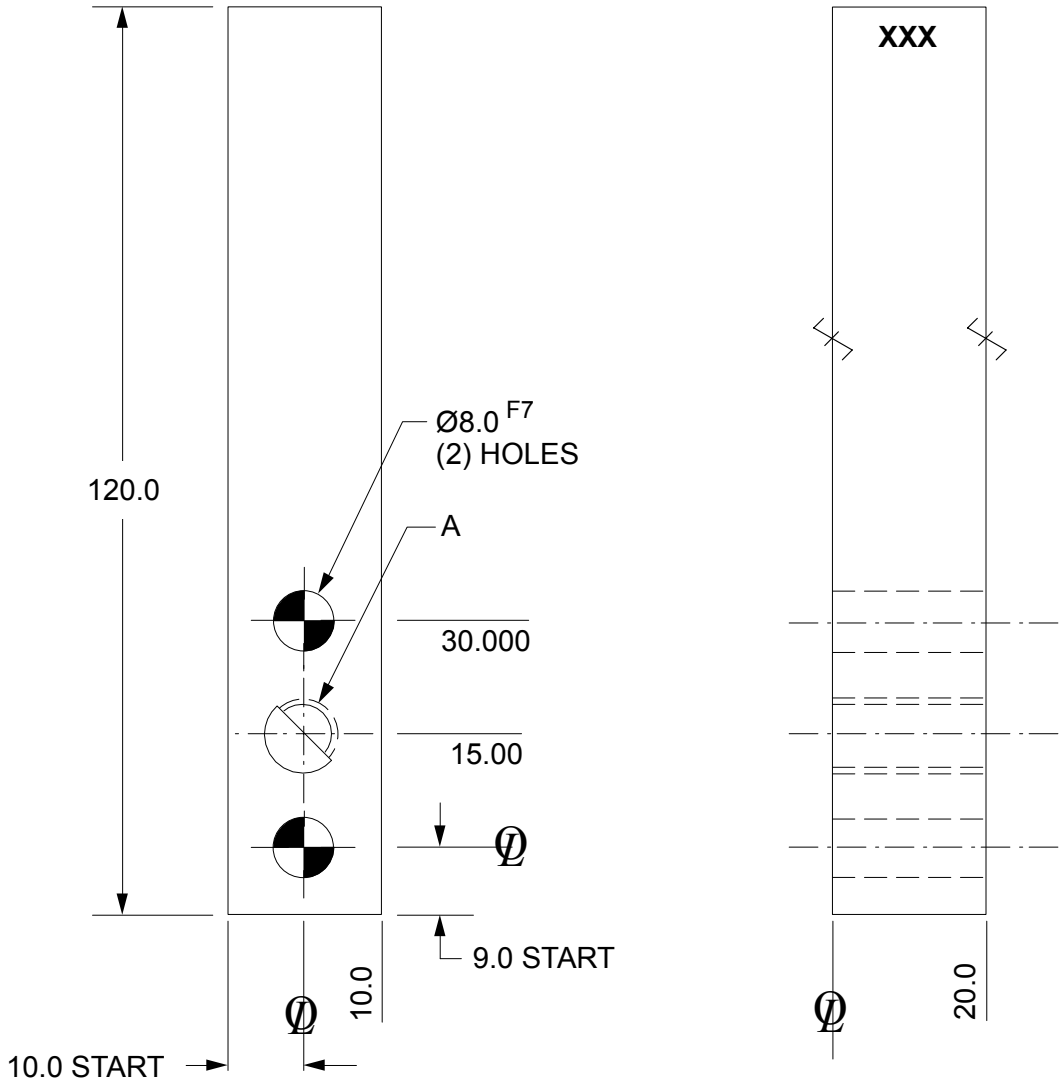

SEE PAGE B-1.1 FOR GLOBAL MATERIALS CHART

NAAMS CODE	A	MATERIAL	WT. kg
ANI216	M8 x 1.25	STEEL SAE 4140	0.37
ANI217	M8 x 1.25	SS type 303 or 304	0.37
ANI218	Ø 9.0	STEEL SAE 4140	0.37
ANI219	Ø 9.0	SS type 303 or 304	0.37

Tolerances: 1 PLACE ± 0.3
2 PLACE ± 0.03
3 PLACE ± 0.020

✓ SURFACES TO BE FLAT, PARALLEL & PERPENDICULAR TO WITHIN 0.015 T.I.R.
NOTE: Identify with NAAMS CODE number as shown **XXX**.
Black Oxide Finish

No Black Oxide Finish to "SS Type" Components

A

NC BLOCK BLANKS 20 mm SERIES ANI211 THRU ANI214

Tolerances: 1 PLACE ± 0.3
2 PLACE ± 0.03
3 PLACE ± 0.020

✓ SURFACES TO BE FLAT, PARALLEL &
PERPENDICULAR TO WITHIN 0.015 T.I.R.

NOTE: Identify with NAAMS CODE number as shown **XXX**.
Black Oxide Finish
No Black Oxide Finish to "SS Type" Components

A

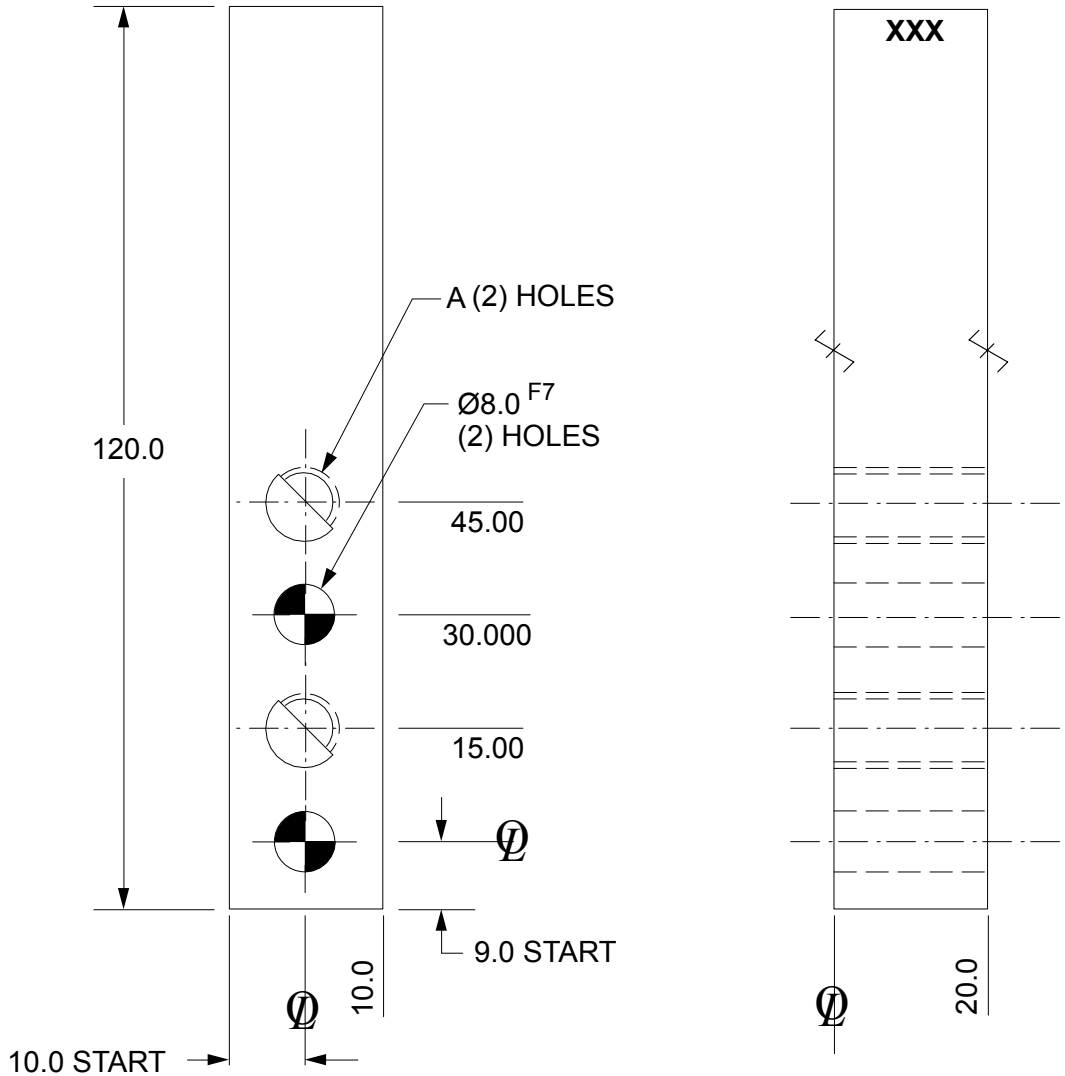

SEE PAGE B-1.1 FOR GLOBAL MATERIALS CHART

NAAMS CODE	A	MATERIAL	WT. kg
ANI211	M8 x 1.25	STEEL SAE 4140	0.41
ANI212	M8 x 1.25	SS type 303 or 304	0.41
ANI213	Ø9.0	STEEL SAE 4140	0.41
ANI214	Ø9.0	SS type 303 or 304	0.41