

# SAFETY PIN COMPONENTS

<b>PAGE</b>	<b>DATE</b>	<b>NAAMS CODE</b>	<b>DESCRIPTION</b>
<a href="#">AA-1</a>	04/20/12		Safety Pin Components Index
<a href="#">AA-2</a>	04/20/12	ASC0010	Safety Pin Tap Pad
<a href="#">AA-3</a>	04/20/12	ASC0011	Safety Pin Mounting Bracket
<a href="#">AA-4</a>	04/20/12	ASC0100, 0150, 0200, 0250, 0300	Safety Pin

# SAFETY PIN TAP PAD ASC0010

- EXCEPT AS NOTED TOLERANCES SHALL BE:
- 1 PLACE MACHINING  $\pm 0.3$
  - 1 PLACE FABRICATION  $\pm 1.5$
  - 2 PLACE  $\pm 0.08$  BETWEEN MACHINED SURFACES  
 $\pm 0.13$  TO SCREW HOLES, NON ACCUMULATIVE

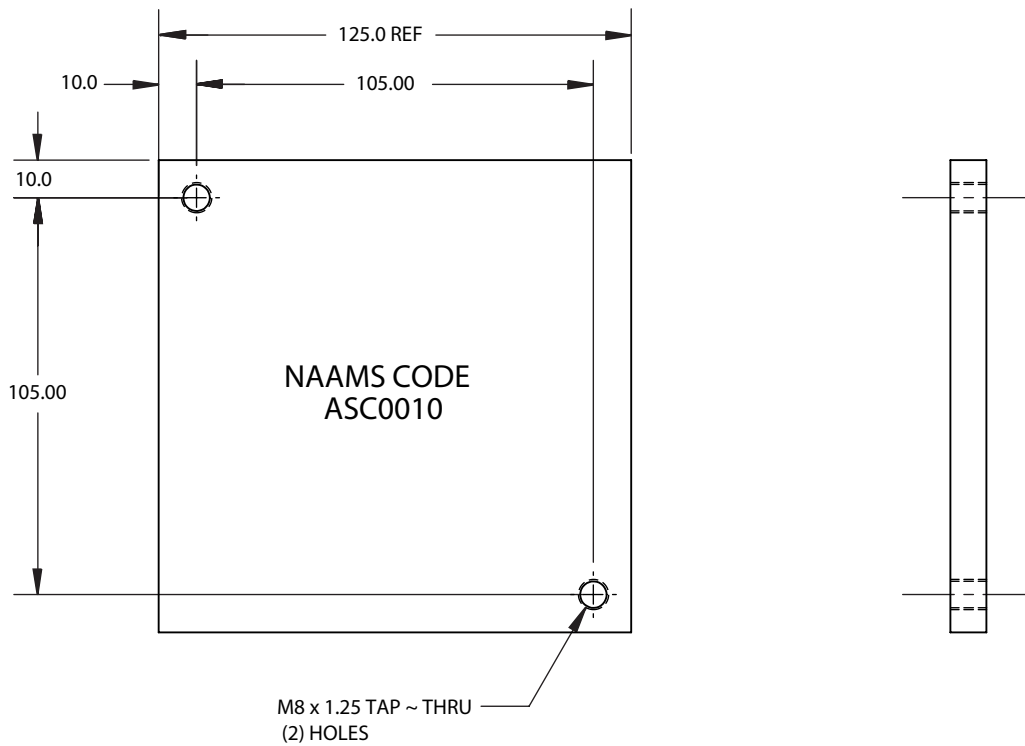

1-REQ'D - SAE 1020 - 3/8" x 5" x 125.0 mm

# SAFETY PIN MOUNTING BRACKET - ASC0011



EXCEPT AS NOTED TOLERANCES SHALL BE:

- 1 PLACE MACHINING  $\pm 0.3$
- 1 PLACE FABRICATION  $\pm 1.5$
- 2 PLACE  $\pm 0.08$  BETWEEN MACHINED SURFACES  
 $\pm 0.13$  TO SCREW HOLES, NON ACCUMULATIVE

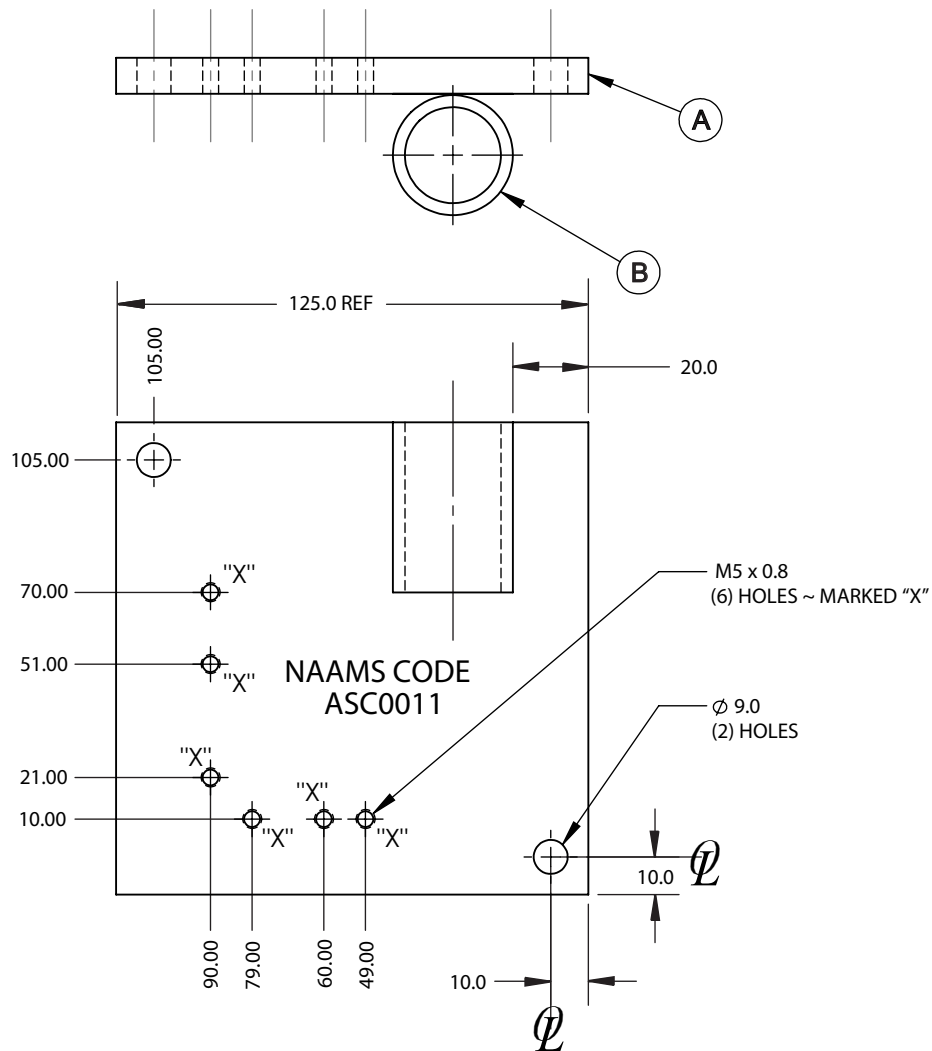

WELDED CONSTRUCTION - PAINT SAFETY YELLOW

- (A) 1-REQ'D - 3/8" x 5" x 125.0mm - SAE 1018
- (B) 1-REQ'D - 1-1/4" OD x 1" ID x 45.0 mm - ASTM A 513 TYPE 5 DOM TUBING

THIS DETAIL MAY ALTERNATIVELY BE MANUFACTURED FROM CAST PLASTIC, WITH THREADED INSERTS.

# SAFETY PIN

ASC0100, ASC0150, ASC0200 <sup>TM</sup>  
ASC0250, ASC0300

GLOBAL STANDARD COMPONENTS

# NAAMS



Assembly

04/20/12

EXCEPT AS NOTED TOLERANCES SHALL BE:

- 1 PLACE MACHINING  $\pm 0.3$
- 1 PLACE FABRICATION  $\pm 1.5$
- 2 PLACE  $\pm 0.08$  BETWEEN MACHINED SURFACES  
 $\pm 0.13$  TO SCREW HOLES, NON ACCUMULATIVE

NAAMS CODE	"Y"	"Z"
ASC0100	100	145.0
ASC0150	150	195.0
ASC0200	200	245.0
ASC0250	250	295.0
ASC0300	300	345.0

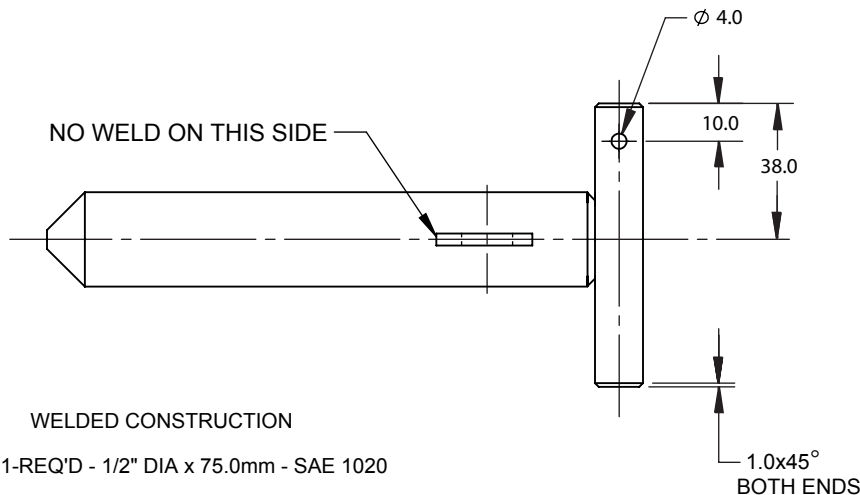
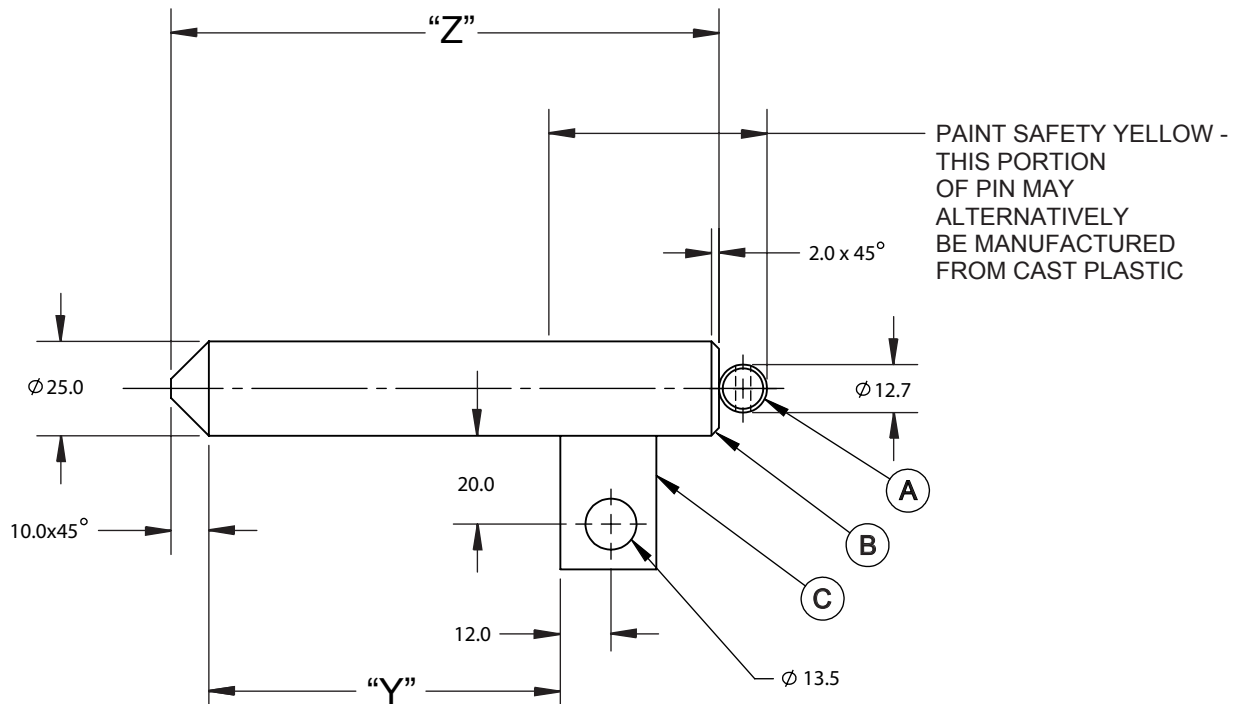

WELDED CONSTRUCTION

- (A) 1-REQ'D - 1/2" DIA x 75.0mm - SAE 1020
- (B) 1-REQ'D - 1" DIA x "Z" - SAE 4140
- (C) 1-REQ'D - 1/8" x 1" x 32.0mm - SAE 1020

12,000 lbf (5443 kgf) STATIC SINGLE SHEAR STRENGTH  
(INCLUDING A 3:1 SAFETY FACTOR)