

Set Collars with sensor adaptor  
25070.0018



Product Description

Clamping rings are provided with a fastening possibility for sensors, switches etc. Universal applicability, e.g. as a limit switch on a piston rod.  
Clamping ring made of stainless steel with strong clamping force.

Material

Screw

- Stainless steel

Set collar

- Stainless steel 1.4021

Drawing

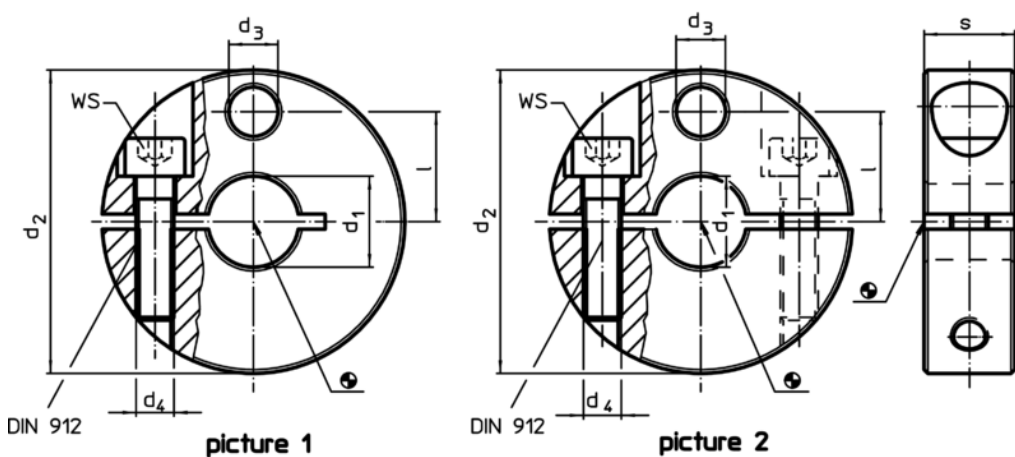

Order information

Dimensions						WS		Art. No.
d <sub>1</sub>	d <sub>2</sub>	d <sub>3</sub>	d <sub>4</sub>	l	s	WS		
[mm]						[mm]	[g]	
H8	-0,5							
<b>slotted – picture 1</b>								
18	50	9	M6	18,5	13	5	151	25070.0018

Application example

