

High Knurled Thumb Screws• DIN 464

24790.0300

Product Description

All knurled screws are one-piece manufactured. Contrary to the Official Standard Sheet, they all have a thread up to the head, but no recess at the thread end.

Material

- Stainless steel 1.4305, dull blasted

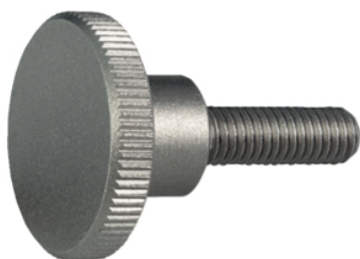

Drawing

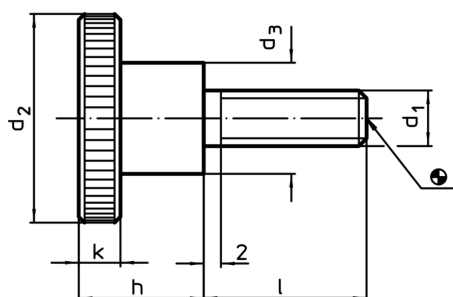

Order information

Dimensions						[g]	Art. No.
d ₁	l	d ₂	d ₃	h	k		
Stainless steel							
M4	20	16	8	9,5	3,5	9,1	24790.0300

Application example

