

## High Knurled Thumb Screws• DIN 464

24790.0160

### Product Description

All knurled screws are one-piece manufactured. Contrary to the Official Standard Sheet, they all have a thread up to the head, but no recess at the thread end.

### Material

- Steel, blackened, quality 5.8



### Drawing

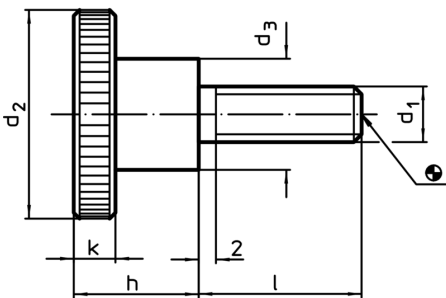

### Order information

| Dimensions |     |       |       |     |     |     | Art. No.   |
|------------|-----|-------|-------|-----|-----|-----|------------|
| $d_1$      | $l$ | $d_2$ | $d_3$ | $h$ | $k$ | [g] |            |
| Steel      |     |       |       |     |     |     |            |
| M8         | 30  | 30    | 16    | 18  | 6   | 60  | 24790.0160 |

### Application example

