

High Knurled Thumb Screws• DIN 464

24790.0142

Product Description

All knurled screws are one-piece manufactured. Contrary to the Official Standard Sheet, they all have a thread up to the head, but no recess at the thread end.

Material

- Steel, blackened, quality 5.8



Drawing

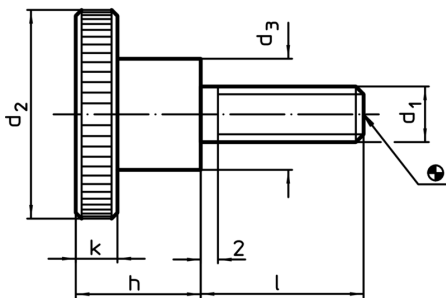

Order information

Dimensions							Art. No.
d_1	l	d_2	d_3	h	k	[g]	
Steel							
M6	30	24	12	15	5	31	24790.0142

Application example

