

High Knurled Thumb Screws• DIN 464

24790.0119

Product Description

All knurled screws are one-piece manufactured. Contrary to the Official Standard Sheet, they all have a thread up to the head, but no recess at the thread end.

Material

- Steel, blackened, quality 5.8



Drawing

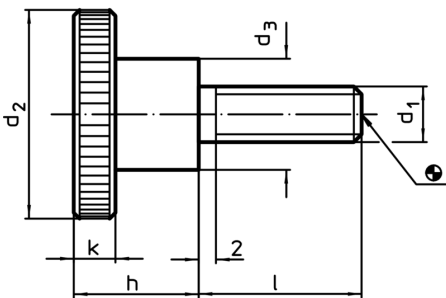

Order information

| Dimensions | | | | | | [g] | Art. No. |
|----------------|----|----------------|----------------|------|---|-----|------------|
| d ₁ | l | d ₂ | d ₃ | h | k | | |
| Steel | | | | | | | |
| M5 | 20 | 20 | 10 | 11,5 | 4 | 16 | 24790.0119 |

Application example

