

High Knurled Thumb Screws• DIN 464

24790.0114

Product Description

All knurled screws are one-piece manufactured. Contrary to the Official Standard Sheet, they all have a thread up to the head, but no recess at the thread end.

Material

- Steel, blackened, quality 5.8



Drawing

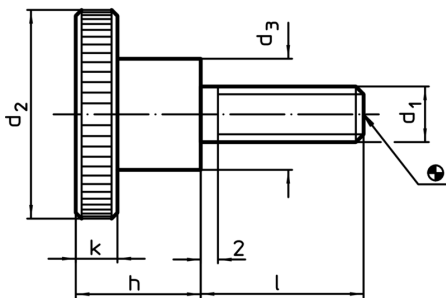

Order information

Dimensions						[g]	Art. No.
d ₁	l	d ₂	d ₃	h	k		
Steel							
M5	10	20	10	11,5	4	15	24790.0114

Application example

