

High Knurled Thumb Screws· DIN 464

24790.0096

Product Description

All knurled screws are one-piece manufactured. Contrary to the Official Standard Sheet, they all have a thread up to the head, but no recess at the thread end.

Material

- Steel, blackened, quality 5.8



Drawing

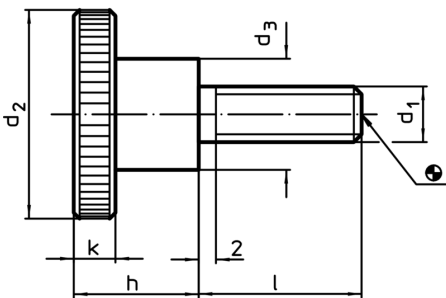

Order information

Dimensions						[g]	Art. No.
d ₁	l	d ₂	d ₃	h	k		
Steel							
M4	12	16	8	9,5	3,5	8,3	24790.0096

Application example

