

Crank Handles• DIN 469 straight, with square end DIN 79
24330.0031



Product Description

With these crank handles, the seam is ground and blasted. The hub is machined.

Material

Machine handle

- Steel, turned, zinc-plated by galvanization, passivated

Handle body

- Nodular cast iron, plastic coated, black

Drawing

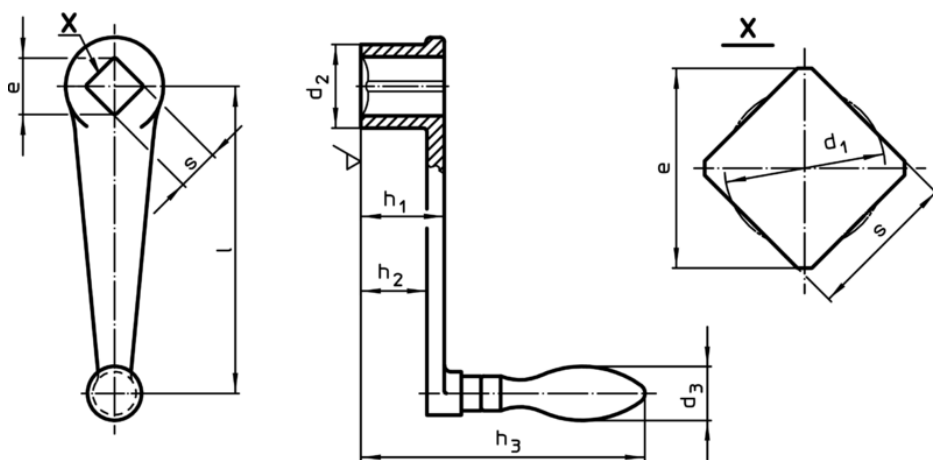

Order information

l	s H11	e min.	Dimensions					d ₃ Machine handle Ø	[g]	Art. No.
			d ₁	d ₂	h ₁	h ₂	h ₃			
			[mm]					[mm]		
with rotating machine handle EH 24460., DIN 98										
100	14	18,1	14,7	28	28	21	100	20	280	24330.0031