

Fulcrum Pins

23400.0125



Product Description

Material

Fulcrum Pins

- Stainless steel 1.4021, heat-treated

Safety ring

- Stainless steel 1.4310

More information

References

Suitable for eccentric levers EH 23390. and similar applications.

Drawing

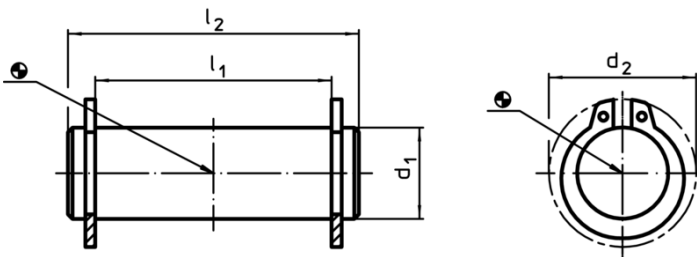

Order information

Dimensions				[g]	Art. No.
d_1	l_1	d_2	l_2		
f8	-0,5				
[mm]					
12	31	19	37	34	23400.0125

Application example

