

Fulcrum Pins

23400.0102



Product Description

Material

Fulcrum Pins

- Stainless steel 1.4021, heat-treated

Safety ring

- Stainless steel 1.4310

More information

References

Suitable for eccentric levers EH 23390. and similar applications.

Drawing

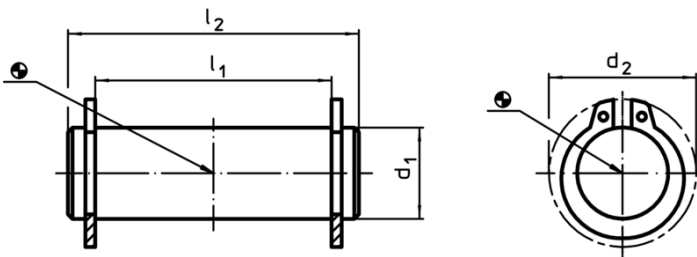

Order information

Dimensions				Art. No.
d_1	l_1	d_2	l_2	
f8	-0,5			
[mm]				
10	18	17	24	
				[g]
				14
				23400.0102

Application example

