

Fulcrum Pins

23400.0082



Product Description

Material

Fulcrum Pins

- Stainless steel 1.4021, heat-treated

Safety ring

- Stainless steel 1.4310

More information

References

Suitable for eccentric levers EH 23390. and similar applications.

Drawing

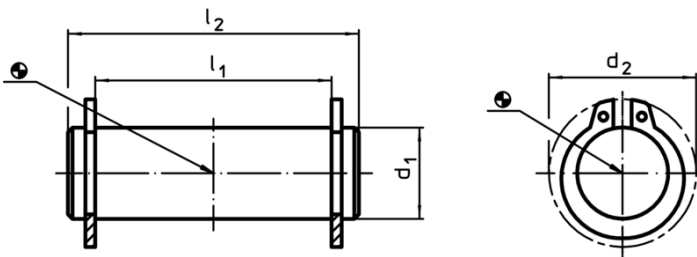

Order information

| Dimensions | | Art. No. |
|------------|-------|------------|
| d_1 | l_1 | |
| f8 | -0,5 | |
| [mm] | | [g] |
| 8 | 14 | 7,7 |
| | | 23400.0082 |

Application example

