

Eccentric Quick Clamps with female thread

23390.0102

Product Description

For quick and easy clamping and releasing of workpieces.
When using the "adjustable" design (picture 2) the lever position can be moved.



Material

Support washer

- Thermoplastic POM, glass-fiber reinforced

Lever

- Zinc die-cast, plastic coated, black

Threaded part

- Steel, zinc-plated by galvanization

Inner parts

- Steel, zinc-plated by galvanization

Adjusting nut

- Steel, zinc-plated by galvanization

Drawing

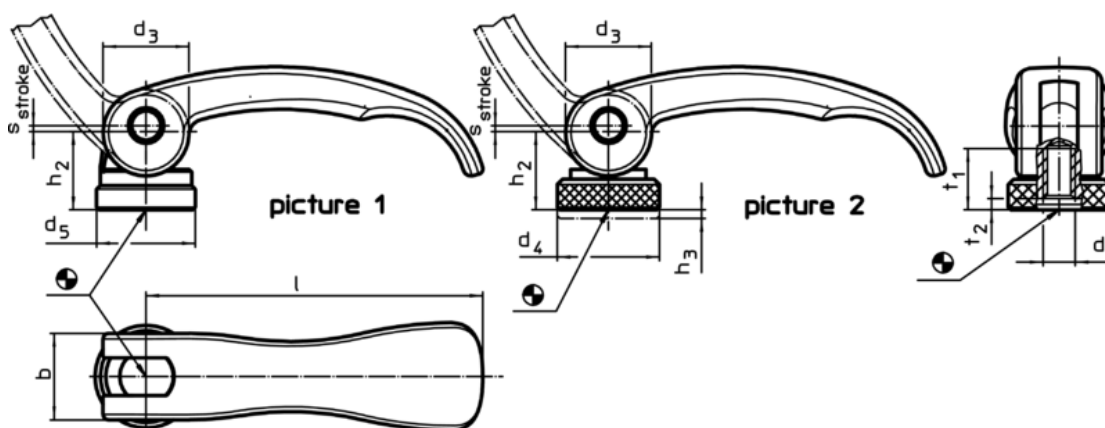

Order information

Dimensions										Stroke s at 90° lever position	🌡️ max.	🏋️ [g]	Art. No.
l	d ₁	d ₃	d ₄	h ₂ max.	Regulating- range h ₃ min.	b	t ₁	t ₂ min. in clamping position	Stroke s at 90° lever position				
[mm]										[mm]	[°C]	[g]	
with female thread, adjustable – picture 2, Steel													
82	M8	20	25	19,5	2,5	20	15	3,7	1	80	130	23390.0102	

Application example

