

## Eccentric Quick Clamps with female thread

23390.0001

### Product Description

For quick and easy clamping and releasing of workpieces.  
When using the "adjustable" design (picture 2) the lever position can be moved.



### Material

#### Support washer

- Thermoplastic PA, glass-fiber reinforced

#### Lever

- Zinc die-cast, plastic coated, black

#### Threaded part

- Steel, zinc-plated by galvanization

#### Inner parts

- Steel, zinc-plated by galvanization

#### Adjusting nut

- Steel, zinc-plated by galvanization

### Drawing

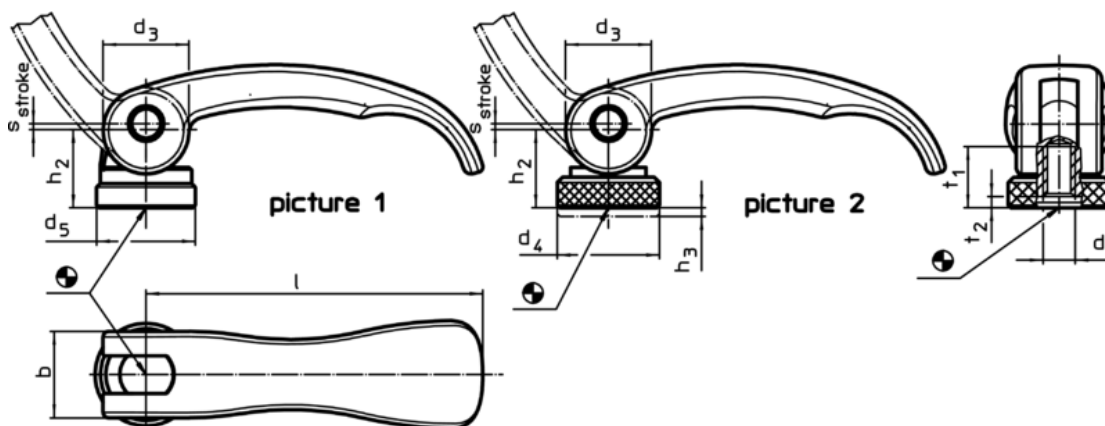

### Order information

Dimensions								Stroke s at 90° lever position	🌡️ max.	📦 [g]	Art. No.
l	d <sub>1</sub>	d <sub>3</sub>	d <sub>5</sub>	h <sub>2</sub> max.	b	t <sub>1</sub>	t <sub>2</sub> min. in clamping position				
[mm]								[mm]	[°C]	[g]	
with female thread – picture 1, Steel											
63	M6	16	18,5	16,4	16	13	3	0,75	80	58	23390.0001

Application example

