

Push Plungers• with pin, protected against rotating

23230.0554

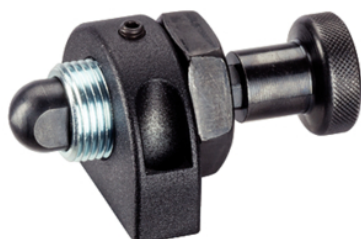

Product Description

The push plunger is suitable for easy and safe positioning of workpieces or components prior to clamping or assembly.

Locating pins of your own profile or design can be attached to our threaded pin types.

Material

Pin

- Steel, case-hardened, blackened

Body

- Steel, zinc-plated by galvanization

Threaded Pin

- Steel, blackened, with brass pad

Mounting block

- Zinc die-cast, plastic coated, black

Knob

- Steel, blackened



Lock nut

- Steel, blackened

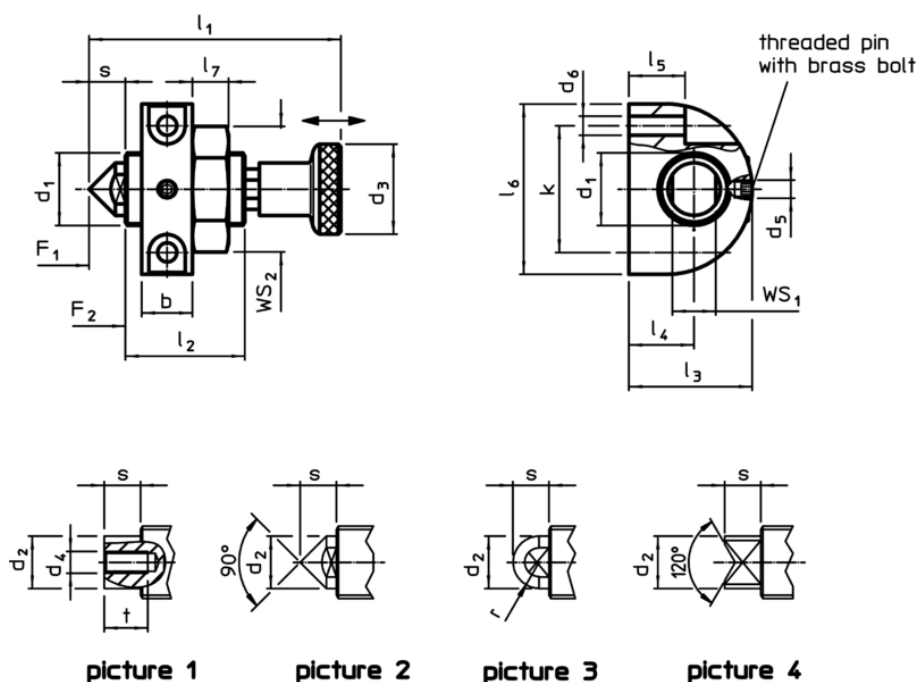
Drawing



Order information

Dimensions															Stroke	WS		Spring load ¹⁾				Art. No.
d ₁	d ₂	d ₃	d ₅	d ₆	l ₁	l ₂	l ₃	l ₄	l ₅	l ₆	l ₇	r	b	k	s	WS ₁	WS ₂	F ₁	F ₂	max.		
[mm]															[mm]	[mm]		[N]		[°C]	[g]	
with rounded pin – picture 3																						
M20 x 1,5	14,5	25	M5	5,3	69,5	33	34	18	15,5	47	10	7,2	14	35	10	12	30	40	130	100	210	23230.0554

¹⁾ statistical average value

Application example

