

Fixture Nuts• DIN 6330 (height 1,5 d)

23070.0022



Product Description

The spherical face matches DIN 6319 conical seats (EH 23050.).
This combination enables compensating for uneven surfaces.

Material

- Heat-treated steel, tempered, quality 10, phosphated

More information

References

For torques and strengths please refer to
appendix - Technical Data -

Drawing

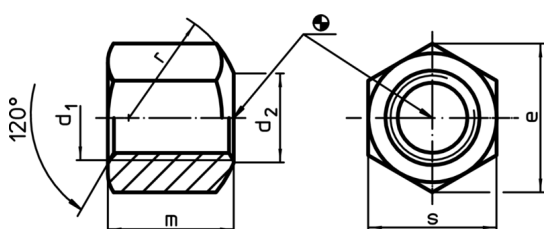

Order information

Dimensions							Art. No. ¹⁾
d ₁	d ₂	e	m	r	s		
[mm]							
with lateral spherical bearing surface, form B, Heat-treated steel							
M22	24	39,3	33	29	34	162	23070.0022

¹⁾ DIN standards do not include these dimensions.

Application example

