

Fixture Nuts• DIN 6330 (height 1,5 d)
23070.0020



Product Description

The spherical face matches DIN 6319 conical seats (EH 23050.). This combination enables compensating for uneven surfaces.

Material

- Heat-treated steel, tempered, quality 10, phosphated

More information

References

For torques and strengths please refer to appendix - Technical Data -

Drawing

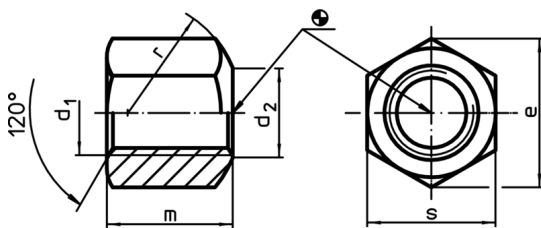

Order information

Dimensions						[g]	Art. No.
d ₁	d ₂	e [mm]	m	r	s		
with lateral spherical bearing surface, form B, Heat-treated steel							
M20	22	34,6	30	27	30	110	23070.0020

Application example

