

Fixture Nuts• DIN 6330 (height 1,5 d)
23070.0018



Product Description

The spherical face matches DIN 6319 conical seats (EH 23050).
This combination enables compensating for uneven surfaces.

Material

- Heat-treated steel, tempered, quality 10, phosphated

More information

References

For torques and strengths please refer to appendix - Technical Data -

Drawing

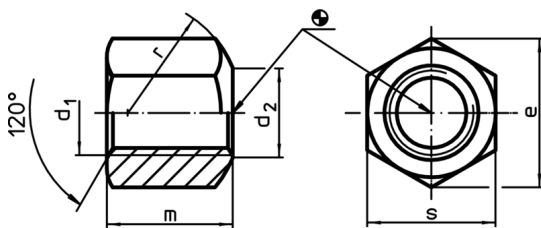

Order information

Dimensions						[g]	Art. No. ¹⁾
d ₁	d ₂	e	m	r	s		
with lateral spherical bearing surface, form B, Heat-treated steel							
M18	20	31,2	27	24,5	27	82	23070.0018

¹⁾ DIN standards do not include these dimensions.

Application example

