

Fixture Nuts • DIN 6330 (height 1,5 d)
23070.0012



Product Description

The spherical face matches DIN 6319 conical seats (EH 23050). This combination enables compensating for uneven surfaces.

Material

- Heat-treated steel, tempered, quality 10, phosphated

More information

References

For torques and strengths please refer to appendix - Technical Data -

Drawing

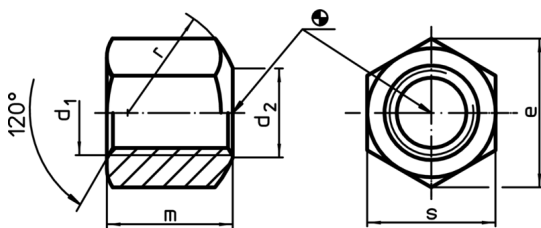

Order information

Dimensions						[g]	Art. No.
d ₁	d ₂	e [mm]	m	r	s		
with lateral spherical bearing surface, form B, Heat-treated steel							
M12	14	20,8	18	17	18	24	23070.0012

Application example

