

Fixture Nuts• DIN 6330 (height 1,5 d)

23070.0010



Product Description

The spherical face matches DIN 6319 conical seats (EH 23050). This combination enables compensating for uneven surfaces.

Material

- Heat-treated steel, tempered, quality 10, phosphated

More information

References

For torques and strengths please refer to appendix - Technical Data -

Drawing

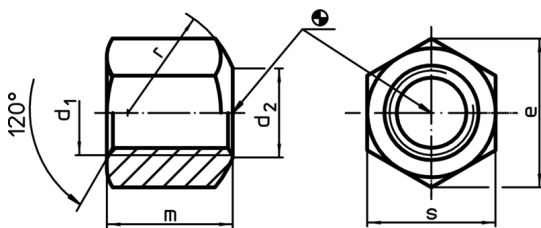

Order information

d ₁	d ₂	Dimensions				s	[g]	Art. No.
		e	m	r	[mm]			
with lateral spherical bearing surface, form B, Heat-treated steel								
M10	11,5	18,5	15	15	16	17	23070.0010	

Application example

