

Washers • high precision design  
23060.0117



Product Description

The precisely manufactured washers have an allowance in parallelism of 0,05 mm.

Material

- Heat-treated steel, tempered, blackened

Drawing

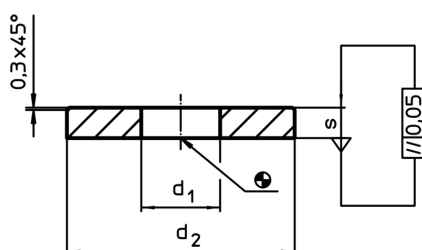

Order information

d <sub>1</sub>	Dimensions		s	For screw [mm]	[g]	Art. No.
	d <sub>2</sub> [mm]					
Heat-treated steel						
17	45		5	M16	53	23060.0117

Application example

