

Washers• high precision design
23060.0113



Product Description

The precisely manufactured washers have an allowance in parallelism of 0,05 mm.

Material

- Heat-treated steel, tempered, blackened

Drawing

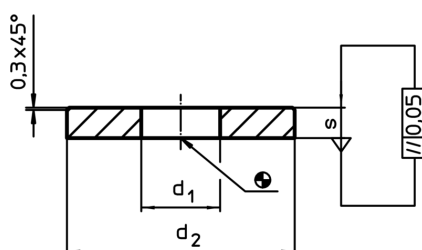

Order information

d ₁	Dimensions		s	For screw [mm]	[g]	Art. No.
	d ₂ [mm]					
Heat-treated steel						
13	36		5	M12	34	23060.0113

Application example

