

## Washers • high precision design

23060.0110



### Product Description

The precisely manufactured washers have an allowance in parallelism of 0,05 mm.

### Material

- Heat-treated steel, tempered, blackened

### Drawing

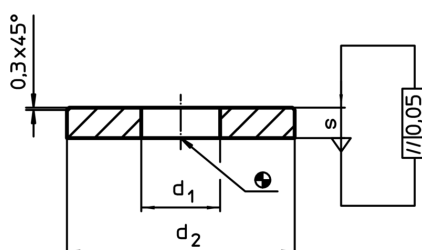

### Order information

| d <sub>1</sub>            | Dimensions |                |   | For screw | [g] | Art. No.   |
|---------------------------|------------|----------------|---|-----------|-----|------------|
|                           | [mm]       | d <sub>2</sub> | s |           |     |            |
| <b>Heat-treated steel</b> |            |                |   |           |     |            |
| 10,5                      |            | 30             | 4 | M10       | 19  | 23060.0110 |

### Application example

