

Washers • high precision design
23060.0108



Product Description

The precisely manufactured washers have an allowance in parallelism of 0,05 mm.

Material

- Heat-treated steel, tempered, blackened

Drawing

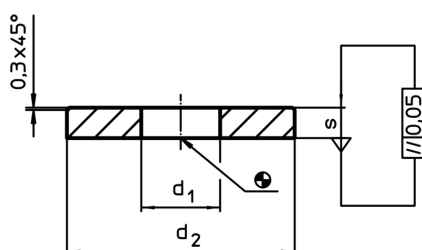

Order information

| d ₁ | Dimensions | | s | For screw [mm] | [g] | Art. No. |
|--------------------|------------------------|--|---|-------------------|-----|------------|
| | d ₂ [mm] | | | | | |
| Heat-treated steel | | | | | | |
| 8,4 | 24 | | 4 | M8 | 12 | 23060.0108 |

Application example

