

## Washers• high precision design

23060.0106



### Product Description

The precisely manufactured washers have an allowance in parallelism of 0,05 mm.

### Material

- Heat-treated steel, tempered, blackened

### Drawing

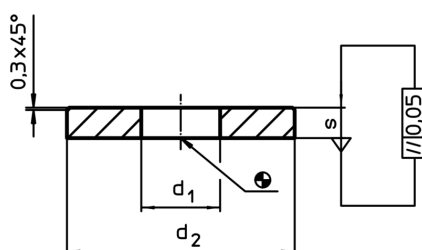

### Order information

d <sub>1</sub>	Dimensions		s	For screw	Weight	Art. No.
	d <sub>2</sub>	[mm]				
<b>Heat-treated steel</b>						
6,4	17		3	M6	4,5	23060.0106

### Application example

