

Shaft / Plain Washers • DIN 6340 heat-treated

23060.0036

Product Description



Material

- Heat-treated steel, tempered, punched, mechanically trued, phosphatized

Drawing

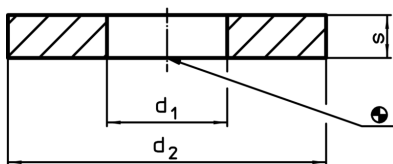

Order information

d ₁	Dimensions		s	For screws	[g]	Art. No. ¹⁾
	d ₂	[mm]		[mm]		
38	80		12	M36	360	23060.0036

¹⁾ DIN standards do not include these dimensions.

Application example

