

Shaft / Plain Washers • DIN 6340 heat-treated

23060.0022

Product Description



Material

- Heat-treated steel, tempered, punched, mechanically trued, phosphatized

Drawing

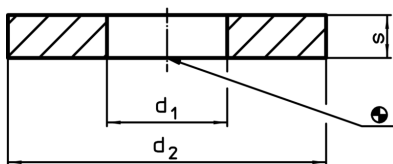

Order information

d ₁	Dimensions		s	For screws [mm]	[g]	Art. No. ¹⁾
	d ₂ [mm]					
23	50		8	M22	86	23060.0022

¹⁾ DIN standards do not include these dimensions.

Application example

