

Shaft / Plain Washers • DIN 6340 heat-treated

23060.0016

Product Description



Material

- Heat-treated steel, tempered, punched, mechanically trued, phosphatized

Drawing

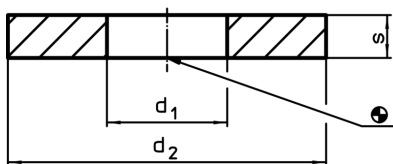

Order information

d ₁	Dimensions		s	For screws [mm]	[g]	Art. No.
	d ₂ [mm]					
17	45		6	M16	55	23060.0016

Application example

