

## Shaft / Plain Washers • DIN 6340 heat-treated

23060.0014

### Product Description



#### Material

- Heat-treated steel, tempered, punched, mechanically trued, phosphatized

### Drawing

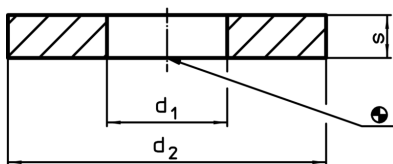

### Order information

d <sub>1</sub>	Dimensions		s	For screws [mm]	[g]	Art. No. <sup>1)</sup>
	d <sub>2</sub> [mm]					
15	40		5	M14	40	23060.0014

<sup>1)</sup> DIN standards do not include these dimensions.

### Application example

