

Thrust Screws with plastic pad

22760.0252

Product Description

Thrust screws can be used for a gentle clamping or pressing of thread spindles, axes, shafts and surface treated parts.

Material

Pad

- Thermoplastic POM, white

Screw

- Steel, blackened

More information

Further products

- Thrust Screws, with brass pad



Drawing

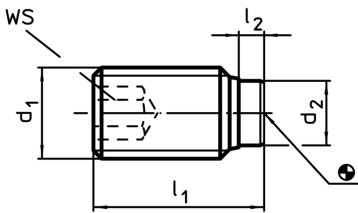

Order information

Dimensions				WS	min. max.			Art. No.
d ₁	l ₁	l ₂	d ₂	[mm]	[mm]	[°C]	[g]	
[mm]								
Steel								
M5	9	1	3	2,5	-30	80	0,7	22760.0252