

Self-Aligning Pads with hard metal ball, ribbed and self-resetting

22731.0394



Product Description

Especially designed for cast parts (hard casting crust). To be used as support, thrust pad and for build into clamping elements.

By resetting to the parallel position the contact point of the self-aligning pad provides a defined initial position, thus preventing the pad clamping in an oblique position when inserting the workpiece.

Material

Spring element

- Thermoplastic PUR

Ball

- Hard metal, ribbed, nickel-plated

Body

- Stainless steel 1.4057, heat-treated

Drawing

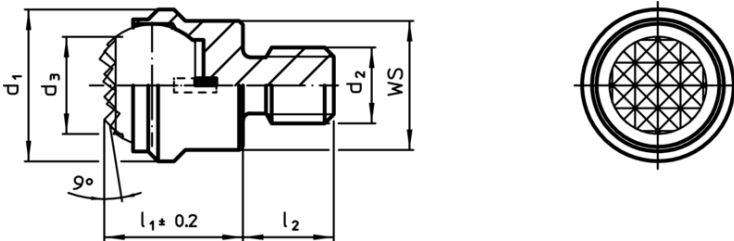

Order information

d ₁	d ₂	Dimensions			Ball	WS	Load capacity for static load max.	Tightening torque max.	Weight	Art. No.
		d ₃	l ₁ ±0,2	l ₂ -0,5						
with male thread, flat-faced ball, ribbed surface, Stainless steel										
20	M8	10,5	18	10	16	17	25	25	48	22731.0394

Application example

