

## Self-Aligning Pads with hard metal ball, ribbed and self-resetting

22731.0362



### Product Description

Especially designed for cast parts (hard casting crust). To be used as support, thrust pad and for build into clamping elements.

By resetting to the parallel position the contact point of the self-aligning pad provides a defined initial position, thus preventing the pad clamping in an oblique position when inserting the workpiece.

### Material

#### Spring element

- Thermoplastic PUR

#### Ball

- Hard metal, ribbed, nickel-plated

#### Body

- Heat-treated steel, tempered, phosphated

### Drawing

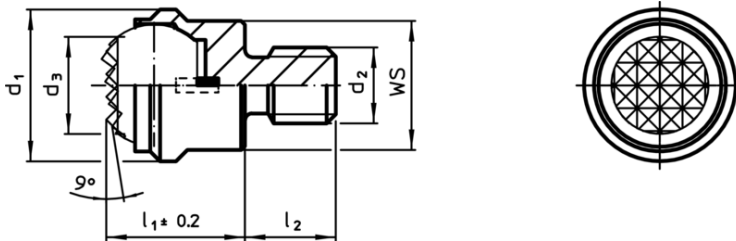

### Order information

d <sub>1</sub>	d <sub>2</sub>	Dimensions			Ball	WS	Load capacity for static load max.	Tightening torque max.	g	Art. No.
		d <sub>3</sub>	l <sub>1</sub> ±0,2	l <sub>2</sub> -0,5						
with male thread, flat-faced ball, ribbed surface, Heat-treated steel										
13	M6	8,3	13	8	10	11	10	10	14	22731.0362

Application example

