

## Self-Aligning Pads with hard metal ball, ribbed

22730.0382



### Product Description

Especially designed for cast parts (hard casting crust). To be used as support, thrust pad and for build into clamping elements.

### Material

#### Ball

- Hard metal, ribbed, nickel-plated

#### Body

- Heat-treated steel, tempered, phosphated

### More information

#### Notes

Ball protected against rotating.  
Loading capacity valid for steel and stainless steel designs.

### Drawing

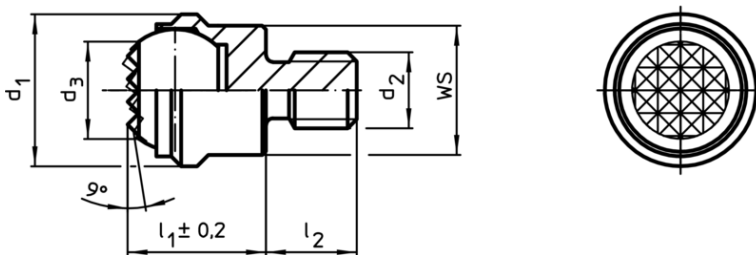

### Order information

d <sub>1</sub>	d <sub>2</sub>	Dimensions				Ball	WS	Load capacity for static load max.	Tightening torque max.	g	Art. No.
		d <sub>3</sub>	l <sub>1</sub> ±0,2	l <sub>2</sub> -0,5	[mm]						
with male thread, flat-faced ball, ribbed surface, Heat-treated steel											
50	M20	34,5	35	20	40	41	165	407	639	22730.0382	

### Application example

