

Ball-Ended Thrust Screws• headless, with fine-pitch thread

22720.6232



Product Description

Also for positioning, clamping, tightening or supporting of surfaces that are not exactly parallel. The fine-pitch thread allows a precise adjustment. Maximised load transmission due to moveable ball.

Material

Ball

- Stainless steel, hardened

Screw

- Stainless steel 1.4305

More information

Notes

Fully rotating ball.
Special types on request.

References

Thread lock on request, please refer to appendix - Technical Data -

Further products

- Ball-Ended Thrust Screws, headless, ball protected against rotating
- Ball-Ended Thrust Screws, headless, round ball
- Ball-Ended Thrust Screws, headless, flat-faced ball

Drawing

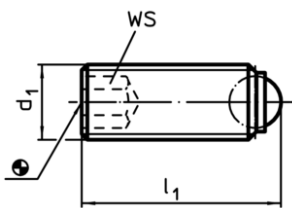

picture 1

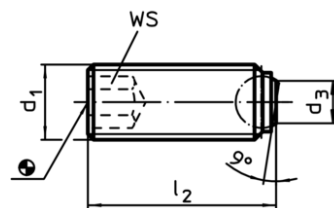

picture 2

Order information

Dimensions				WS	max.		Art. No.
d ₁	l ₂ [mm]	d ₃	Ball	[mm]	[°C]	[g]	
flat-faced ball, plain surface – picture 2, Stainless steel							
M4 x 0,35	9,6	1,3	2,5	2	250	0,8	22720.6232

Application example

