

Ball-Ended Thrust Screws• headless, with fine-pitch thread

22720.5242



Product Description

Also for positioning, clamping, tightening or supporting of surfaces that are not exactly parallel. The fine-pitch thread allows a precise adjustment. Maximised load transmission due to moveable ball.

Material

Ball

- Ball-bearing steel, hardened

Screw

- Heat-treated steel, 1200 ±100 N/mm²

More information

Notes

Fully rotating ball.
Special types on request.

References

Thread lock on request, please refer to appendix - Technical Data -

Further products

- Ball-Ended Thrust Screws, headless, ball protected against rotating
- Ball-Ended Thrust Screws, headless, round ball
- Ball-Ended Thrust Screws, headless, flat-faced ball

Drawing

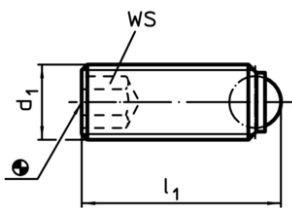

picture 1

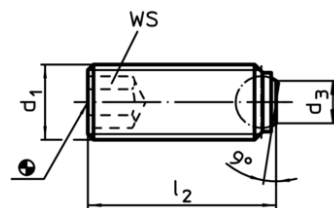

picture 2

Order information

d ₁	Dimensions			Ball	WS [mm]	Load capacity for static load ¹⁾ max. [kN]	max. [°C]	[g]	Art. No.
	l ₂ [mm]	d ₃							
flat-faced ball, plain surface – picture 2, Heat-treated steel									
M4 x 0,5	9,6	1,3	2,5	2	3,5	250	0,8	22720.5242	

¹⁾ Statements on load capacity are not valid for the stainless steel type.

Application example

