

## Ball-Ended Thrust Screws• headless, with fine-pitch thread

22720.5240



### Product Description

Also for positioning, clamping, tightening or supporting of surfaces that are not exactly parallel. The fine-pitch thread allows a precise adjustment. Maximised load transmission due to moveable ball.

### Material

#### Ball

- Ball-bearing steel, hardened

#### Screw

- Heat-treated steel,  $1200 \pm 100 \text{ N/mm}^2$

### More information

#### Notes

Fully rotating ball.  
Special types on request.

#### References

Thread lock on request, please refer to appendix - Technical Data -

#### Further products

- Ball-Ended Thrust Screws, headless, ball protected against rotating
- Ball-Ended Thrust Screws, headless, round ball
- Ball-Ended Thrust Screws, headless, flat-faced ball

### Drawing

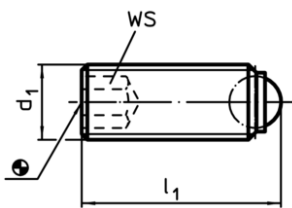

picture 1

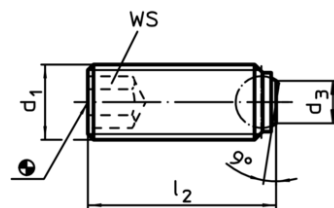

picture 2

### Order information

d <sub>1</sub>	Dimensions			Ball	WS [mm]	Load capacity for static load <sup>1)</sup> max. [kN]	max. [°C]	[g]	Art. No.
	l <sub>2</sub> [mm]	d <sub>3</sub>							
flat-faced ball, plain surface – picture 2, Heat-treated steel									
M4 x 0,5	5,6	1,3	2,5	2	3,5	250	0,4	22720.5240	

<sup>1)</sup> Statements on load capacity are not valid for the stainless steel type.

### Application example

