

Ball-Ended Thrust Screws• headless, with fine-pitch thread

22720.5040



Product Description

Also for positioning, clamping, tightening or supporting of surfaces that are not exactly parallel. The fine-pitch thread allows a precise adjustment. Maximised load transmission due to moveable ball.

Material

Ball

- Ball-bearing steel, hardened

Screw

- Heat-treated steel, 1200 ±100 N/mm²

More information

Notes

Fully rotating ball.
Special types on request.

References

Thread lock on request, please refer to appendix - Technical Data -

Further products

- Ball-Ended Thrust Screws, headless, ball protected against rotating
- Ball-Ended Thrust Screws, headless, round ball
- Ball-Ended Thrust Screws, headless, flat-faced ball

Drawing

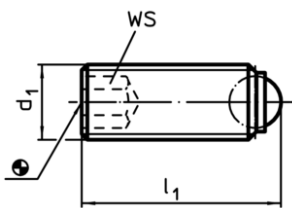

picture 1

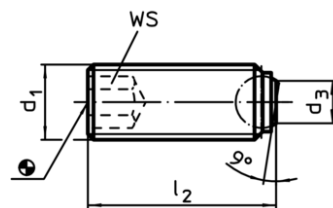

picture 2

Order information

Dimensions			WS	Load capacity for static load ¹⁾	max. [°C]	[g]	Art. No.
d ₁	l ₁	Ball					
[mm]			[mm]	max. [kN]			
round ball – picture 1, Heat-treated steel							
M4 x 0,5	6	2,5	2	3,5	250	0,4	22720.5040

¹⁾ Statements on load capacity are not valid for the stainless steel type.

Application example

