

Ball-Ended Thrust Screws• headed, ball protected against rotating

22700.0314

Product Description

For clamping and supporting of surfaces that are not exactly parallel.
Maximised load transmission due to moveable ball.



Material

Ball

- Stainless steel, hardened

Screw

- Stainless steel 1.4305

More information

Notes

Note: Thread runout l_4 !
Ball protected against rotating.
Special types on request.

References

Thread lock on request, please refer to
appendix - Technical Data -

Further products

- Ball-Ended Thrust Screws, headed, flat-faced ball

Drawing

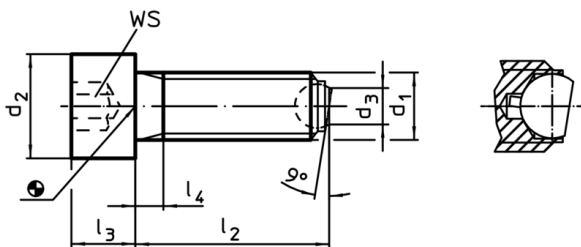

Order information

d_1	l_2	d_2	Dimensions			Ball	WS	Load capacity for static load ¹⁾ max.		Art. No.
			d_3	l_3	l_4		[mm]	[kN]	[g]	
			[mm]							
flat-faced ball, plain surface, Stainless steel										
M8	35	13	4,5	8	3,5	5,5	6	9	17	22700.0314

¹⁾ Statements on load capacity are not valid for the stainless steel type.

Application example

