

## Ball-Ended Thrust Screws• headed, ball protected against rotating

22700.0302

### Product Description

For clamping and supporting of surfaces that are not exactly parallel.  
Maximised load transmission due to moveable ball.



### Material

#### Ball

- Stainless steel, hardened

#### Screw

- Stainless steel 1.4305

### More information

#### Notes

Note: Thread runout  $l_4$  !  
Ball protected against rotating.  
Special types on request.

#### References

Thread lock on request, please refer to  
appendix - Technical Data -

#### Further products

- Ball-Ended Thrust Screws, headed, flat-faced ball

### Drawing

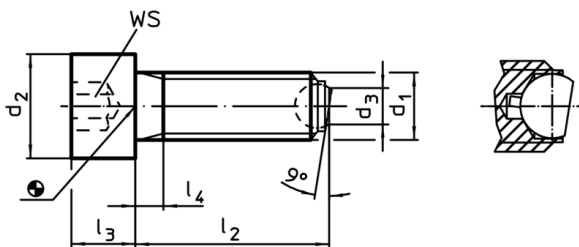

### Order information

Dimensions							WS	Load capacity for static load <sup>1)</sup> max.	[g]	Art. No.
d <sub>1</sub>	l <sub>2</sub>	d <sub>2</sub>	d <sub>3</sub>	l <sub>3</sub>	l <sub>4</sub>	Ball				
[mm]							[mm]	[kN]		
flat-faced ball, plain surface, Stainless steel										
M6	20	10	3,2	6	3	4	5	6	6,1	22700.0302

<sup>1)</sup> Statements on load capacity are not valid for the stainless steel type.

### Application example

