

## Ball-Ended Thrust Screws• headed, ball protected against rotating

22700.0284

### Product Description

For clamping and supporting of surfaces that are not exactly parallel.  
Maximised load transmission due to moveable ball.



### Material

#### Ball

- Ball-bearing steel, hardened

#### Screw

- Heat-treated steel,  $1200 \pm 100 \text{ N/mm}^2$

### More information

#### Notes

Note: Thread runout  $l_4$  !  
Ball protected against rotating.  
Special types on request.

#### References

Thread lock on request, please refer to  
appendix - Technical Data -

#### Further products

- Ball-Ended Thrust Screws, headed, flat-faced ball

### Drawing

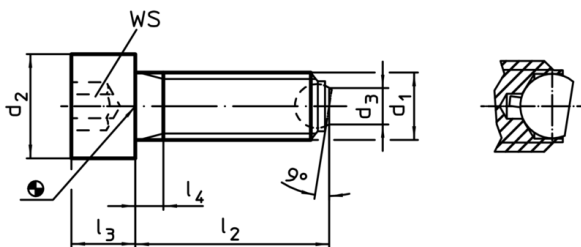

### Order information

$d_1$	$l_2$	$d_2$	Dimensions [mm]			Ball	WS [mm]	Load capacity for static load <sup>1)</sup> max. [kN]	[g]	Art. No.
M24	90	36	15,8	24	30	18	19	80	427	22700.0284

<sup>1)</sup> Statements on load capacity are not valid for the stainless steel type.

### Application example

