

## Ball-Ended Thrust Screws• headed, ball protected against rotating

22700.0182

### Product Description

For clamping and supporting of surfaces that are not exactly parallel.  
Maximised load transmission due to moveable ball.



### Material

#### Ball

- Ball-bearing steel, hardened

#### Screw

- Heat-treated steel,  $1200 \pm 100 \text{ N/mm}^2$

### More information

#### Notes

Note: Thread runout  $l_4$  !  
Ball protected against rotating.  
Special types on request.

#### References

Thread lock on request, please refer to  
appendix - Technical Data -

#### Further products

- Ball-Ended Thrust Screws, headed, flat-faced ball

### Drawing

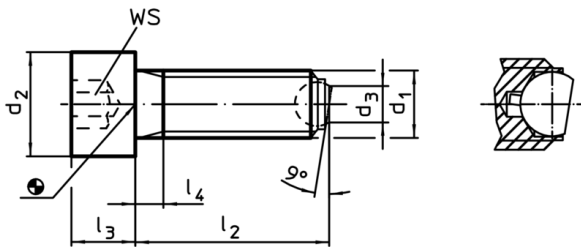

### Order information

| Dimensions   |       |       |       |       |       |      | WS   | Load capacity<br>for static load <sup>1)</sup><br>max. | [g] | Art. No.   |
|--|-------|-------|-------|-------|-------|------|------|--|-----|------------|
| $d_1$  | $l_2$ | $d_2$ | $d_3$ | $l_3$ | $l_4$ | Ball |      |  |     |            |
| [mm]   |       |       |       |       |       |      | [mm] | [kN]   |     |            |
| flat-faced ball, plain surface, Heat-treated steel |       |       |       |       |       |      |      |  |     |            |
| M24  | 60    | 36    | 15,8  | 24    | 9     | 18   | 19   | 80   | 325 | 22700.0182 |

<sup>1)</sup> Statements on load capacity are not valid for the stainless steel type.

### Application example

