

Ball-Ended Thrust Screws• headed, ball protected against rotating

22700.0102

Product Description

For clamping and supporting of surfaces that are not exactly parallel.
Maximised load transmission due to moveable ball.



Material

Ball

- Ball-bearing steel, hardened

Screw

- Heat-treated steel, $1200 \pm 100 \text{ N/mm}^2$

More information

Notes

Note: Thread runout l_4 !
Ball protected against rotating.
Special types on request.

References

Thread lock on request, please refer to
appendix - Technical Data -

Further products

- Ball-Ended Thrust Screws, headed, flat-faced ball

Drawing

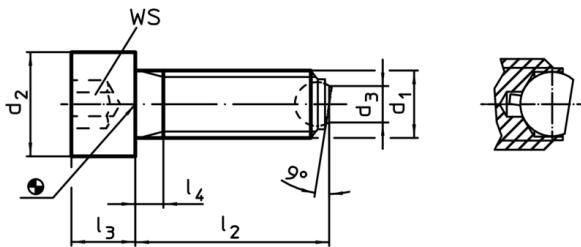

Order information

Dimensions							WS	Load capacity for static load ¹⁾ max.	g	Art. No.
d ₁	l ₂	d ₂	d ₃	l ₃	l ₄	Ball				
[mm]							[mm]	[kN]	[g]	
flat-faced ball, plain surface, Heat-treated steel										
M10	25	16	6	10	4,5	7	8	12	24	22700.0102

¹⁾ Statements on load capacity are not valid for the stainless steel type.

Application example

