

## Feet· DIN 6320 with threaded shank 22640.0122



### Product Description

Feet can be used both as a foot and as a seating element and stop.  
Load bearing surface without distortion.

### Material

- Heat-treated steel, unhardened, blackened

### Drawing

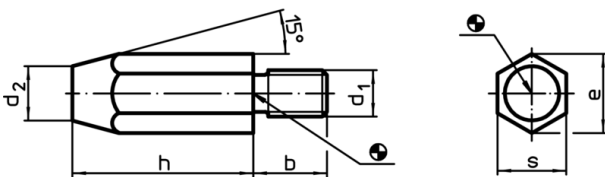

### Order information

h	d <sub>1</sub>	Dimensions				e	s	Tightening torque max. [Nm]	[g]	Art. No.
		b	d <sub>2</sub>	[mm]						
50	M12	20	15			21,9	19	60	129	22640.0122

### Application example

