

## Feet· DIN 6320 with threaded shank 22640.0061



### Product Description

Feet can be used both as a foot and as a seating element and stop.  
Load bearing surface without distortion.

### Material

- Heat-treated steel, unhardened, blackened

### Drawing

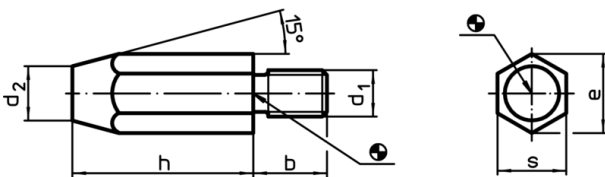

### Order information

| Dimensions |                |    |                        |      |    | Tightening torque<br>max.<br>[Nm] | <br>[g] | Art. No.   |
|------------|----------------|----|------------------------|------|----|-----------------------------------|---|------------|
| h          | d <sub>1</sub> | b  | d <sub>2</sub><br>[mm] | e    | s  |                                   |   |            |
| 10         | M6             | 11 | 8                      | 11,5 | 10 | 7                                 | 8   | 22640.0061 |

### Application example

