

Locating and Seating Pins• DIN 6321

22630.0042



Product Description

Cylindric locating pins for locating workpieces in toleranced holes and also to be used as stops and feet.
Flattened locating pin used to overcome differences in tolerances, between holes or to position an element in one direction only.

Material

- Tool steel, hardened, ground

Drawing

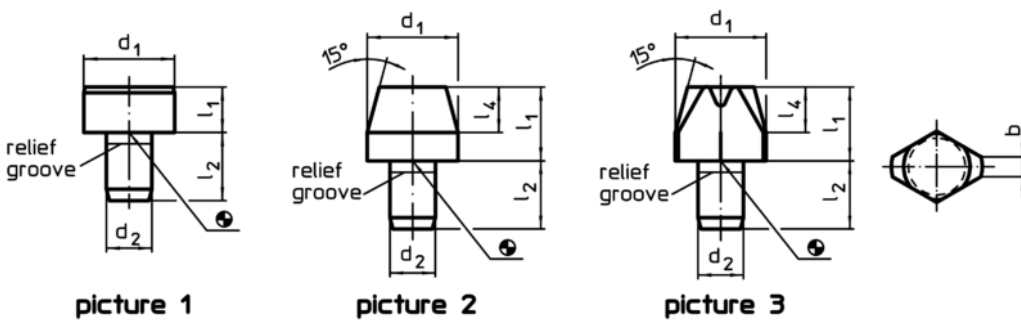

Order information

Dimensions						Location hole	Art. No.
d_1	l_1	b	d_2	l_2	l_4	H7	
[mm]						[mm]	[g]
g6			n6				
locating pin, flattened, DIN 6321, form C – picture 3							
8	10	1,6	6	9	6	6	4,5
							22630.0042

Application example

